

I CERTIFY THIS IS A TRUE AND CORRECT COPY OF THE ORIGINAL MINE MAP SHOWING COAL LAND UNDER LEASE TO:  
**GEORGE F. BUERGER**  
FALLOWFIELD TWP. - WASHINGTON COUNTY-PENNA.

*August R. Werft*  
REGISTERED PROFESSIONAL ENGINEER

DATE: *June 20, 1966* 12" LINE

**FINAL SURVEY APRIL 22, 1966**

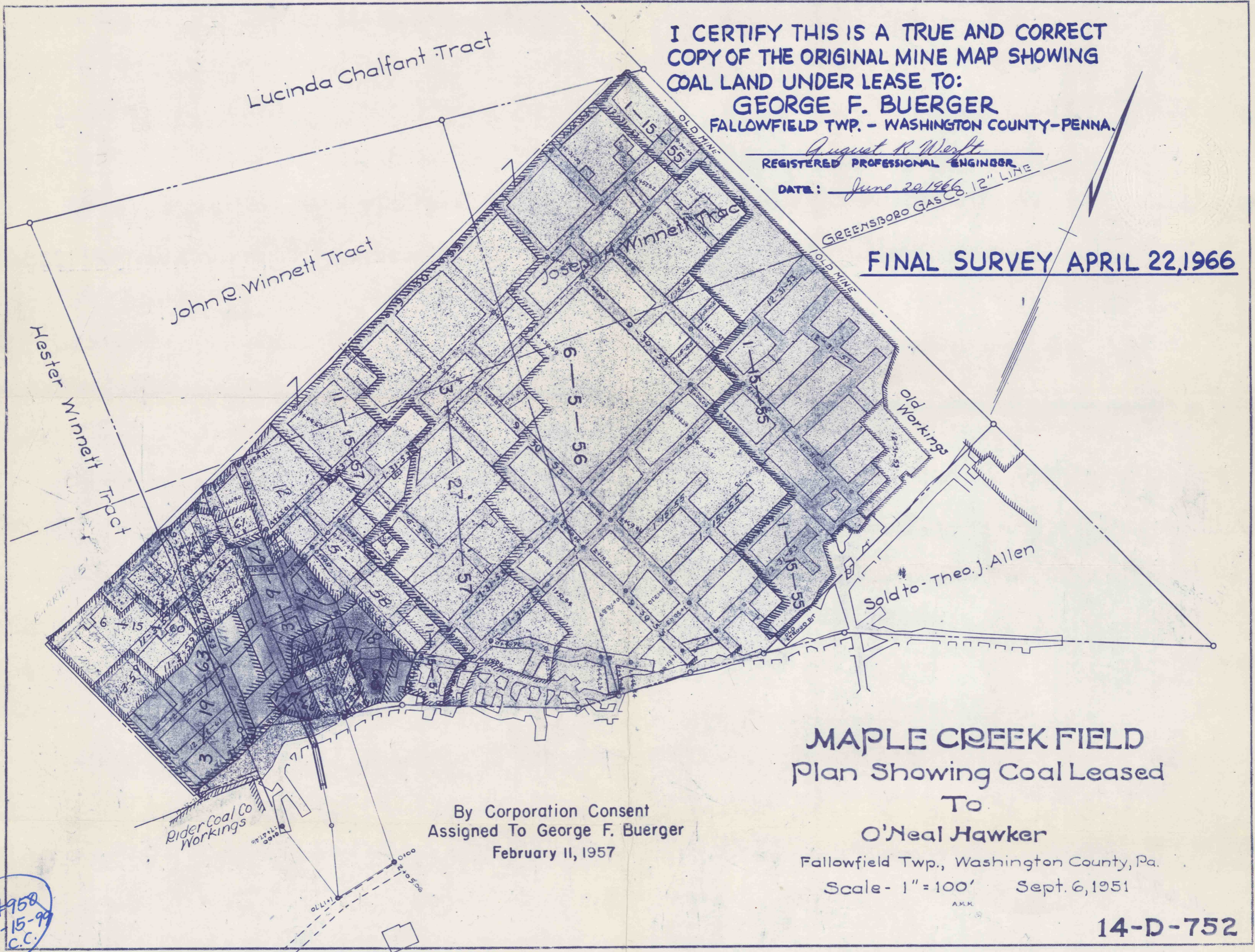

By Corporation Consent  
Assigned To George F. Buerger  
February 11, 1957

**MAPLE CREEK FIELD**  
Plan Showing Coal Leased  
To  
**O'Neal Hawker**

Fallowfield Twp., Washington County, Pa.  
Scale - 1" = 100' Sept. 6, 1951

A.M.K.

**14-D-752**

#950  
7-15-99  
C.C.