

DATE OF SURVEY.

AUG. 20, 1907	=	A.
DEC. 9, "	=	B.
" 28, 1908	=	C.
NOV. 24, 1909	=	D.
JULY 13, 1910	=	E.
NOV. 19, "	=	F.
MAY 20, 1911	=	G.
OCT. 6, 1912	=	H.
APR. 3, 1913	=	I.
JAN. 10, 1916	=	J.
AUG. 16, "	=	K.
JAN. 20, 1917	=	L.
OCT. 18, "	=	M.
NOV. 19, 1918	=	N.
APR. 26, 1919	=	O.
OCT. 25, "	=	P.

SURFACE AREA 8.136 ACRES =
 COAL AREA 53.288 ACRES =
 COAL MINED TO JAN. 1, 1920 40.103 ACRES
 COAL REMAINING 13.286 ACRES

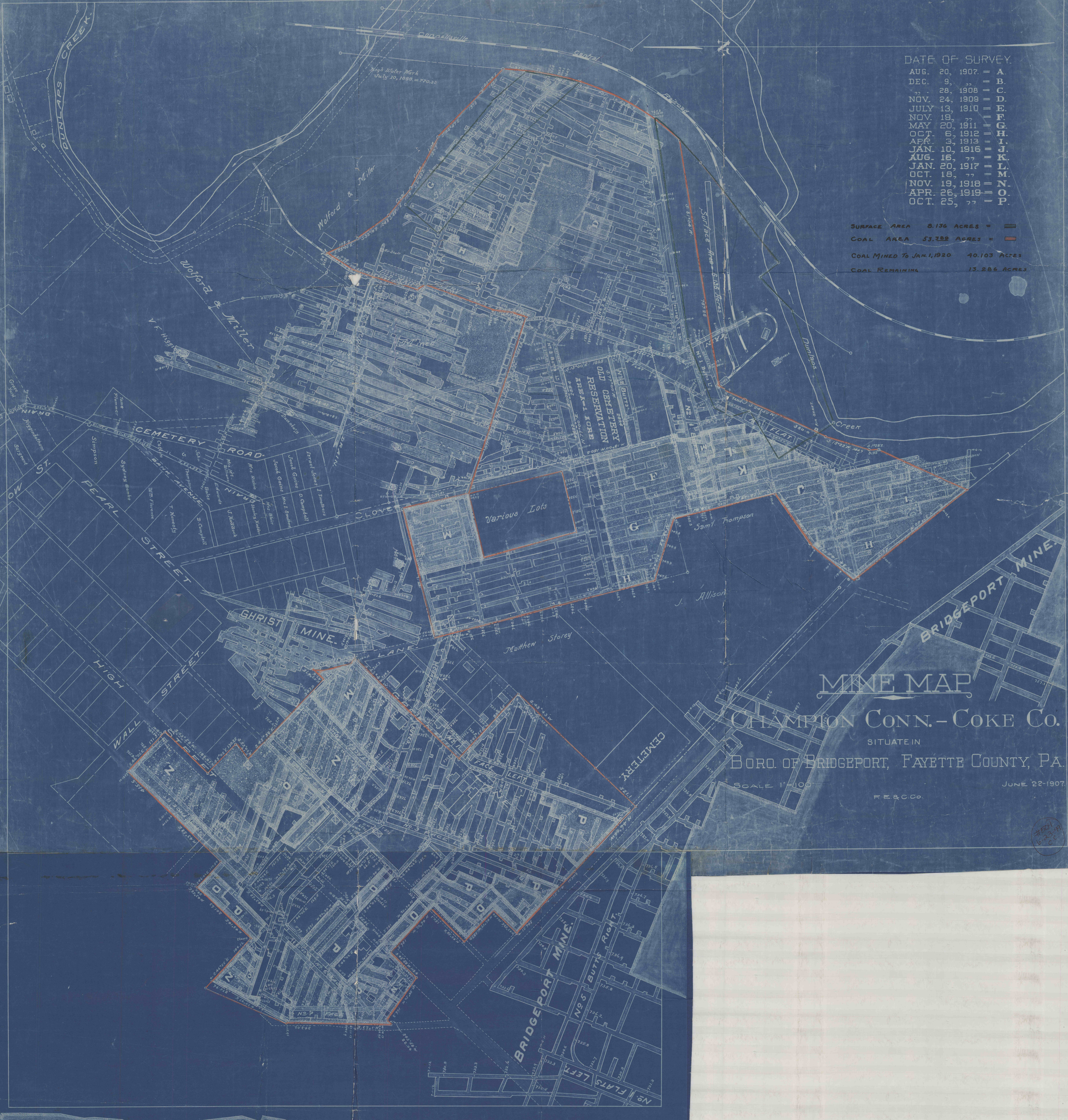

MINE MAP
 CHAMPION CONN.-COKE CO.
 SITUATE IN
 BORO. OF BRIDGEPORT, FAYETTE COUNTY, PA.
 SCALE 1"=100'
 FEB. 22, 1907.

#1001
 6-23-1911
 G.C.