

JEFF WRIGHT TRACK

D. BLOSE TRACK

SAM TREMBLE TRACK

J. WRIGHT TRACK

Jrs. WRIGHT TRACK

LEWIS SPICHER TRACK

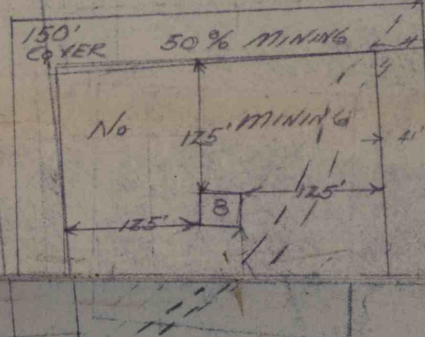
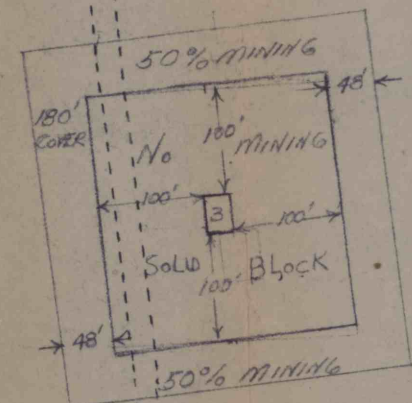

J. McMILLAN TRACK

FINAL MINING 7-10-67

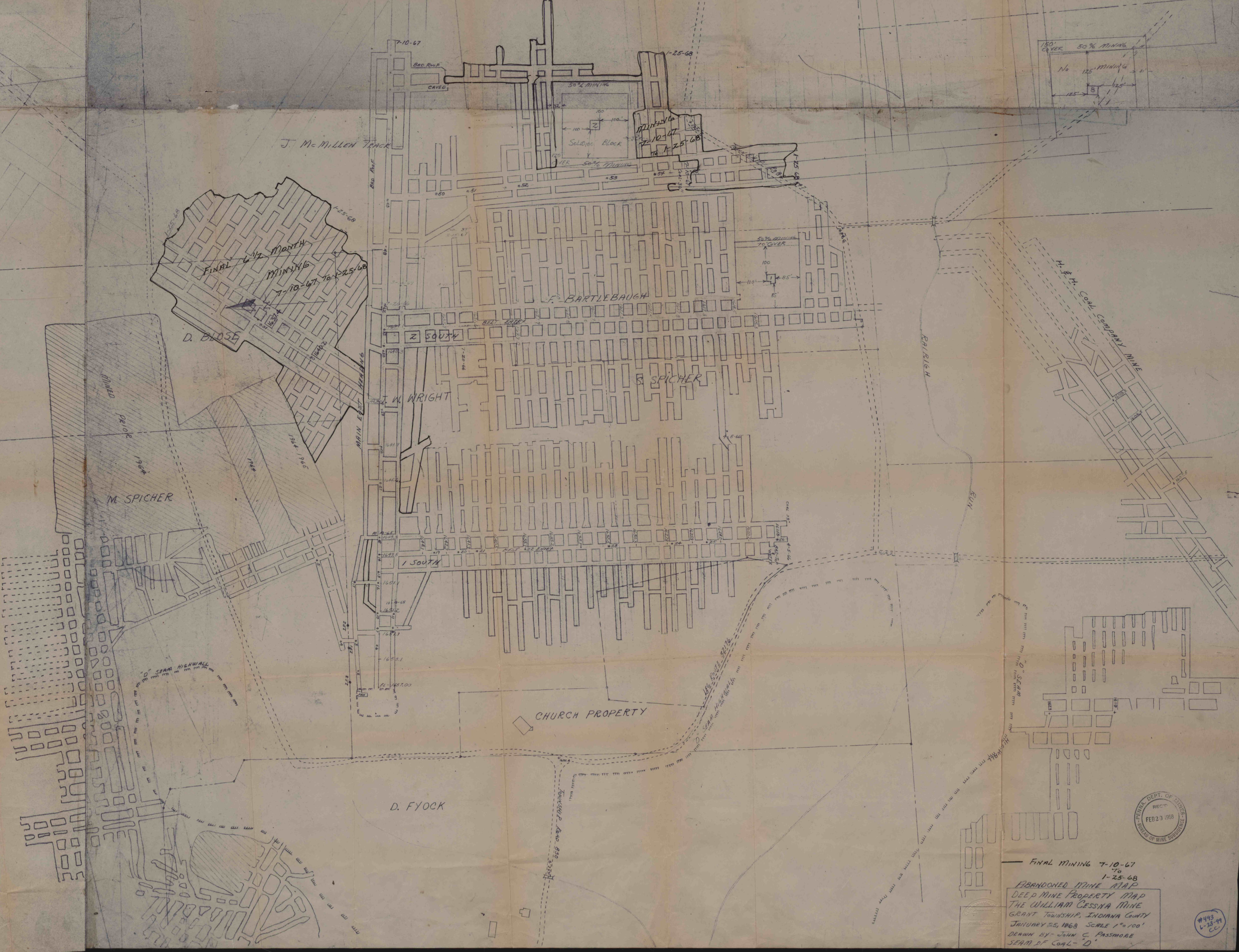

E. BARTLEBAUGH TRACK

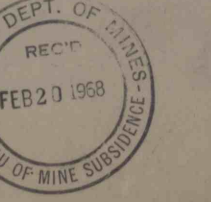

FINAL MINING 7-10-67  
 1-25-68  
 DEED MINE PROPERTY MAP  
 THE WILLIAM CESSNA MINE  
 GRANT TOWNSHIP, INDIANA COUNTY  
 JANUARY 20, 1868 SCALE 1"=100'  
 DRAWN BY JOHN C. PASTHORE  
 SURV. OF CAL. - 0

