

MATCH LINE SHEET 1 AND 2

NORTH

M.A. DOTERRER

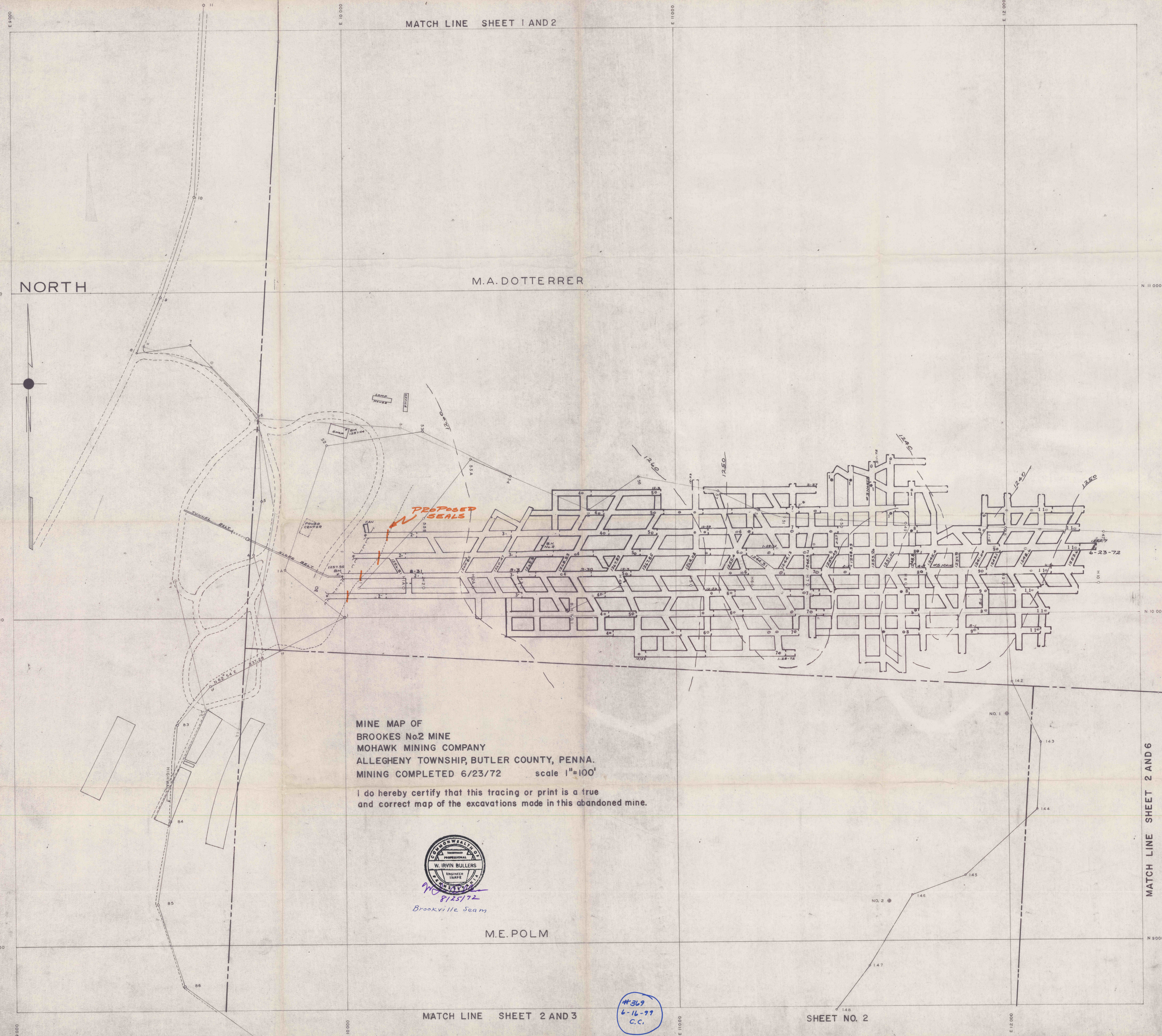

MINE MAP OF
 BROOKES No. 2 MINE
 MOHAWK MINING COMPANY
 ALLEGHENY TOWNSHIP, BUTLER COUNTY, PENNA.
 MINING COMPLETED 6/23/72 scale 1"=100'

I do hereby certify that this tracing or print is a true
 and correct map of the excavations made in this abandoned mine.

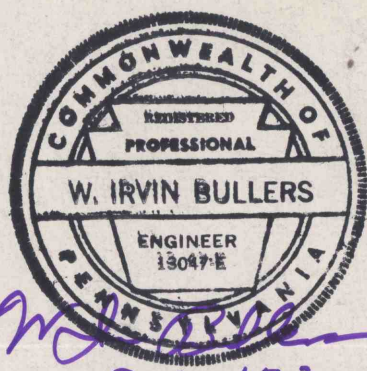

8/25/72
 Brookville Seam

M.E. POLM

MATCH LINE SHEET 2 AND 3

#369
 6-16-77
 C.C.

SHEET NO. 2

MATCH LINE SHEET 2 AND 6