

#277
6-11-67

TANDOM COAL COMPANY
BLACK BEAUTY NO. 1 MINE
YOUNG TWP., INDIANA CO., PA.
(PITTSBURGH SEAM)

SURVEYED OCT. 5, 1963 BY H. BASH
SCALE: 1" = 100'

REVISED 7-2-65
9-26-66
3-18-67
12-8-67
2-11-68
10-9-68
Graft Engineering Co.
Blairsville, Pa.

Coal Area
Workings - Next 6 Months
Mined Out
No Dwellings
Date October 9, 1963 to April 9, 1969

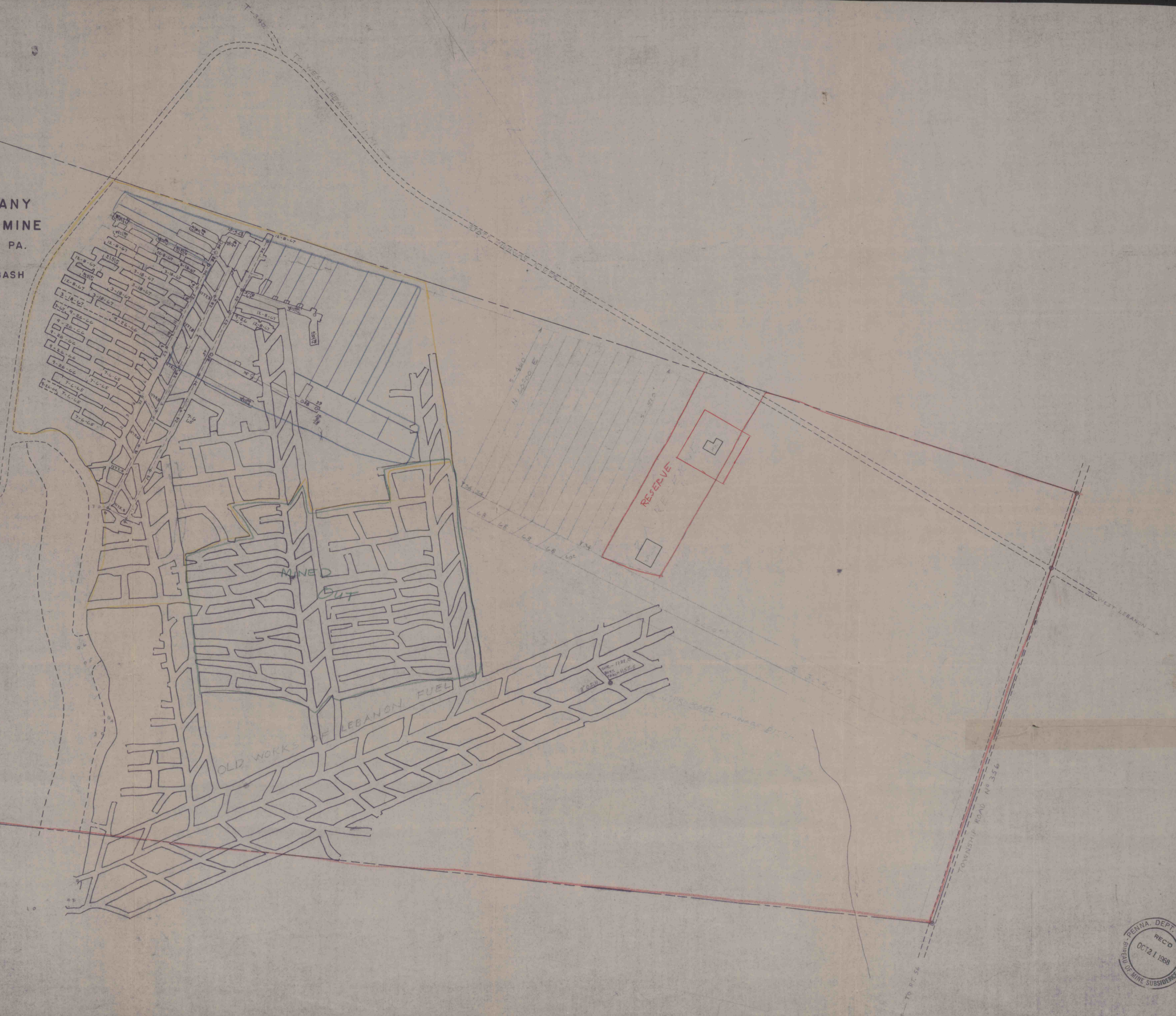

PENNA. DEPT. OF MINES
REC'D
OCT 21 1968
BUREAU OF MINE SUBSIDENCE