

BELFORD COAL COMPANY

9 CANNEL MINE

SCALE - 1 inch = 100 feet

Permit # 16-2

October 17, 1968

Revised for Subsidence

March 4, 1968

Contemplated Mining
12A.

April 18, 1968 to October 18, 1968

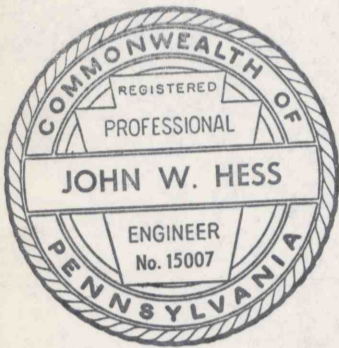

FIELD COPY

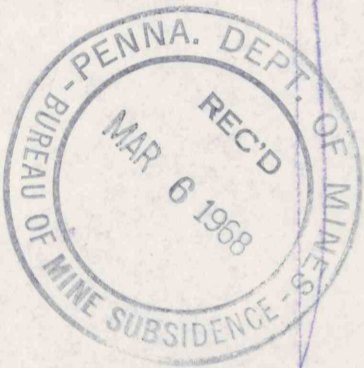

NORTH
1" = 100'

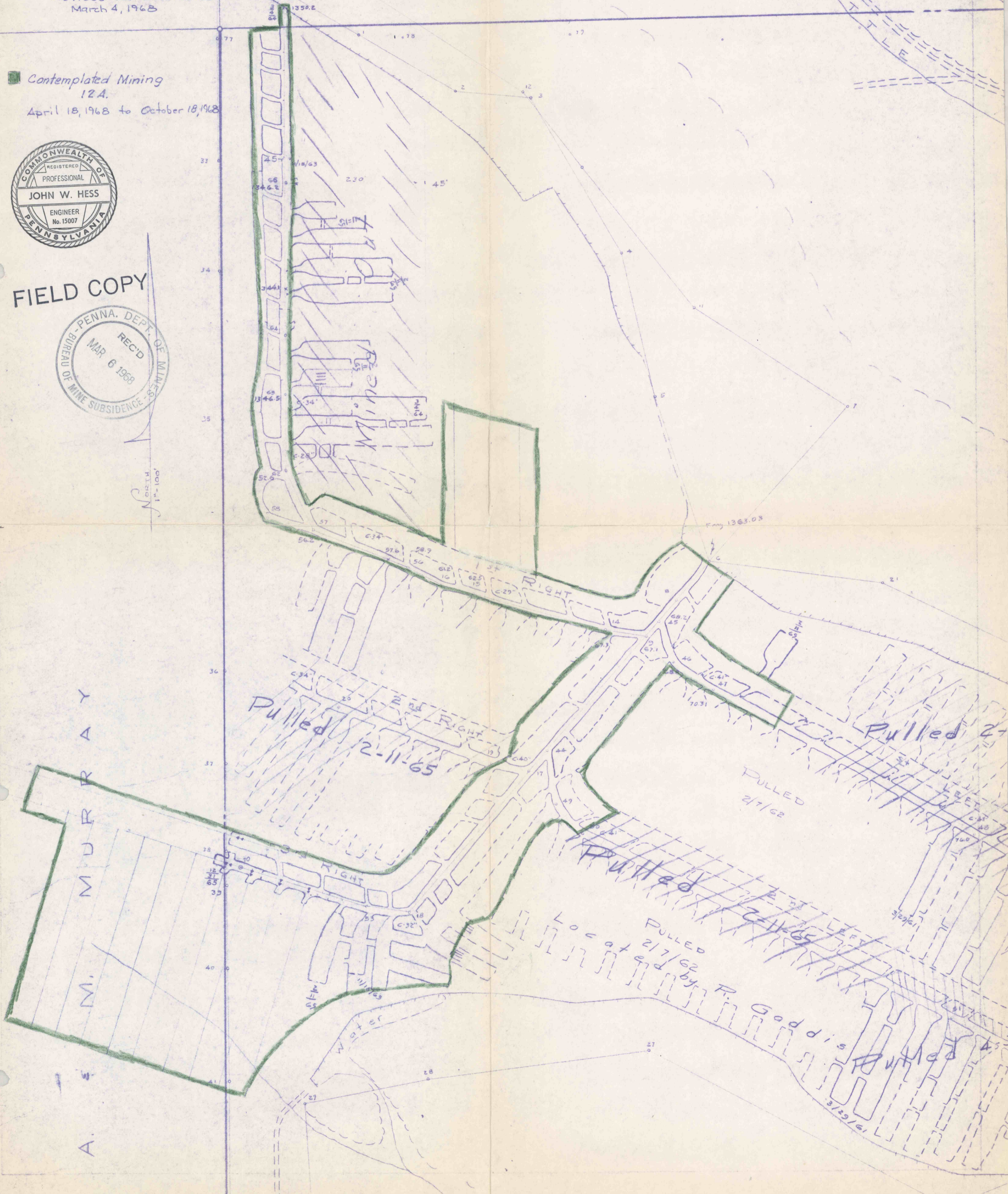

Y
A
R
R
M
U
R
N.

A.

Pulled 2-11-65

Pulled 2-

PULLED
2/7/62

Pulled 2-11-65

Located 2/7/62
by P. Gaddis

Pulled 2-

Pulled 2-

3/29/61