

April 1970

1" = 1000'

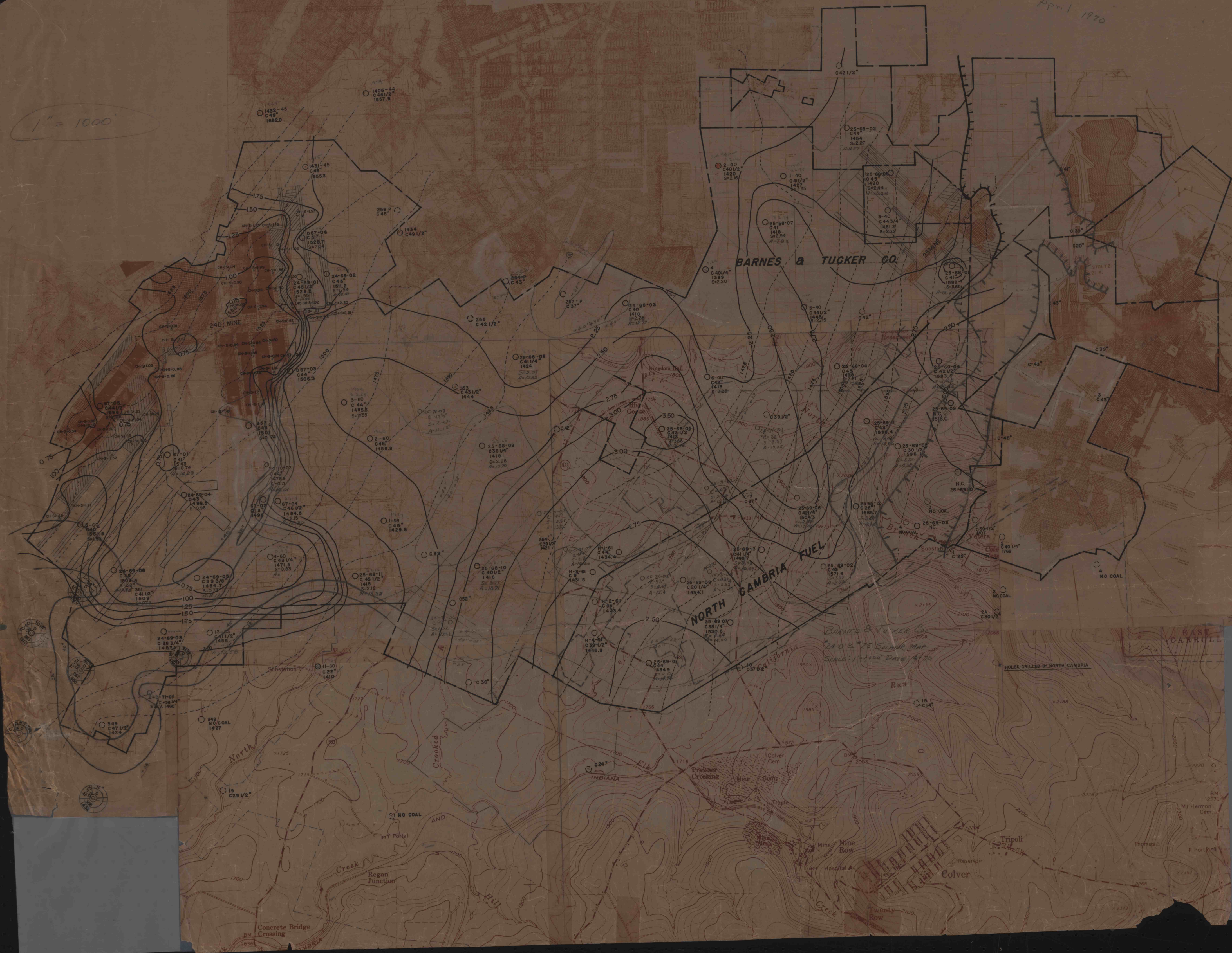

EAST CARROLL

BARNES & TUCKER CO.  
24D & 25 SUMMIT  
Scale: 1" = 1000' Date: 4/70

HOLES DRILLED BY NORTH GAMBRIA

MT Hermon Cem.

F. Port

Colver

Twenty Row

Mine Hospital

Professor Crossing

Colver Cem.

Tipple

Indiana

AND

NO COAL

NO COAL

NO COAL

NO COAL

NO COAL

NO COAL

NO COAL

NO COAL

NO COAL

NO COAL

NO COAL

NO COAL

NO COAL

NO COAL

NO COAL

NO COAL

NO COAL

NO COAL

NO COAL

NO COAL

NO COAL

NO COAL

Concrete Bridge Crossing