

MAP of the CAMBRIA IRON CO. COAL LANDS SITUATE CRESSION TWP., CAMBRIA CO., JUNIATA AND ALLEGHENY TWPS., BLAIR CO. PENNA.

SCALE - 1 INCH = 1000 FT. DEC. 14 - 1925
JAN. 1 - 1934

NOTE:-
 AREA OWNED IN FEE
 AREA MINERALS OWNED
 AREA SURFACE ONLY
 UPPER FREEPORT OR 'E' SEAM, WORKED OUT
 LOWER KITTANNING OR 'B' SEAM, WORKED OUT

TRACED FOR
 LEWIS L. GWIN
 CONSULTING ENGINEERS

TRACED BY
 JOHN W. FOREMAN - MINING ENGINEER
 GORDON C. ANTHONY

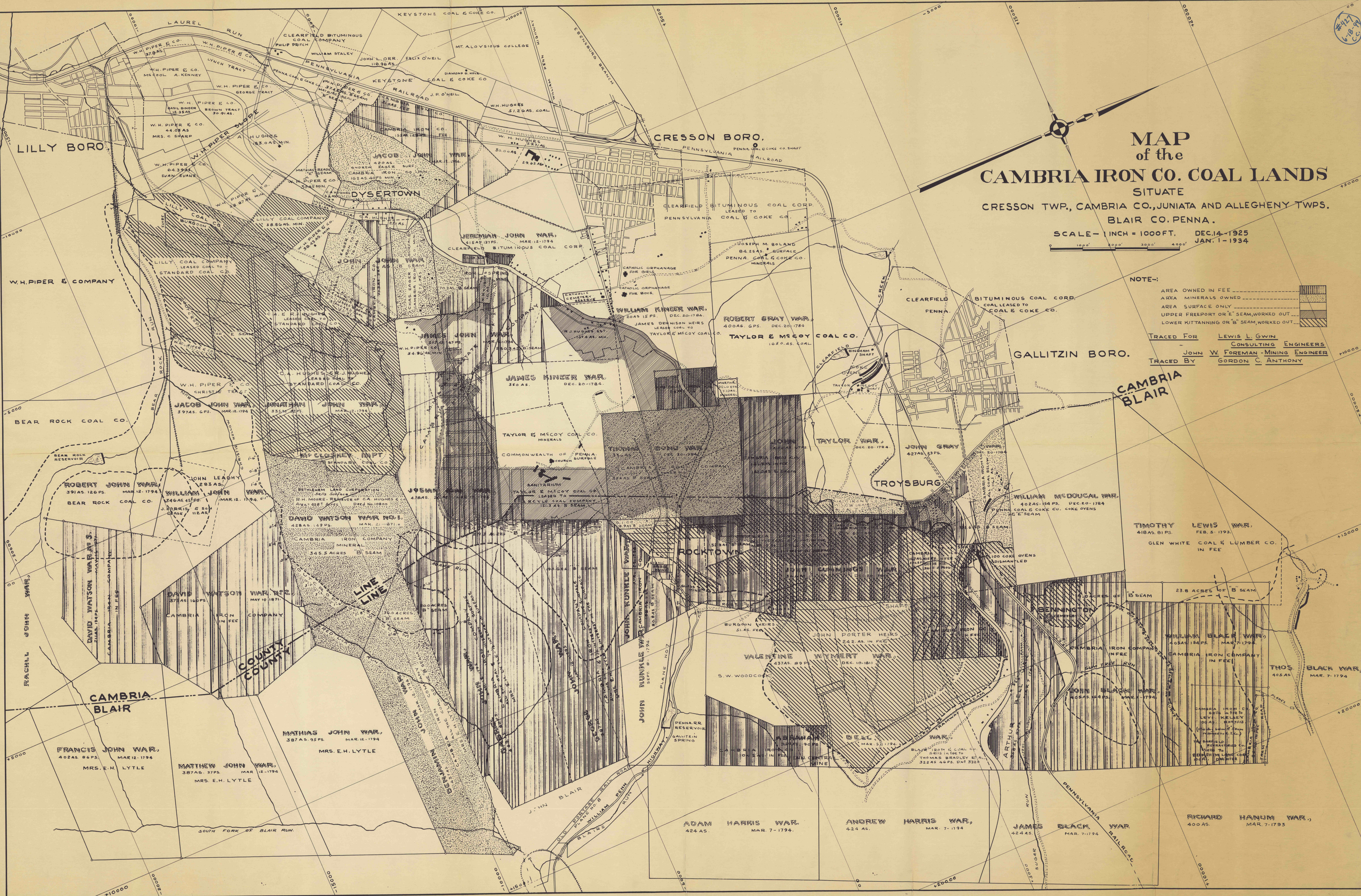

LILLY BORO

CRESSION BORO.

DYSERTOWN

TROYSBURG

GALLITZIN BORO.

CAMBRIA
BLAIR

ROCKTOWN

BENNINGTON

CAMBRIA
BLAIR

LINE
LINE

COUNTY
COUNTY

FRANCIS JOHN WAR,
402 AS. 8 PS. MAR. 12 - 1794

MATTHEW JOHN WAR,
387 AS. 3 PS. MAR. 12 - 1794

MATHIAS JOHN WAR,
387 AS. 95 PS. MAR. 12 - 1794

MRS. E. H. LYTLE

ADAM HARRIS WAR,
424 AS. MAR. 7 - 1794.

ANDREW HARRIS WAR,
424 AS. MAR. 7 - 1794

JAMES BLACK WAR,
424 AS. MAR. 7 - 1794

RICHARD HANUM WAR,
400 AS. MAR. 7 - 1793

THOS. BLACK WAR,
405 AS. MAR. 7 - 1794

WILLIAM BLACK WAR,
405 AS. 154 PS. MAR. 7 - 1794

JOHN BLACK WAR,
405 AS. 154 PS. MAR. 7 - 1794

VALENTINE WYMERT WAR,
437 AS. 89 PS. DEC. 10 - 1811

JOHN KUNKLE WAR,
SEPT. 8 - 1794

WILLIAM MCDUGAL WAR,
402 AS. 154 PS. DEC. 20 - 1784

JOHN GRAY
427 AS. 23 PS.

TAYLOR WAR,
DEC. 20 - 1784

TAYLOR & MCGOY COAL CO.
MINERALS

JAMES KINER WAR,
360 AS. DEC. 20 - 1784.

ROBERT GRAY WAR,
400 AS. 6 PS. DEC. 20 - 1784

WILLIAM KINER WAR,
30 AS. 15 PS. DEC. 20 - 1784.

JOHN JOHN WAR,
415 AS. 127 PS. MAR. 12 - 1794

JACOB JOHN WAR,
397 AS. 6 PS. MAR. 12 - 1794

WILLIAM JOHN WAR,
346 AS. 45 PS. MAR. 12 - 1794

ROBERT JOHN WAR,
391 AS. 126 PS. MAR. 12 - 1794

BEAR ROCK COAL CO.

W. H. PIPER & COMPANY

LILLY BORO

W. H. PIPER & CO.