

MINING ENGINEERING AND SURVEYING DEPARTMENT
OF THE
CAMBRIA STEEL COMPANY

Johnstown Pa Nov 8 1902

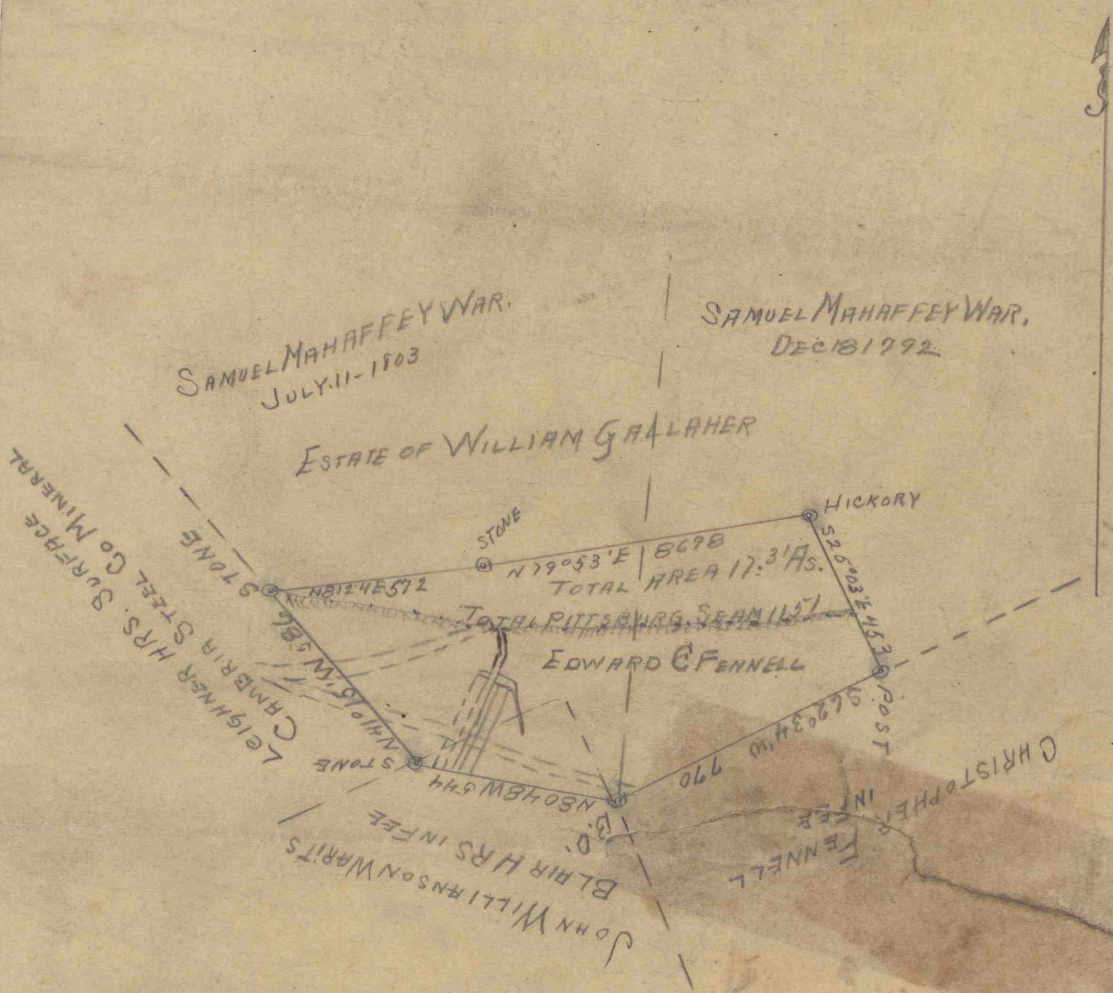

TOTAL PITTSBURG SEAM 11.51 AS
WORKED OUT .74
REMAINING 10.77

SITUATE IN THE TOWNSHIP OF SALEM COUNTY OF WESTMORELAND AND STATE OF PENNSYLVANIA BEING A PART OF TWO TRACTS OF LAND WARRANTED IN THE NAME OF SAMUEL MAHAFFEY AND DATED, DEC 18 1792 AND JULY 11 1803 AND ALSO BEING PART OF TWO OTHER TRACTS OF LAND WARRANTED IN THE NAME OF JOHN WILLIAMSON AND DATED NOV 2 1773 AND MAR 16 1786 RESPECTIVELY

Scale 1" = 500 FT

Compared by Holt & Crick

Surveyed by J.E. ELRICK DATE NOV 6 1902

L.H. 4309