

COAL AREAS BY HILLS

AREA OF A COAL IN HILL	P	290 AS	128 PS
AREA OF B COAL IN HILL	Q	145 "	150 "
AREA OF C COAL IN HILL	R	43 "	"
LINE OF COOPER & RAPHOON	Q	WEST OF 1773	385 AS, 75 PS
AREA OF A COAL IN HILL	R	185 AS	75 PS
AREA OF B COAL IN HILL	Q	107 "	65 "
AREA OF C COAL IN HILL	R	49 "	43 "
AREA OF A COAL IN HILL	R	31 "	"
AREA OF B COAL IN HILL	R	19 "	"
AREA OF C COAL IN HILL	R	8 "	96 "
AREA OF A COAL IN HILL	S	FROM COOPER	"
RALPHON LINE EASTWD TO	S	433	"
AREA OF B COAL IN HILL	S	240	"
AREA OF C COAL IN HILL	S	101	81
AREA OF GORMAN	S	27	"
AREA OF A COAL IN HILL	T	FROM	"
EASTWD TO EAST LINE OF CALVERT	T	202	68
AREA OF B COAL IN HILL	T	116	"
AREA OF C COAL IN HILL	T	19	"

TOTAL COAL AREAS

TOTAL AREA OF A COAL	1332 AS, 1113 PS
" " B	755 " 130 "
" " C	279 " 82 "
" " GORMAN	76 " 43 "

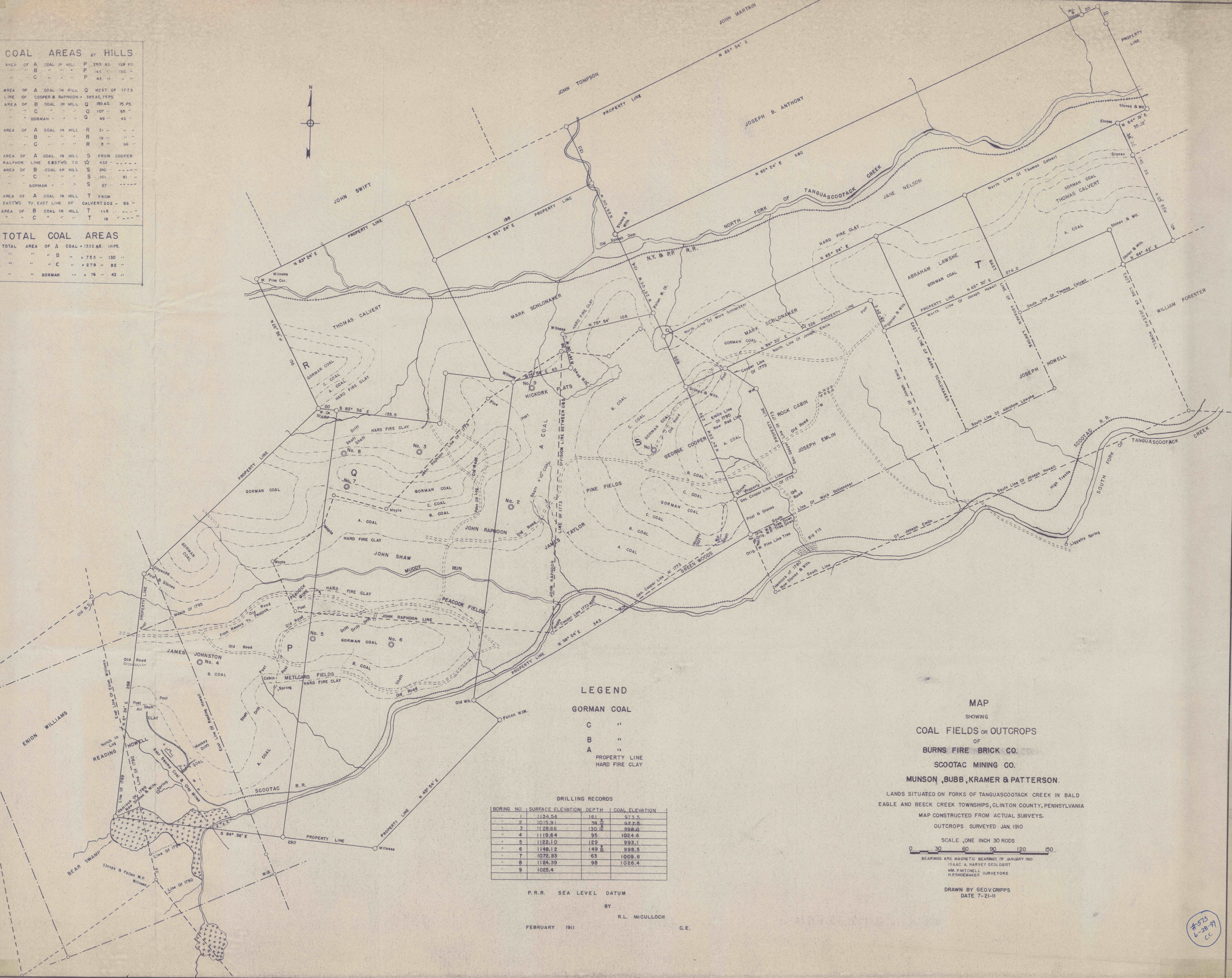
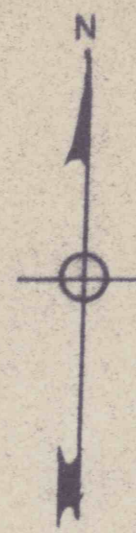

LEGEND

- GORMAN COAL**
- C " " " " "
 - B " " " " " "
 - A " " " " " "
- PROPERTY LINE
HARD FIRE CLAY

DRILLING RECORDS

BORING NO.	SURFACE ELEVATION	DEPTH	COAL ELEVATION
1	1134.54	161	973.5
2	1015.91	38	977.8
3	1128.66	130.8	998.4
4	1119.64	95	1024.6
5	1122.10	129	993.1
6	1148.12	149.8	998.5
7	1072.83	63	1009.8
8	1124.39	98	1026.4
9	1025.4		

P.R.R. SEA LEVEL DATUM
BY
R.L. McCULLOUGH
G.E.
FEBRUARY 1911

MAP

SHOWING
COAL FIELDS OR OUTCROPS
OF
BURNS FIRE BRICK CO.
SCOOTAC MINING CO.
MUNSON, BUBB, KRAMER & PATTERSON.
LANDS SITUATED ON FORKS OF TANGUASCOOTACK CREEK IN BALD
EAGLE AND BECK CREEK TOWNSHIPS, CLINTON COUNTY, PENNSYLVANIA
MAP CONSTRUCTED FROM ACTUAL SURVEYS.
OUTCROPS SURVEYED JAN. 1910

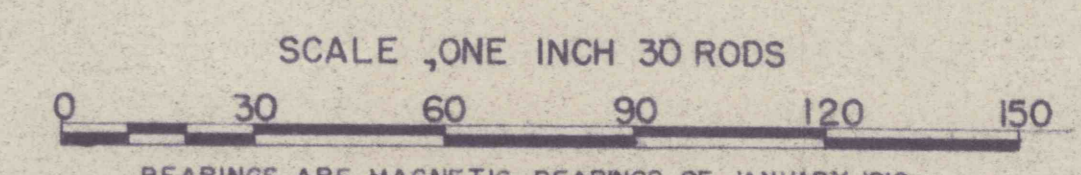

BEARINGS ARE MAGNETIC BEARINGS OF JANUARY 1910
ISAAC A. HARVEY GEOLOGIST
WM. MITCHELL SURVEYORS
H.P. SHOEMAKER

DRAWN BY GEO. CRIPPS
DATE 7-21-11

#573
6-28-99
cc