

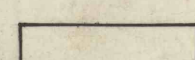

LEGEND

-  MINED UNDER PERMIT No.362M225 ±283.57Ac. lower Kittanning coal
-  AREA OF PROPOSED MINING IN FUTURE ±1430 Ac. lower Kittanning coal
-  ROAD
-  DRIFT MOUTH
-  APPROX. OUTCROP ±3,701.5 Ac. total area shown

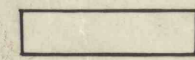
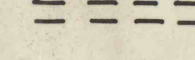
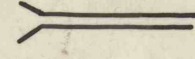

PROPERTY MAP FOR DORA No. 2
 DOVERSPIKE BROTHERS COAL COMPANY, INC.

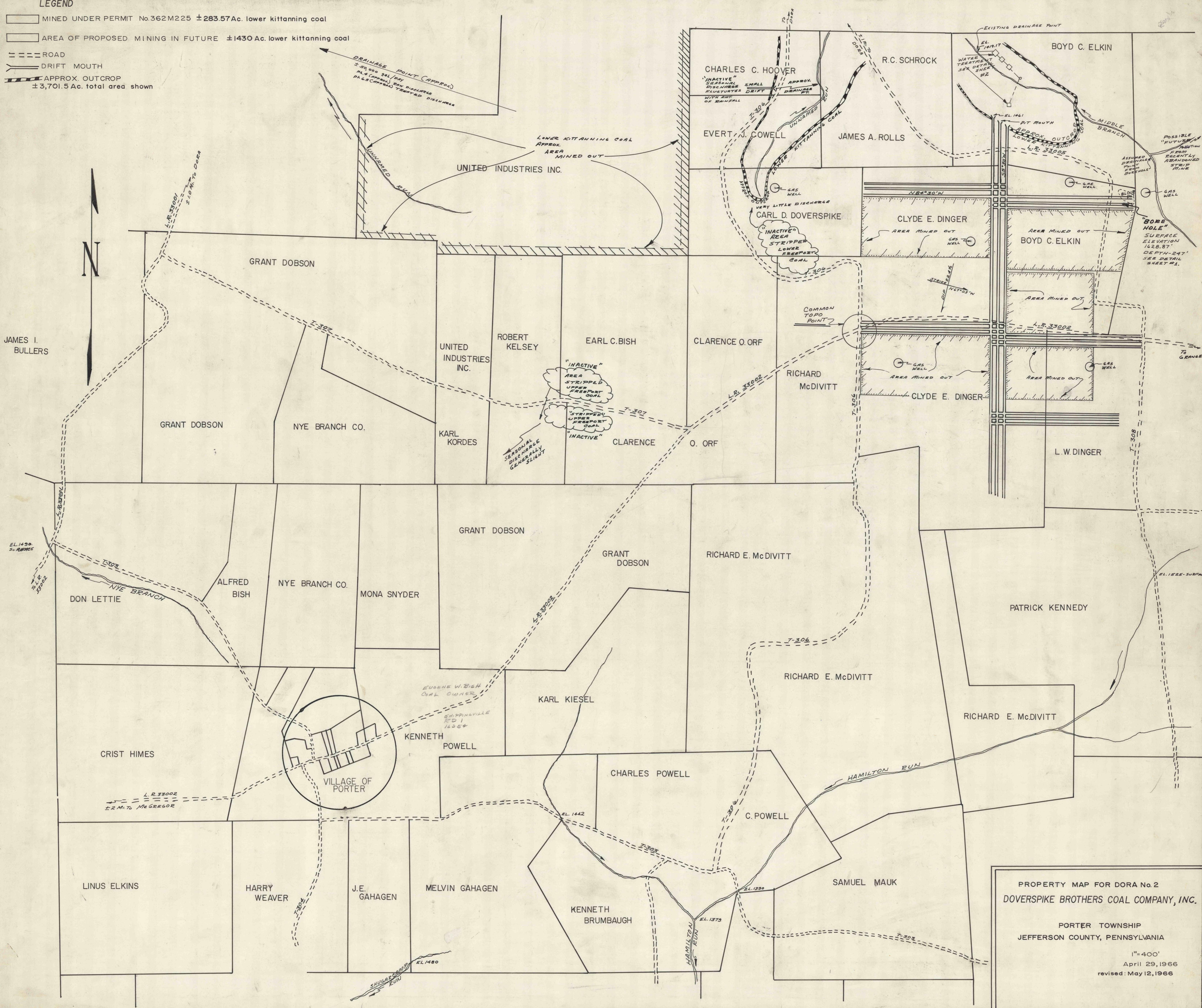
PORTER TOWNSHIP
 JEFFERSON COUNTY, PENNSYLVANIA

1" = 400'
 April 29, 1966
 revised: May 12, 1966