

N 458,000
E 1745,000

E 1744,000

E 1743,000

E 1742,000

N 457,000

N 456,000

E 455,000

N 454,000

MATCH TO SHEET 28

N 7

N 6

N 5

N 4

E 24

E 23

E 22

E 21
2519.2 F
EL. 1822.44

D-61 x
EL. 2077.29
D-52 x
EL. 2058.48

GEORGE FARABAUGH
70.00 A.

P. H. GAIN
180.07 A.

1.80

T 484

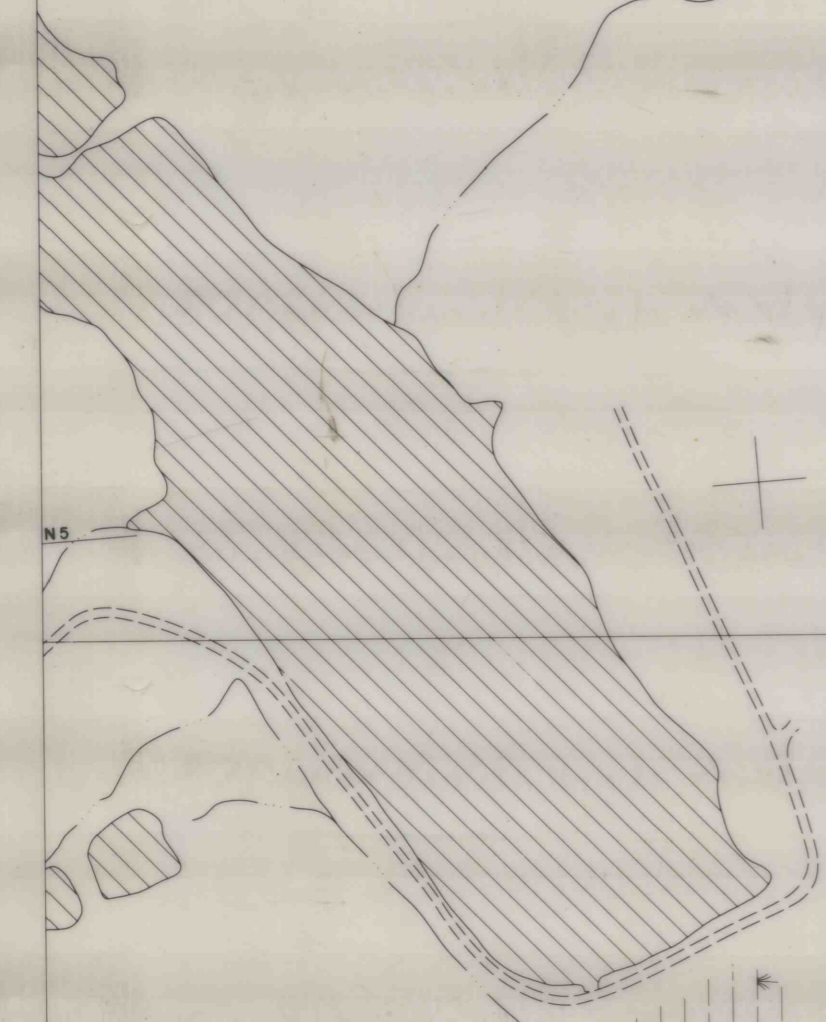

4421



MATCH TO SHEET 3F

BARNES & TUCKER COMPANY
LANCASHIRE NO. 20 MINE
EAST CARROLL TOWNSHIP, CAMBRIA COUNTY, PENNSYLVANIA
SCALE: 1"=400'
DATE: JULY, 1978

2F