

**DISCLAIMER:** This map is provided as a courtesy to the Pennsylvania Bureau of Deep Mine Safety by American Premier Underwriters, Inc. (APU) The Penn Central Railroad Corporation and its subsidiary United Railroad Corp. which own or owned, but do not operate, the coal assets depicted herein.

American Premier Underwriters, Inc. and United Railroad Corp. disclaim any representation or duty to any person as to the accuracy or completeness of this map or its fitness for any particular mining, safety or other mine-related purpose. Any person who uses this map for any reason undertakes an independent duty to verify its accuracy and completeness. American Premier Underwriters, Inc., United Railroad Corp. and their respective affiliates, shareholders, directors, officers and employees disclaim any liability arising from its use.

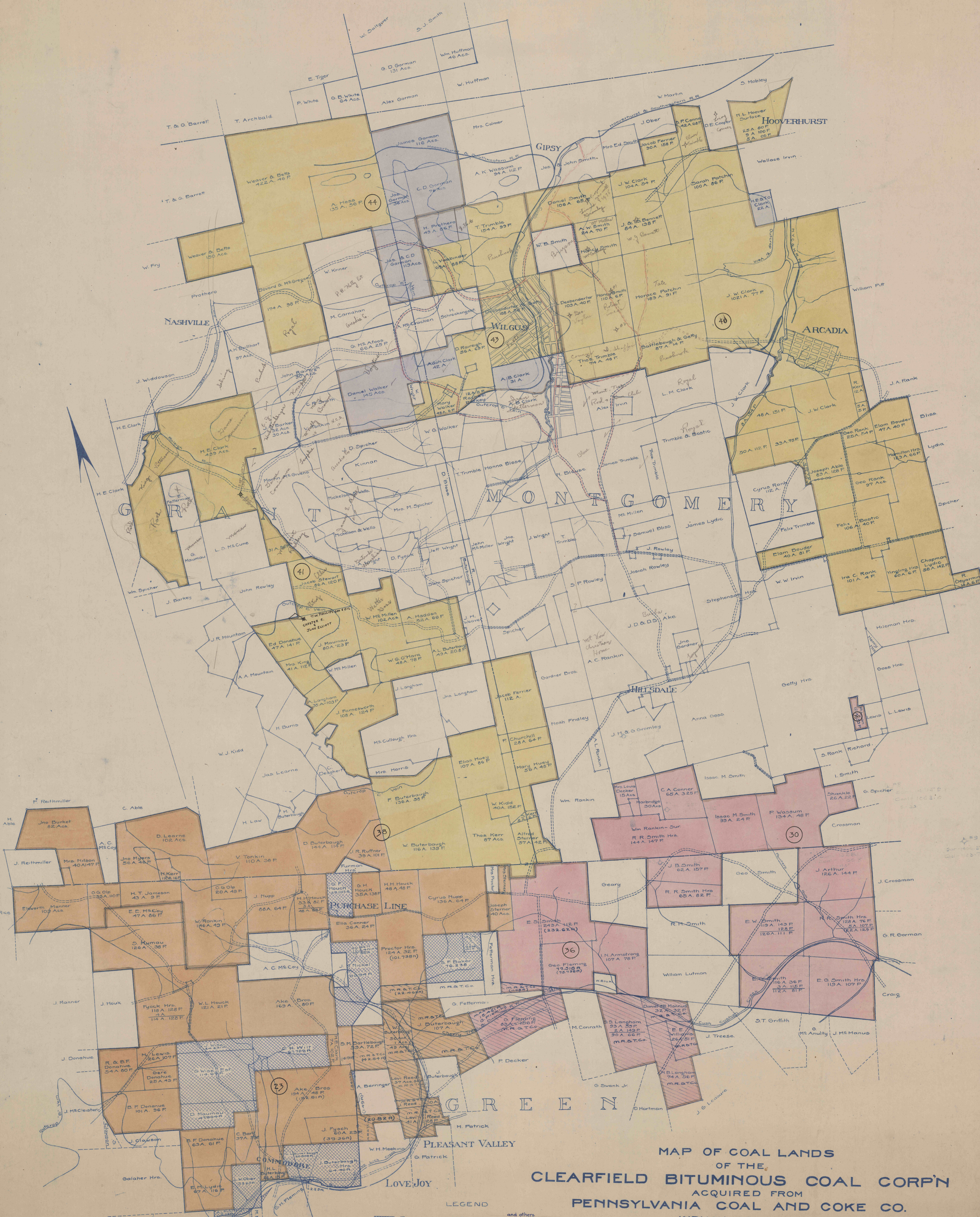

**MAP OF COAL LANDS  
OF THE  
CLEARFIELD BITUMINOUS COAL CORP'N  
ACQUIRED FROM  
PENNSYLVANIA COAL AND COKE CO.  
INDIANA CO., PENNA.**

SCALE 1" = 1000'      APRIL 1914

- LEGEND**
- Property acquired from M.R.E. & T. Co. and retained by C.B.C. Corp. and others
  - Property acquired from P.C. & C. Co. and retained by C.B.C. Corp.
  - Property acquired from P.C. & C. Co. and leased and operated by P.C. & C. Corp.
  - Property acquired from P.C. & C. Co. leased to P.C. & C. Corp. and surrendered to C.B.C. Corp. by modified lease of June 18, 1913.
  - Outside leasehold premises operated by P.C. & C. Corp.
  - Property sold or exchanged or leasehold surrendered.

Tract and number as shown in deed from P.C. & C. Corp. to C.B.C. Corp. Nov. 15, 1911.

REVISED SEPT. 1919  
REVISED JAN. 1923