

DISCLAIMER: This map is provided as a courtesy to the Pennsylvania Bureau of Deep Mine Safety by American Premier Underwriters, Inc. (f/k/a The Penn Central Railroad Corporation) and its subsidiary United Railroad Corp., which own or owned, but do not operate, the coal assets depicted hereon. American Premier Underwriters, Inc. and United Railroad Corp. disclaim any representation or duty to any person for any inaccuracy or completeness of this map for related purposes. American Premier Underwriters, Inc. and United Railroad Corp. disclaim any responsibility for any estate related undertakings, including mining, safety or real estate related undertakings, in the accuracy of this map for any accuracy and hold American Premier Underwriters, Inc., United Railroad Corp. and their respective affiliates, shareholders, directors, officers and employees harmless from damage or liability arising from use.

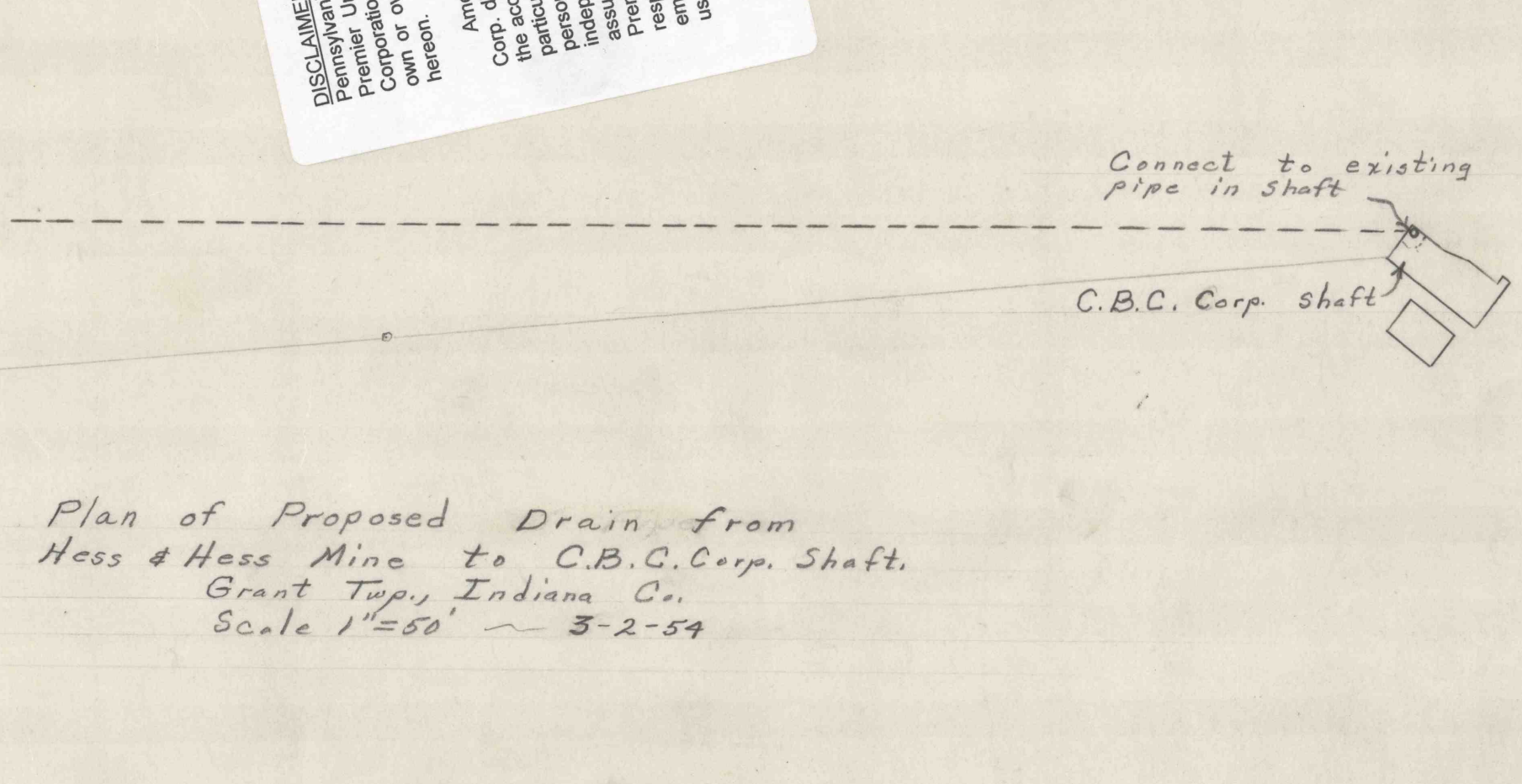

Plan of Proposed Drain from Hess # Hess Mine to C.B.C. Corp. Shaft, Grant Twp., Indiana Co. Scale 1"=50' ~ 3-2-54

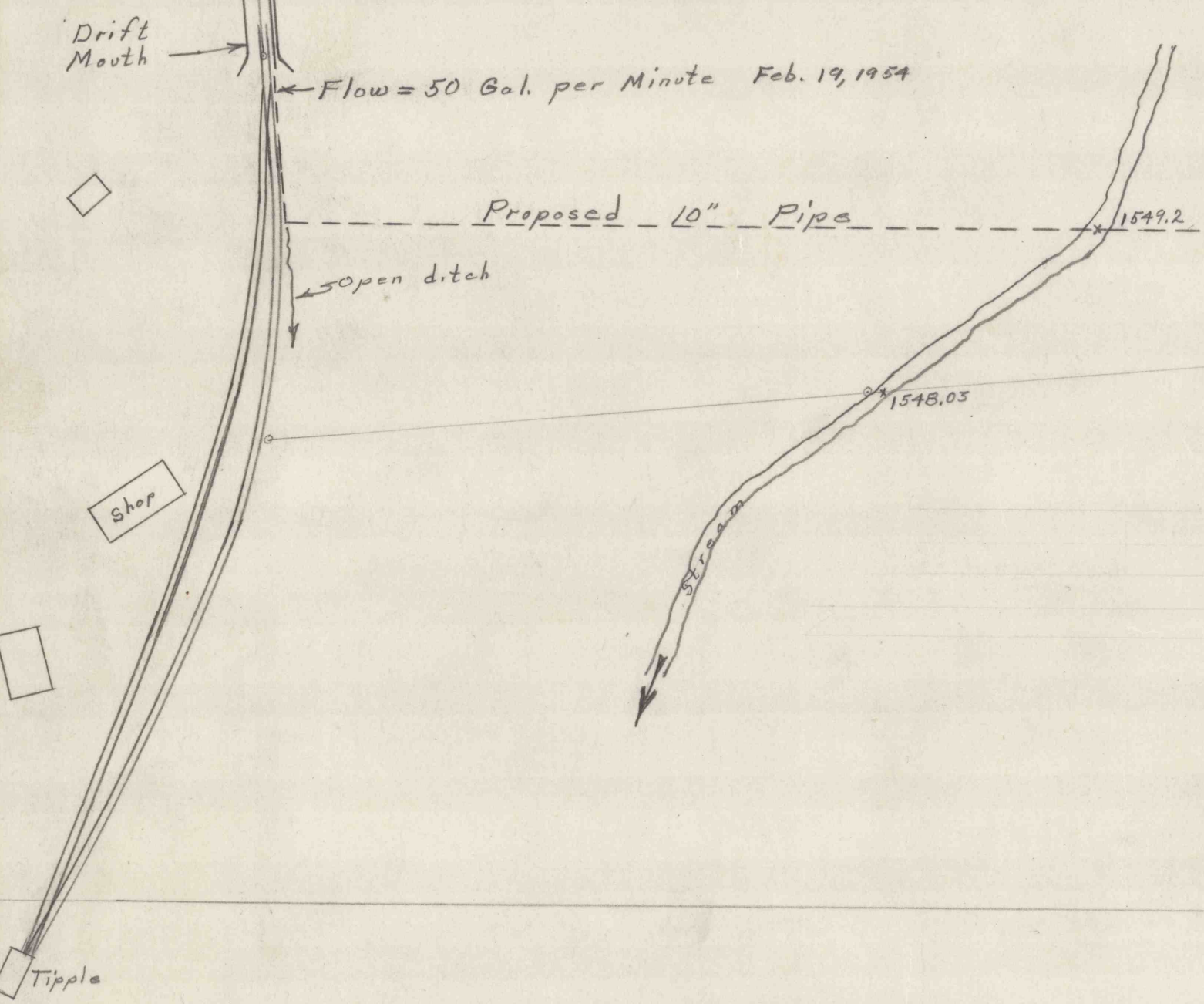
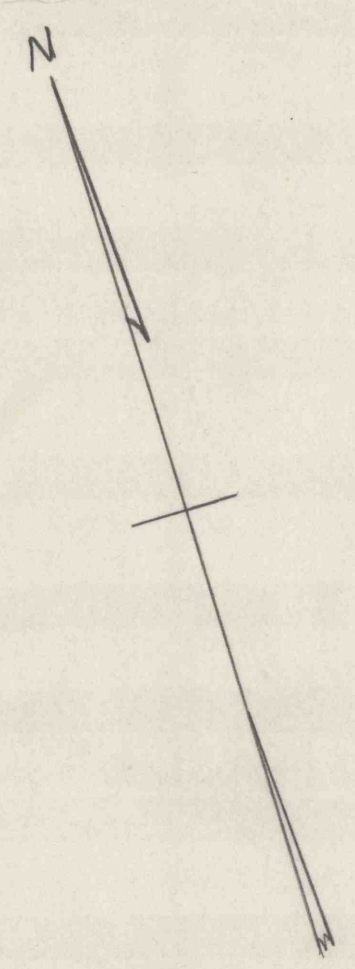
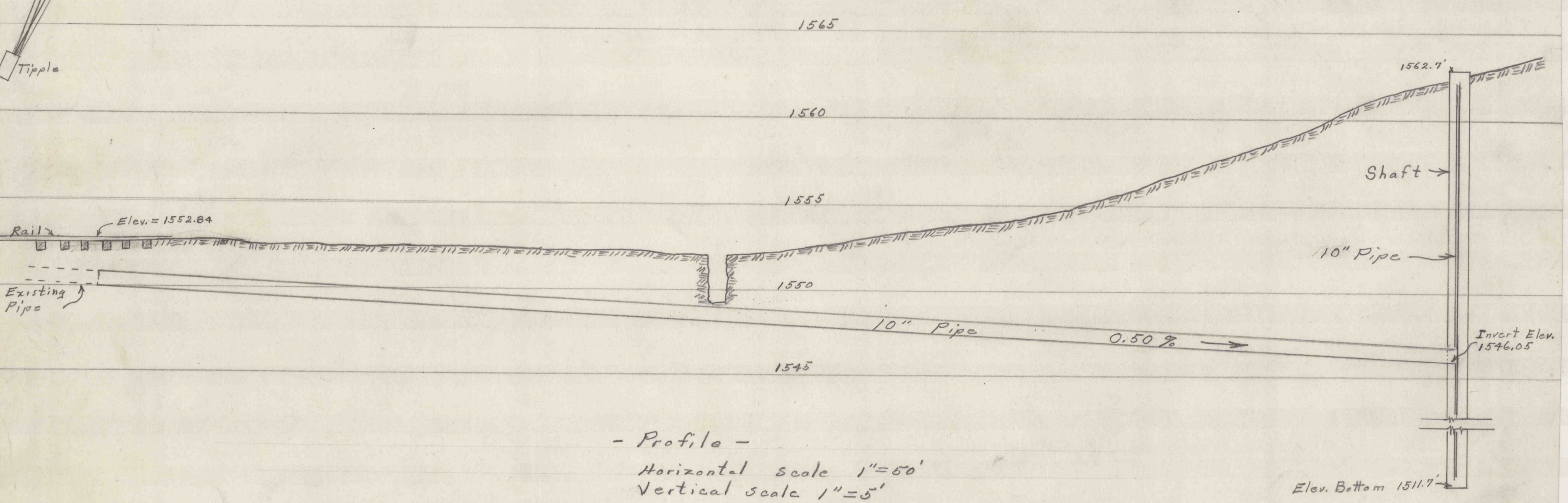

- Profile -
 Horizontal scale 1"=50'
 Vertical scale 1"=5'