

**SURFACE/SUBSURFACE OWNERSHIP**

SURFACE OWNERSHIP	COAL AND SUBSURFACE OWNERSHIP
1. Carrara Coal, Inc.	1. Carrara Coal, Inc.
2. Carrara Coal, Inc.	2. Carrara Coal, Inc.
3. Carrara Coal, Inc.	3. Carrara Coal, Inc.
4. Carrara Coal, Inc.	4. Carrara Coal, Inc.
5. Carrara Coal, Inc.	5. Carrara Coal, Inc.
6. Carrara Coal, Inc.	6. Carrara Coal, Inc.
7. Carrara Coal, Inc.	7. Carrara Coal, Inc.
8. Carrara Coal, Inc.	8. Carrara Coal, Inc.
9. Carrara Coal, Inc.	9. Carrara Coal, Inc.
10. Carrara Coal, Inc.	10. Carrara Coal, Inc.
11. Carrara Coal, Inc.	11. Carrara Coal, Inc.
12. Carrara Coal, Inc.	12. Carrara Coal, Inc.
13. Carrara Coal, Inc.	13. Carrara Coal, Inc.
14. Carrara Coal, Inc.	14. Carrara Coal, Inc.
15. Carrara Coal, Inc.	15. Carrara Coal, Inc.
16. Carrara Coal, Inc.	16. Carrara Coal, Inc.
17. Carrara Coal, Inc.	17. Carrara Coal, Inc.
18. Carrara Coal, Inc.	18. Carrara Coal, Inc.
19. Carrara Coal, Inc.	19. Carrara Coal, Inc.
20. Carrara Coal, Inc.	20. Carrara Coal, Inc.
21. Carrara Coal, Inc.	21. Carrara Coal, Inc.
22. Carrara Coal, Inc.	22. Carrara Coal, Inc.
23. Carrara Coal, Inc.	23. Carrara Coal, Inc.
24. Carrara Coal, Inc.	24. Carrara Coal, Inc.
25. Carrara Coal, Inc.	25. Carrara Coal, Inc.
26. Carrara Coal, Inc.	26. Carrara Coal, Inc.
27. Carrara Coal, Inc.	27. Carrara Coal, Inc.
28. Carrara Coal, Inc.	28. Carrara Coal, Inc.
29. Carrara Coal, Inc.	29. Carrara Coal, Inc.
30. Carrara Coal, Inc.	30. Carrara Coal, Inc.
31. Carrara Coal, Inc.	31. Carrara Coal, Inc.
32. Carrara Coal, Inc.	32. Carrara Coal, Inc.
33. Carrara Coal, Inc.	33. Carrara Coal, Inc.
34. Carrara Coal, Inc.	34. Carrara Coal, Inc.
35. Carrara Coal, Inc.	35. Carrara Coal, Inc.
36. Carrara Coal, Inc.	36. Carrara Coal, Inc.
37. Carrara Coal, Inc.	37. Carrara Coal, Inc.
38. Carrara Coal, Inc.	38. Carrara Coal, Inc.
39. Carrara Coal, Inc.	39. Carrara Coal, Inc.
40. Carrara Coal, Inc.	40. Carrara Coal, Inc.
41. Carrara Coal, Inc.	41. Carrara Coal, Inc.
42. Carrara Coal, Inc.	42. Carrara Coal, Inc.
43. Carrara Coal, Inc.	43. Carrara Coal, Inc.
44. Carrara Coal, Inc.	44. Carrara Coal, Inc.
45. Carrara Coal, Inc.	45. Carrara Coal, Inc.
46. Carrara Coal, Inc.	46. Carrara Coal, Inc.
47. Carrara Coal, Inc.	47. Carrara Coal, Inc.
48. Carrara Coal, Inc.	48. Carrara Coal, Inc.
49. Carrara Coal, Inc.	49. Carrara Coal, Inc.
50. Carrara Coal, Inc.	50. Carrara Coal, Inc.
51. Carrara Coal, Inc.	51. Carrara Coal, Inc.
52. Carrara Coal, Inc.	52. Carrara Coal, Inc.
53. Carrara Coal, Inc.	53. Carrara Coal, Inc.
54. Carrara Coal, Inc.	54. Carrara Coal, Inc.
55. Carrara Coal, Inc.	55. Carrara Coal, Inc.
56. Carrara Coal, Inc.	56. Carrara Coal, Inc.
57. Carrara Coal, Inc.	57. Carrara Coal, Inc.
58. Carrara Coal, Inc.	58. Carrara Coal, Inc.
59. Carrara Coal, Inc.	59. Carrara Coal, Inc.
60. Carrara Coal, Inc.	60. Carrara Coal, Inc.
61. Carrara Coal, Inc.	61. Carrara Coal, Inc.
62. Carrara Coal, Inc.	62. Carrara Coal, Inc.
63. Carrara Coal, Inc.	63. Carrara Coal, Inc.
64. Carrara Coal, Inc.	64. Carrara Coal, Inc.
65. Carrara Coal, Inc.	65. Carrara Coal, Inc.
66. Carrara Coal, Inc.	66. Carrara Coal, Inc.
67. Carrara Coal, Inc.	67. Carrara Coal, Inc.
68. Carrara Coal, Inc.	68. Carrara Coal, Inc.
69. Carrara Coal, Inc.	69. Carrara Coal, Inc.
70. Carrara Coal, Inc.	70. Carrara Coal, Inc.
71. Carrara Coal, Inc.	71. Carrara Coal, Inc.
72. Carrara Coal, Inc.	72. Carrara Coal, Inc.
73. Carrara Coal, Inc.	73. Carrara Coal, Inc.
74. Carrara Coal, Inc.	74. Carrara Coal, Inc.
75. Carrara Coal, Inc.	75. Carrara Coal, Inc.
76. Carrara Coal, Inc.	76. Carrara Coal, Inc.
77. Carrara Coal, Inc.	77. Carrara Coal, Inc.
78. Carrara Coal, Inc.	78. Carrara Coal, Inc.
79. Carrara Coal, Inc.	79. Carrara Coal, Inc.
80. Carrara Coal, Inc.	80. Carrara Coal, Inc.
81. Carrara Coal, Inc.	81. Carrara Coal, Inc.
82. Carrara Coal, Inc.	82. Carrara Coal, Inc.
83. Carrara Coal, Inc.	83. Carrara Coal, Inc.
84. Carrara Coal, Inc.	84. Carrara Coal, Inc.
85. Carrara Coal, Inc.	85. Carrara Coal, Inc.
86. Carrara Coal, Inc.	86. Carrara Coal, Inc.
87. Carrara Coal, Inc.	87. Carrara Coal, Inc.
88. Carrara Coal, Inc.	88. Carrara Coal, Inc.
89. Carrara Coal, Inc.	89. Carrara Coal, Inc.
90. Carrara Coal, Inc.	90. Carrara Coal, Inc.
91. Carrara Coal, Inc.	91. Carrara Coal, Inc.
92. Carrara Coal, Inc.	92. Carrara Coal, Inc.
93. Carrara Coal, Inc.	93. Carrara Coal, Inc.
94. Carrara Coal, Inc.	94. Carrara Coal, Inc.
95. Carrara Coal, Inc.	95. Carrara Coal, Inc.
96. Carrara Coal, Inc.	96. Carrara Coal, Inc.
97. Carrara Coal, Inc.	97. Carrara Coal, Inc.
98. Carrara Coal, Inc.	98. Carrara Coal, Inc.
99. Carrara Coal, Inc.	99. Carrara Coal, Inc.
100. Carrara Coal, Inc.	100. Carrara Coal, Inc.

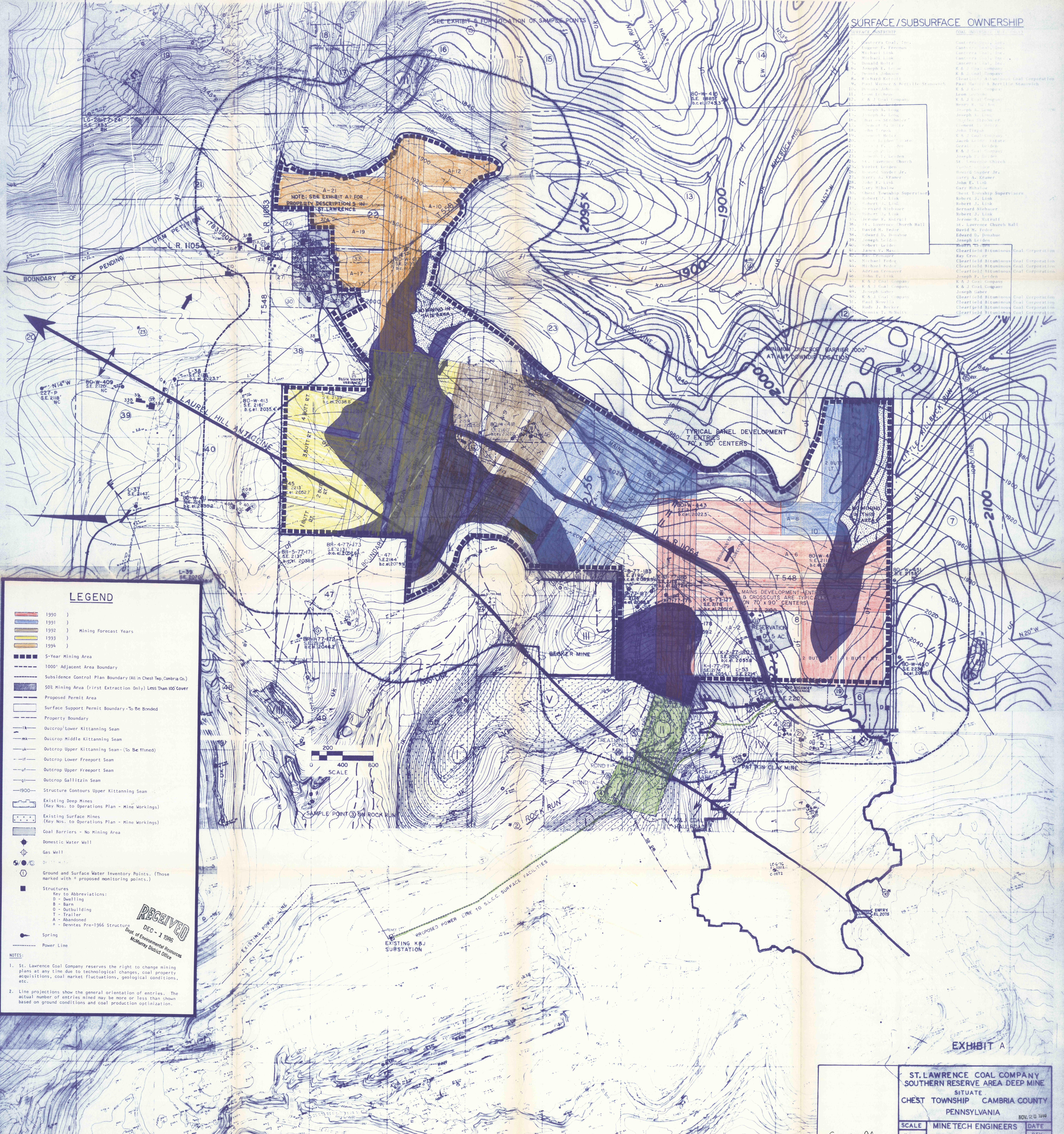

**LEGEND**

- 1990 ) Mining Forecast Years
- 1991 )
- 1992 )
- 1993 )
- 1994 )
- 5-Year Mining Area
- 1000' Adjacent Area Boundary
- Subsidence Control Plan Boundary (All in Chest Twp, Cambria Co.)
- 50% Mining Area (First Extraction Only) Less Than 100' Cover
- Proposed Permit Area
- Surface Support Permit Boundary - To Be Bonded
- Property Boundary
- Outcrop Lower Kittanning Seam
- Outcrop Middle Kittanning Seam
- Outcrop Upper Kittanning Seam - (To Be Mined)
- Outcrop Lower Freeport Seam
- Outcrop Upper Freeport Seam
- Outcrop Gallitzin Seam
- Structure Contours Upper Kittanning Seam
- Existing Deep Mines (Key Nos. to Operations Plan - Mine Workings)
- Existing Surface Mines (Key Nos. to Operations Plan - Mine Workings)
- Coal Barriers - No Mining Area
- Domestic Water Well
- Gas Well
- Ground and Surface Water Inventory Points. (Those marked with \* proposed monitoring points.)
- Structures
  - Key to Abbreviations:
  - D - Dwelling
  - B - Barn
  - O - Outbuilding
  - T - Trailer
  - A - Abandoned
  - \* - Denotes Pre-1966 Structure
- Spring
- Power Line

**RECEIVED**  
 DEC - 1 1996  
 Dept. of Environmental Resources  
 Mahanoy District Office

**NOTES:**

1. St. Lawrence Coal Company reserves the right to change mining plans at any time due to technological changes, coal property acquisitions, coal market fluctuations, geological conditions, etc.
2. Line projections show the general orientation of entries. The actual number of entries mined may be more or less than shown based on ground conditions and coal production optimization.

EXHIBIT A

**ST. LAWRENCE COAL COMPANY**  
**SOUTHERN RESERVE AREA DEEP MINE**  
 SITUATE  
 CHEST TOWNSHIP CAMBRIA COUNTY  
 PENNSYLVANIA

NOV. 28 1996

SCALE: 1" = 400'  
 MINE TECH ENGINEERS  
 ALTOONA PENNSYLVANIA

DATE: REV. 10-88

*Scott M. Coleman*