

DISCLAIMER: This map is provided as a courtesy to the American Premier Underwriters, Inc. and United Railroad Corp. and its subsidiary United Railroad Corp. (which Premier Underwriters Bureau of Deep Mine Safety by American Premier Underwriters, Inc. (the Perm Central Railroad Corporation) and its subsidiary United Railroad Corp. do not own or operate, but do not operate, the coal assets depicted hereon. The map is provided as a courtesy to the American Premier Underwriters, Inc. and United Railroad Corp. disclaim any representation or duty to any person as to its accuracy or completeness of this map or its fitness for any particular mining, safety or related purpose. Any person who uses this map for any reason undertakes an independent duty to verify its accuracy and completeness. American Premier Underwriters, Inc., United Railroad Corp. and their respective affiliates, shareholders, directors, officers and employees hereby disclaim any liability arising from its use.

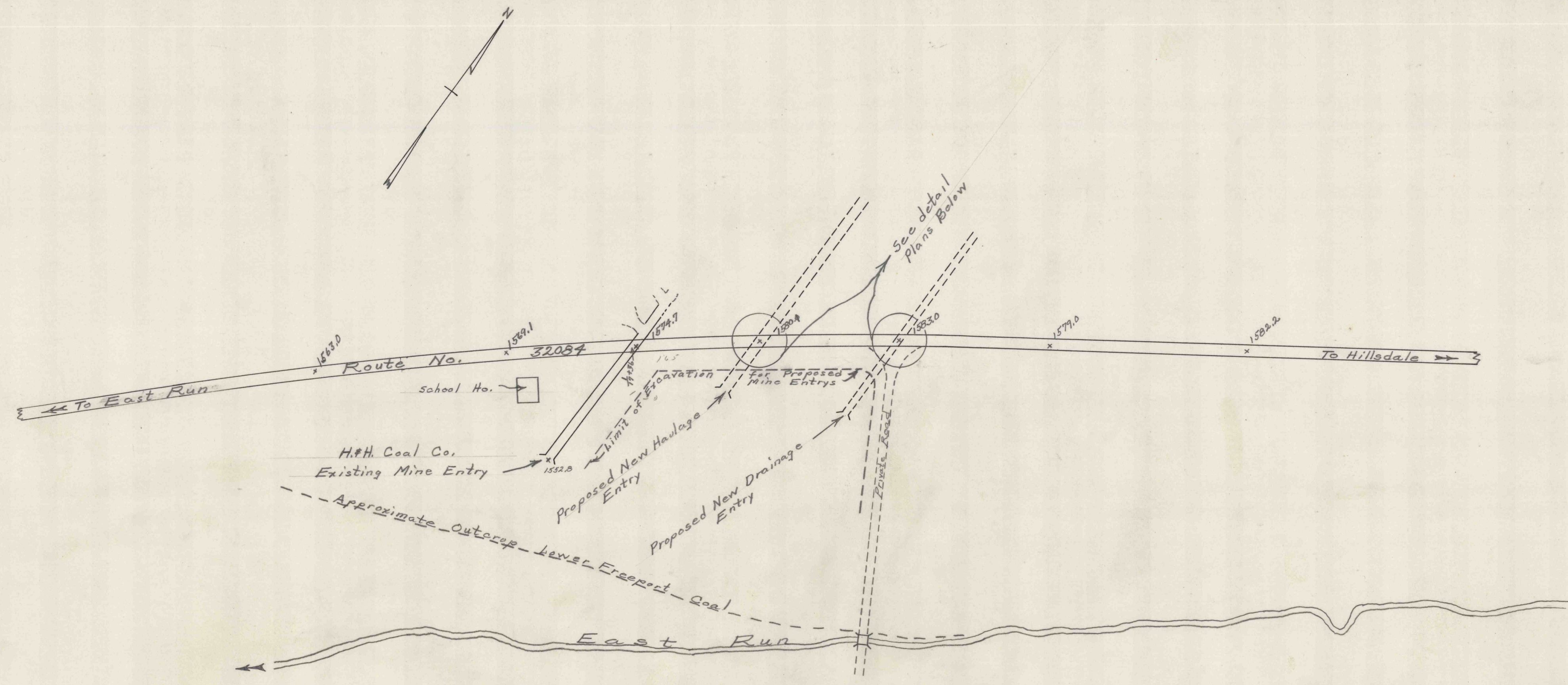

Map Showing Location of Proposed Mine Entries Under State Highway Route No. 32084  
Scale 1"=100'

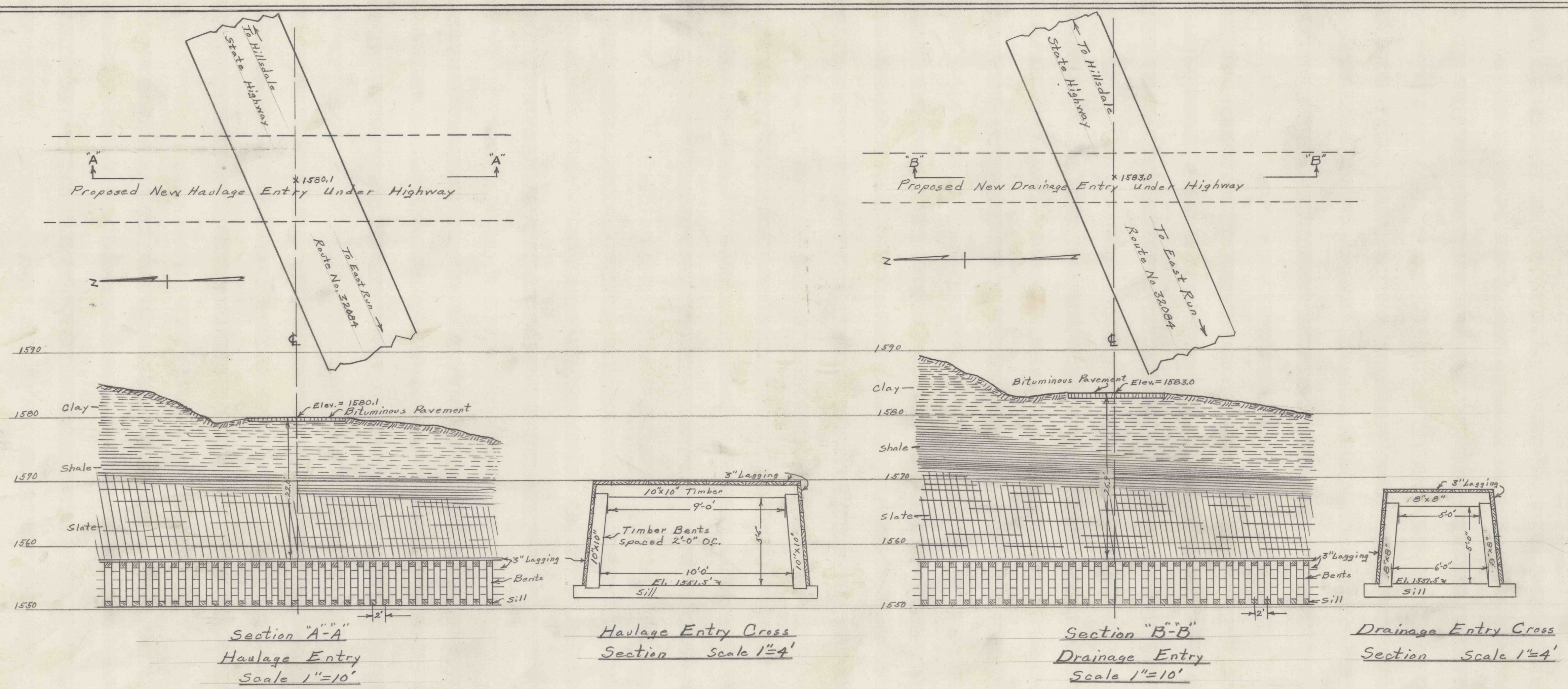

Section A-A  
Haulage Entry  
Scale 1"=10'

Haulage Entry Cross  
Section Scale 1"=4'

Section B-B  
Drainage Entry  
Scale 1"=10'

Drainage Entry Cross  
Section Scale 1"=4'

Elevations Based on C.B.C. Corp. Datum

Plan of Proposed Mine  
Entries under Highway for  
H. & H. Coal Company  
Grant Twp., Indiana Co.  
R. B. SHANNON & ASSOCIATES, INDIANA, PA.  
DRAWN BY P.B. DATE Sept. 1955  
SCALE As Shown DRAWING NO.