

NOTES

- 1) This map has been prepared from tax maps, deeds, quadrangles, air photographs, etc. along with field work.
- 2) The underlying Pittsburgh seam has been extensively deep mined by the inactive Shannopin Mine CMAP #30841306
- 3) There are no known faults, wants or areas of unminable thickness of the Sewickley seam in the permit area.
- 4) Outcrop lines of the coal seams taken from USGS Geologic Map.
- 5) As per Mr. Ike Lewis of the East Dunkard Water Association a 4" line exists along SR-2021 & Pigeon Hole Road and a 3" line exists along T-342, T-375 and T-530.
- 6) No water levels were available from the existing drill hole logs.

LEGEND

- PERMIT AREA : 1067.0 ACRES
- SUBSIDENCE CONTROL PLAN BOUNDARY
- STREAM
- POND
- ROAD
- PROPERTY LINE
- DWELLING, BUILDING
- Electric Line - ALLEGHENY POWER
- Telephone Line - ALLTEL
- Water Line - EAST DUNKARD WATER ASSOC.
- Gas Line - CARNEGIE NATURAL GAS CO.
- APPROXIMATE SEWICKLEY COAL CROPLINE
- APPROXIMATE WAYNESBURG COAL CROPLINE
- PREVIOUSLY AFFECTED AREA
- MINE ENTRY
- BACKGROUND WATER POINTS: 4, 5, 6, 7, 9
- MONITORING POINTS: 1, 2, 3, 8
- DRILL HOLE LOCATION
- HAULROAD
- APPK. POOL ELEV. PITTSBURGH SEAM
- APPK. POOL ELEV. SEWICKLEY SEAM
- COAL CONTOUR - SEWICKLEY SEAM
- CROSS-SECTION LINES

DRILL HOLE CHART

| DRILL HOLE | SURFACE ELEV. | SEWICKLEY COAL ELEV. |
|------------|---------------|----------------------|
| 2 | 871.30' | 838.80' |
| 3 | 865.85' | 846.85' |
| 4 | 870.13' | 829.63' |
| 7-D | 870.00' | 837.00' |
| 8 | 873.40' | 840.40' |
| 9 | 862.81' | 838.81' |
| J&L 1 | 977.75' | 715.56' |
| J&L 2 | 906.50' | 644.00' |
| J&L 4 | 1327.0' | 582.95' |
| J&L 5 | 1079.0' | 644.20' |
| J&L 6 | 1094.00' | 722.60' |
| J&L 7A | 906.50' | 644.00' |
| J&L 20 | 896.00' | 809.90' |
| DEV 5 | 1072.50' | 734.10' |
| DEV 6 | 924.00' | 688.70' |
| DEV 7 | 1008.00' | 794.20' |
| DEV 8 | 1153.60' | 814.90' |
| DEV 9 | 985.90' | 824.90' |
| DEV 11 | 923.80' | 828.00' |
| DEV 15 | 1048.60' | 716.00' |

MINE OPENING ELEVATION

| MINE OPENING | ELEVATION |
|--------------|-----------|
| 2 | 835.5' |
| 3 | 811.8' |
| 4 | 815.2' |
| 5 | 820.3' |
| 6 | 820.2' |

SITE LOCATION MAP

SCALE 1" = 1.0 MILES APX.
★ = APPROXIMATE SITE LOCATION

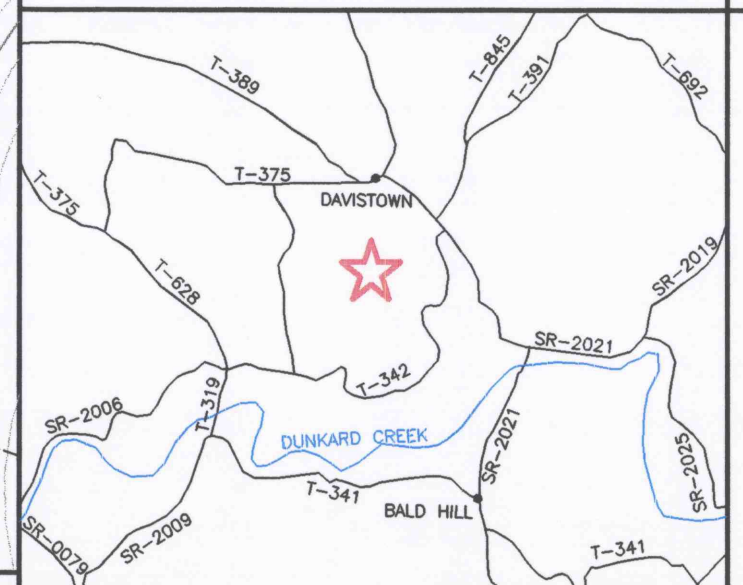

STRIKE and DIP

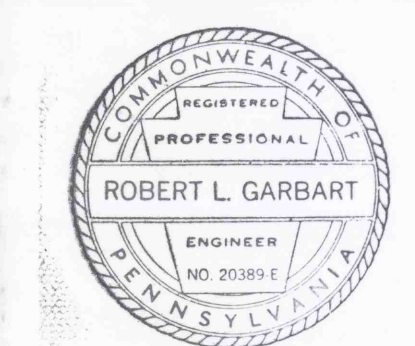
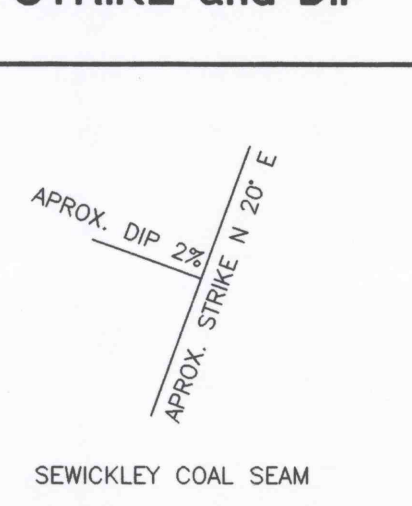

Robert L. Garbart
ROBERT L. GARBART, P.E.

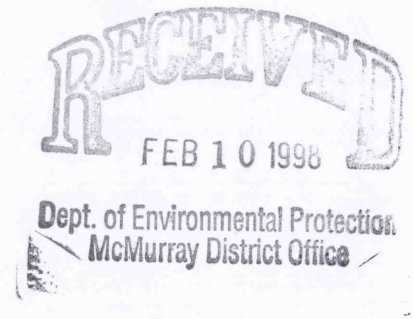

MAP 19-2 ENVIRONMENTAL RESOURCES MAP
FOR
GENESIS, INC. dba MEADOW RUN MINE
IN
DUNKARD TWP., GREENE COUNTY
SCALE : 1" = 500', CONTOUR INTERVAL: 20', WITH 5' IN SURFACE ACTIVITY SITE
MSHA ID #36-07987
CMAP #30871301

Prepared by:
Garbart Engineering Company
PO Box 44, Lemont Furnace, PA 15466
(412) 439 - 1313