

COMBINATION JOY LOADER AND FLIGHT CONVEYOR  
SYSTEM OF MINING AND INDICATIVE COSTS  
SONMAN SHAFT

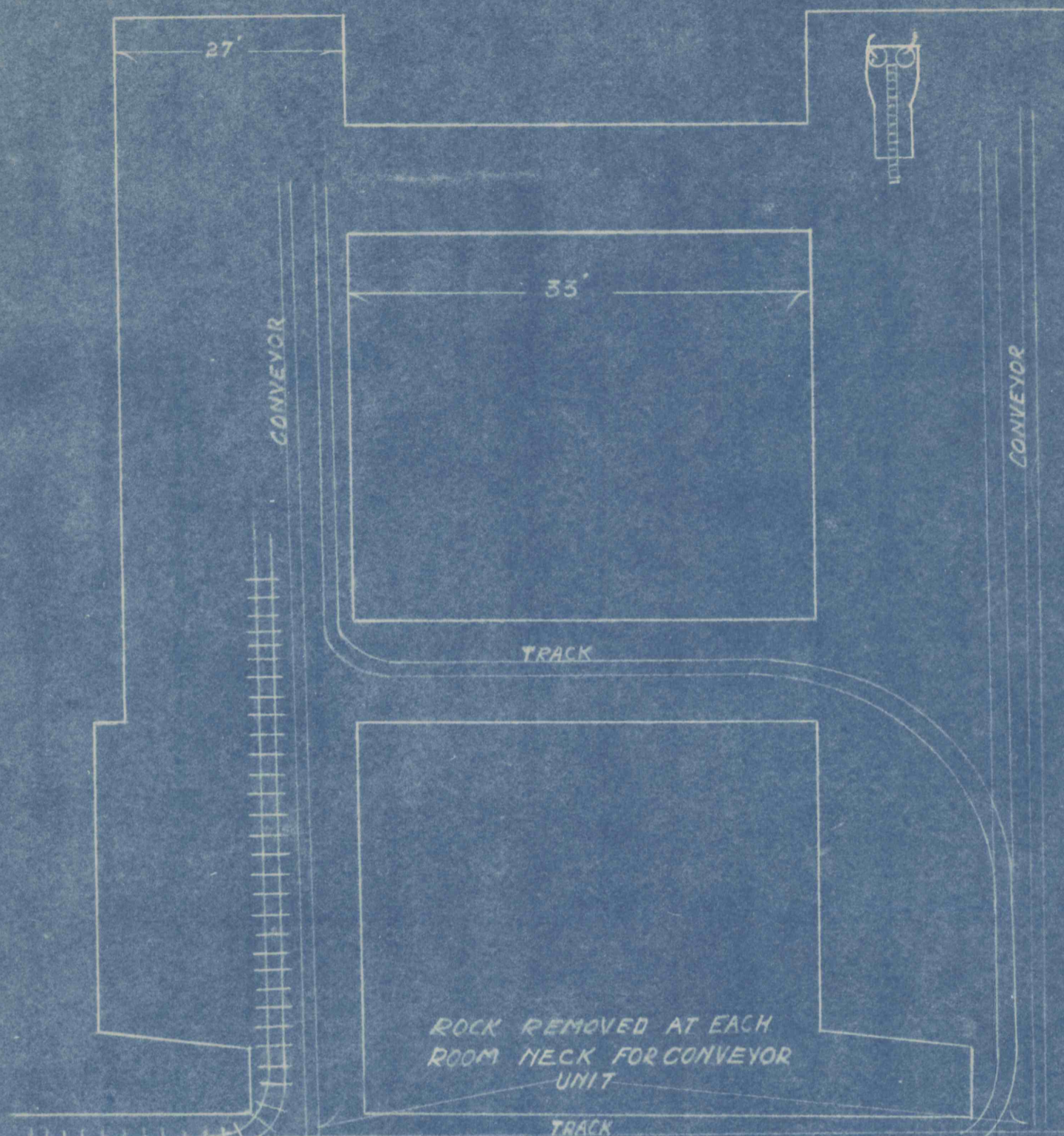

INITIAL INVESTMENT		DEPRECIATE 7 YRS. PER TON	POWER PER TON	EXPLOSIVE PER TON	MAINTENANCE TOTAL MACHS PER TON
LOADING MACHINE	\$10.500	.05	.05	3.5	.02
CONVEYORS	6.000	.058			
LOCOMOTIVE	5.000	.07			INTEREST ON INVEST.
					3.9
TOTALS	21.500	9.8	.05	3.5	24.2

LOADING MACHINE CREW	RATE	TONS PER MACHINE SHIFT AVERAGE	COST PER TON	LUBRICATION PER TON	TOTAL COST PER TON
OPERATOR	6.36	125	.5076	1.6	.7656
HELPER	6.16				
CUTTER	6.36				
HELPER	6.16				
CONVEYOR MAN	5.76				
2-FACE MEN	11.52				
FACE BOSS	8.72				
MOTORMAN	6.36				
SPRAGGER	5.76				
TRACKMAN	6.36				
	69.52				
NOTE: MOTORMAN AND SPRAGGER SERVE TWO MACHINES. DEDUCTION	6.06				

COST OF ROCK REMOVAL AND CHANGE OF SET-UP NOT  
INCLUDED IN ABOVE TABLE

