

E 1733,000

N 453,000

N 452,000

N 451,000

N 450,000

E 1732,000

E 1731,000

E 1730,000

MATCH TO SHEET 3C

MATCH TO SHEET 4B

N 4

N 3

N 2

N 1

18 A

66 T

E 11

E 10

E 9

E 8

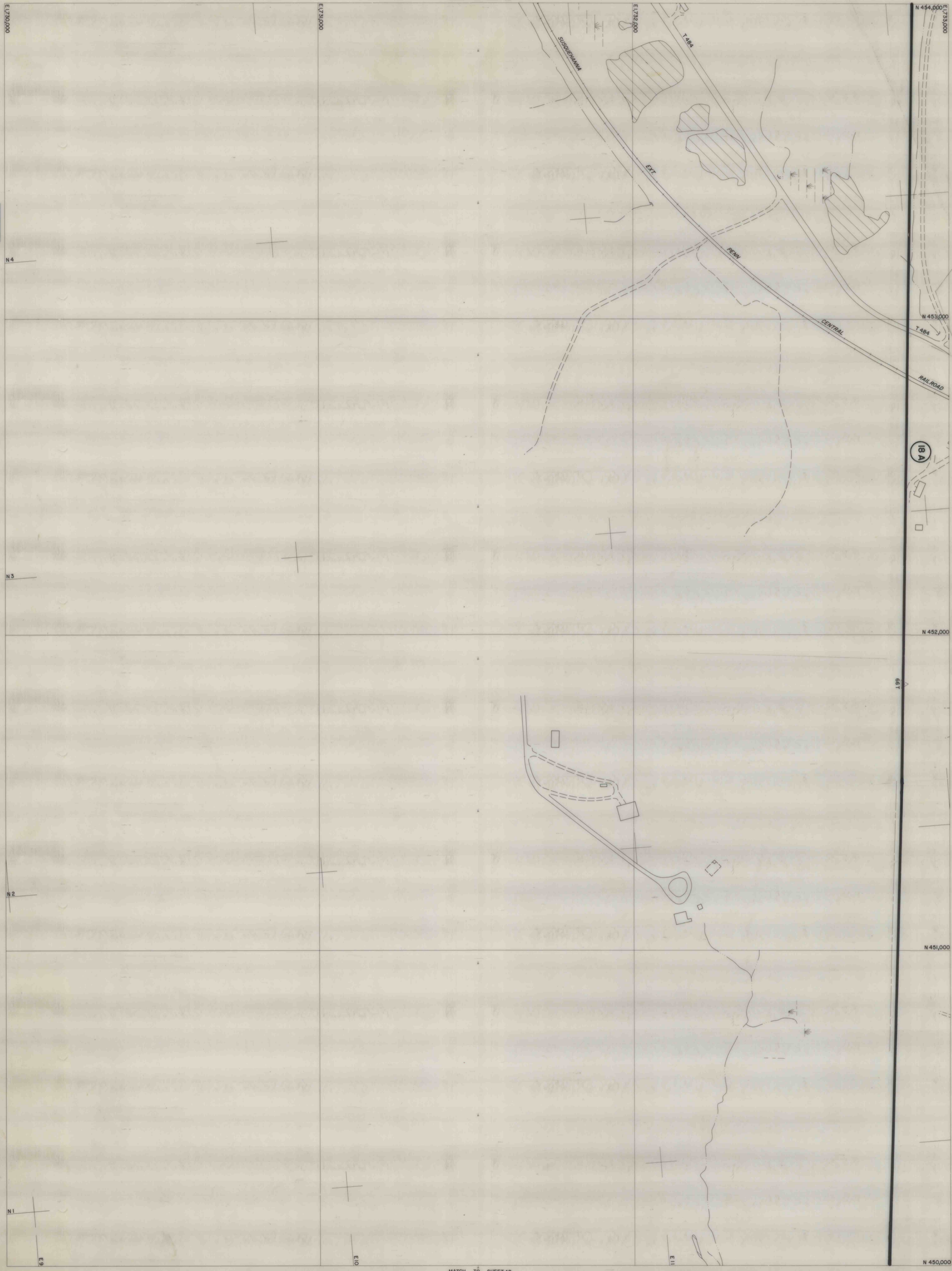

Planimetry compiled from aerial photography taken May, 1975  
 L. Robert Kinball, Consulting Engineer, Ebensburg, Pennsylvania, for  
**BARNES & TUCKER COMPANY**

4421



**BARNES & TUCKER COMPANY**  
**LANCASTER NO. 20 MINE**  
 EAST CARROLL TOWNSHIP, CAMBERA COUNTY, PENNSYLVANIA  
 SCALE 1"=200' DATE JULY, 1975

3B