

NORTH AMERICAN REFRACTORIES CO.

1012 NATIONAL CITY BANK BUILDING
CLEVELAND, OHIO

ENV. No.

SHEET No.

55-3-150

GRAHAM & DICKEY Properties
Penn Twp. C. lfd. Co. Pa.

SCALE 1" = 600'

DATE Feb. 26, 1942

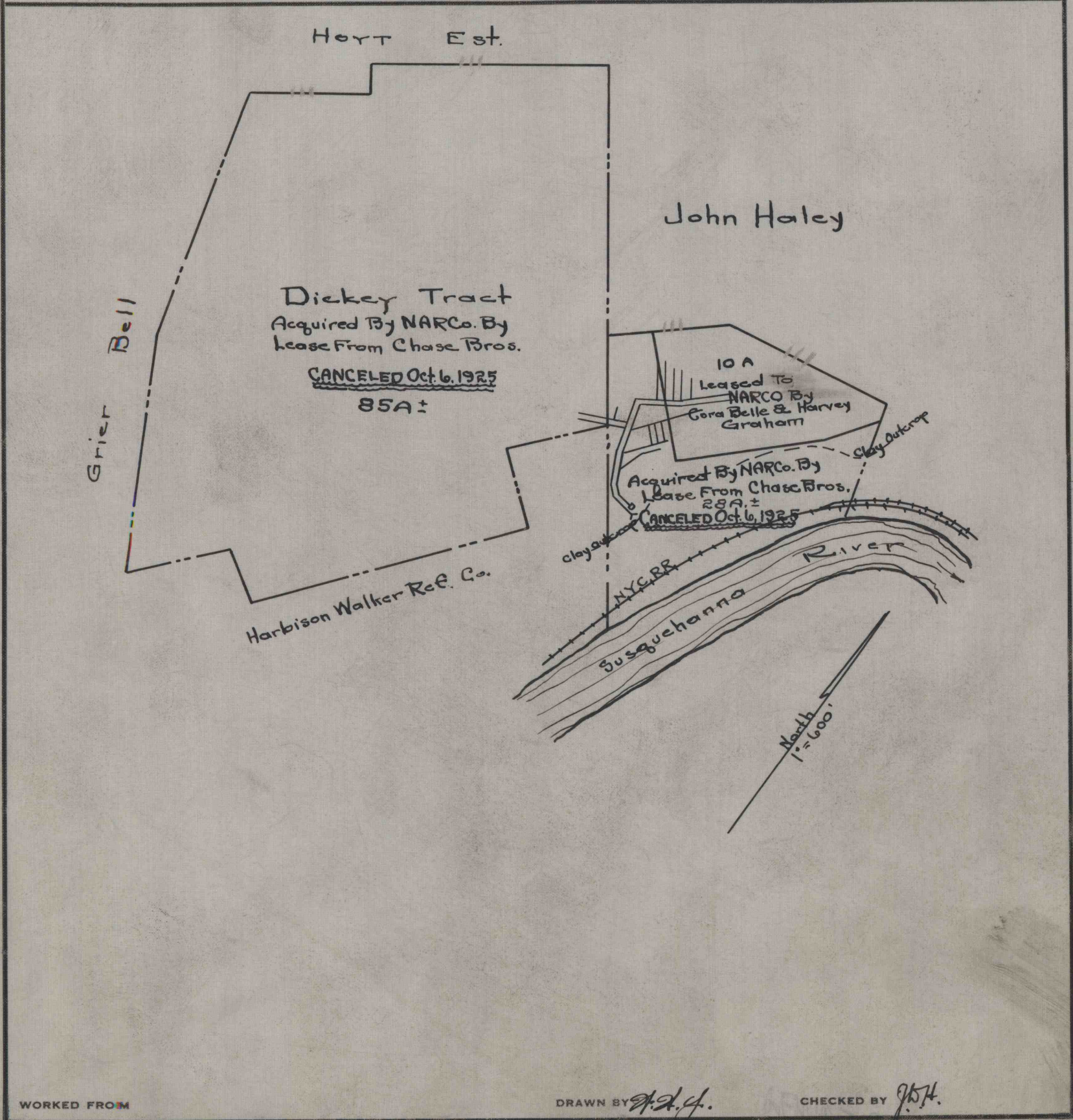

WORKED FROM

DRAWN BY *A.D.G.*

CHECKED BY *J.B.H.*