

10 x 20	200	26 x 15	390	50 x 10	500	10 x 10	100	110 x 15	1650	10 x 30	300	25 x 16	400	140 x 30	4200
26 x 70	1820	50 x 32	1600	8 x 10	80	25 x 30	750	12 x 10	120	8 x 8	64	30 x 24	720	10 x 10	100
30 x 45	1350	10 x 8	80	8 x 25	200	25 x 50	1250	30 x 10	300	45 x 20	900	50 x 30	1500	115 x 24	2760
12 x 12	144	36 x 10	360	50 x 50	2500	80 x 20	1600	16 x 8	128	80 x 20	1600	80 x 10	800	70 x 15	1050
30 x 60	1800	70 x 10	700	30 x 30	900	40 x 30	1200	60 x 10	600	120 x 15	1800	40 x 12	480	36 x 30	1080
15 x 12	180	40 x 8	320	20 x 30	600	30 x 10	300	20 x 12	240	20 x 8	160	40 x 24	960	80 x 24	1920
28 x 80	2240	115 x 20	2300	80 x 25	2000	24 x 15	360	20 x 10	200	76 x 20	1520	110 x 30	3300	12 x 16	192
24 x 80	1720	20 x 10	200	40 x 25	1000	24 x 10	240	35 x 8	280	140 x 20	2800	70 x 30	2100	60 x 10	600
20 x 12	240	16 x 8	128	12 x 16	192	30 x 50	1500	6 x 6	36	10 x 10	100	10 x 10	100	20 x 8	160
10 x 14	140	30 x 45	1350	66 x 20	1320	30 x 70	2100	40 x 20	800	12 x 8	96	50 x 10	500	30 x 10	300
140 x 24	3360	42 x 20	840	16 x 10	160	12 x 30	360	40 x 20	800	40 x 10	400	20 x 12	240	16 x 30	480
20 x 100	2000	15 x 8	120	36 x 20	720	45 x 30	1350	45 x 30	1350	20 x 8	160	20 x 10	200	40 x 10	400
	15394	20 x 10	200	8 x 8	64	45 x 10	450	20 x 10	200	120 x 15	1800	160 x 30	4800	40 x 20	800
		20 x 8	160	40 x 40	1600	40 x 10	400	25 x 20	500	100 x 15	1500	15 x 12	180	50 x 20	1000
		20 x 110	2200	50 x 30	1500	50 x 10	500	44 x 40	1760	50 x 8	400	10 x 10	100	50 x 10	500
		20 x 8	160	36 x 20	720	40 x 10	400		3084		14270		16660		15300
		12 x 8	96	12 x 8	96	20 x 10	200								
		10 x 50	500	10 x 50	500										
			16897												

15300 Sp. Ft.  
 16600  
 14270  
 9084  
 12440  
 16897  
 10808  
 15394  
 9) 110793 Sp. Ft.  
 12310 Sp. Ft.  
 Coal is 3'0" Thick.  
 Hence, 12310 Cu. Yds.  
 or, 12310 Cu. Tons.

D  
 -NEWTON LEE-  
 -MAP SHOWING CALCULATION OF TONS OF-  
 -COAL MOVED-  
 BY  
 CLEARFIELD & CAMBRIA COAL & COKE COMPANY  
 FROM  
 DRIFTS Nos 2 & 1.  
 CLEARFIELD, PENN.  
 SCALE 1"=40'  
 E. W. HESS  
 ENGR.

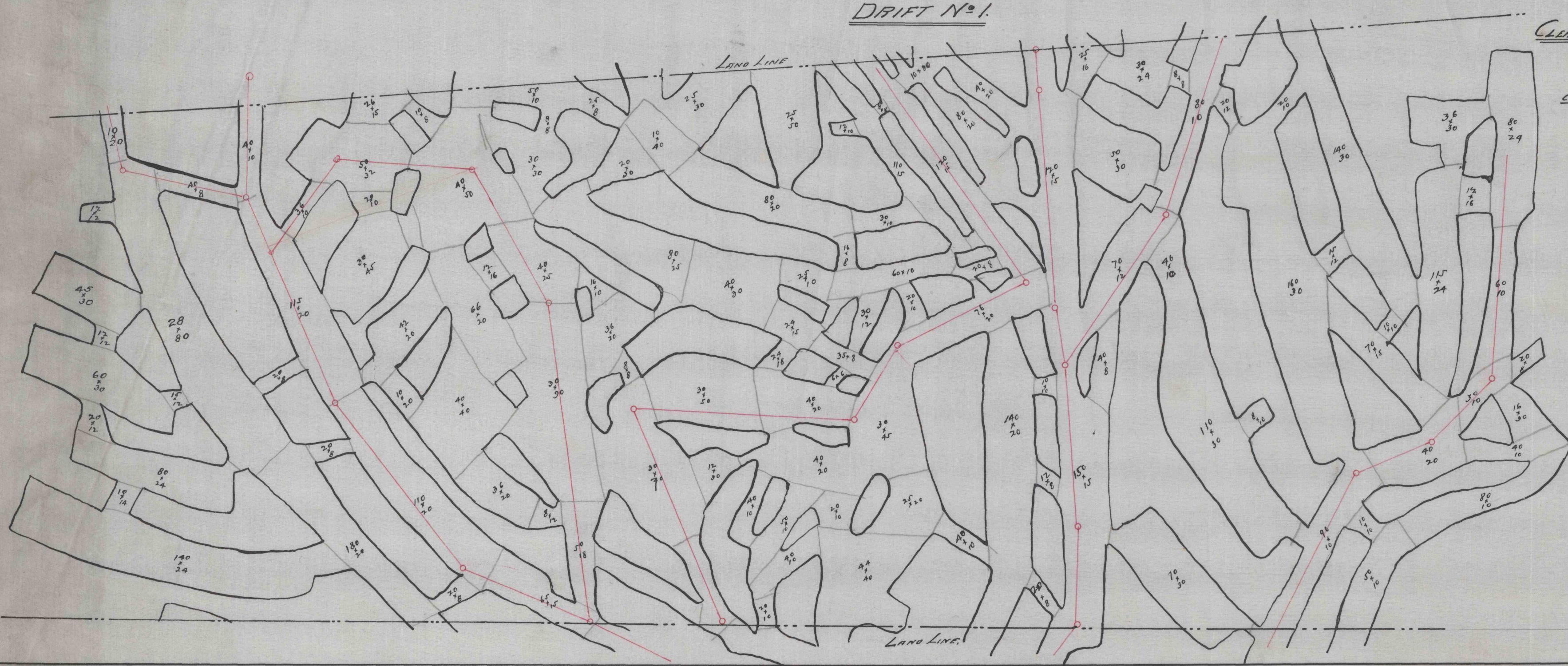

12 x 12	144	40 x 15	600	40 x 20	800
12 x 10	120	20 x 12	240	130 x 25	3250
140 x 30	4200	10 x 10	100	54 x 9	486
50 x 14	700	10 x 20	200	40 x 9	360
20 x 10	200	150 x 16	2400	180 x 9	1620
90 x 14	1260	30 x 10	300	12 x 10	120
50 x 9	450	18 x 20	360	140 x 9	1260
50 x 10	500	20 x 10	200		7896
30 x 10	300	50 x 30	1500		
130 x 9	1170	10 x 20	200		
	9045	30 x 15	450		
		45 x 15	675		
		10 x 10	100		
		40 x 20	800		
			8125		

7896 Sp. Ft.  
 8125  
 9045  
 9) 25070  
 2673 Sp. Ft.  
 Coal is 3'0" Thick.  
 Hence, 2673 Cu. Yds.  
 or, 2673 Cu. Tons.

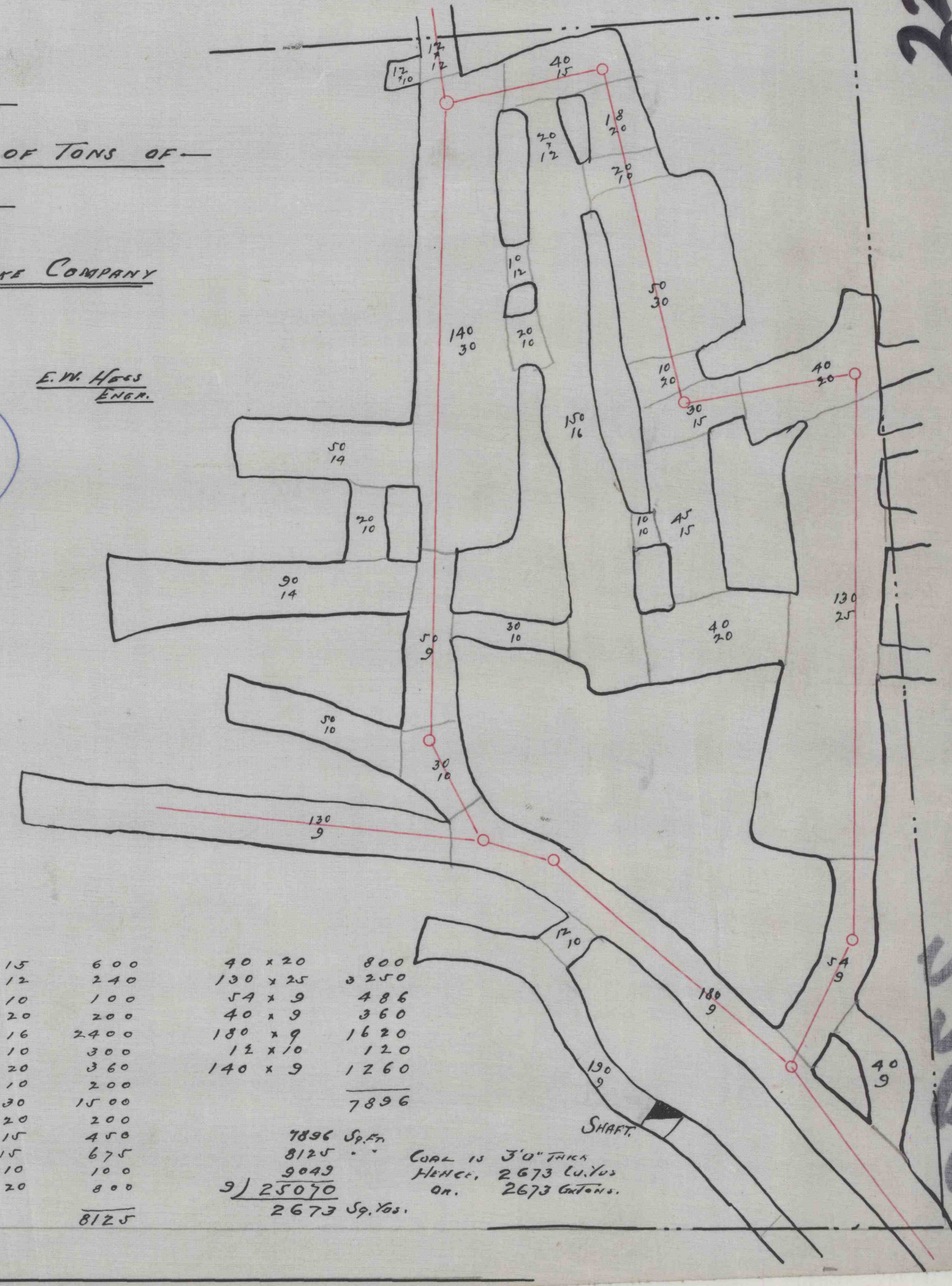

3392

3395