

D.M. No. 1 Towns  
Sub. 1583.9  
Dep. Cont. - 1493.9

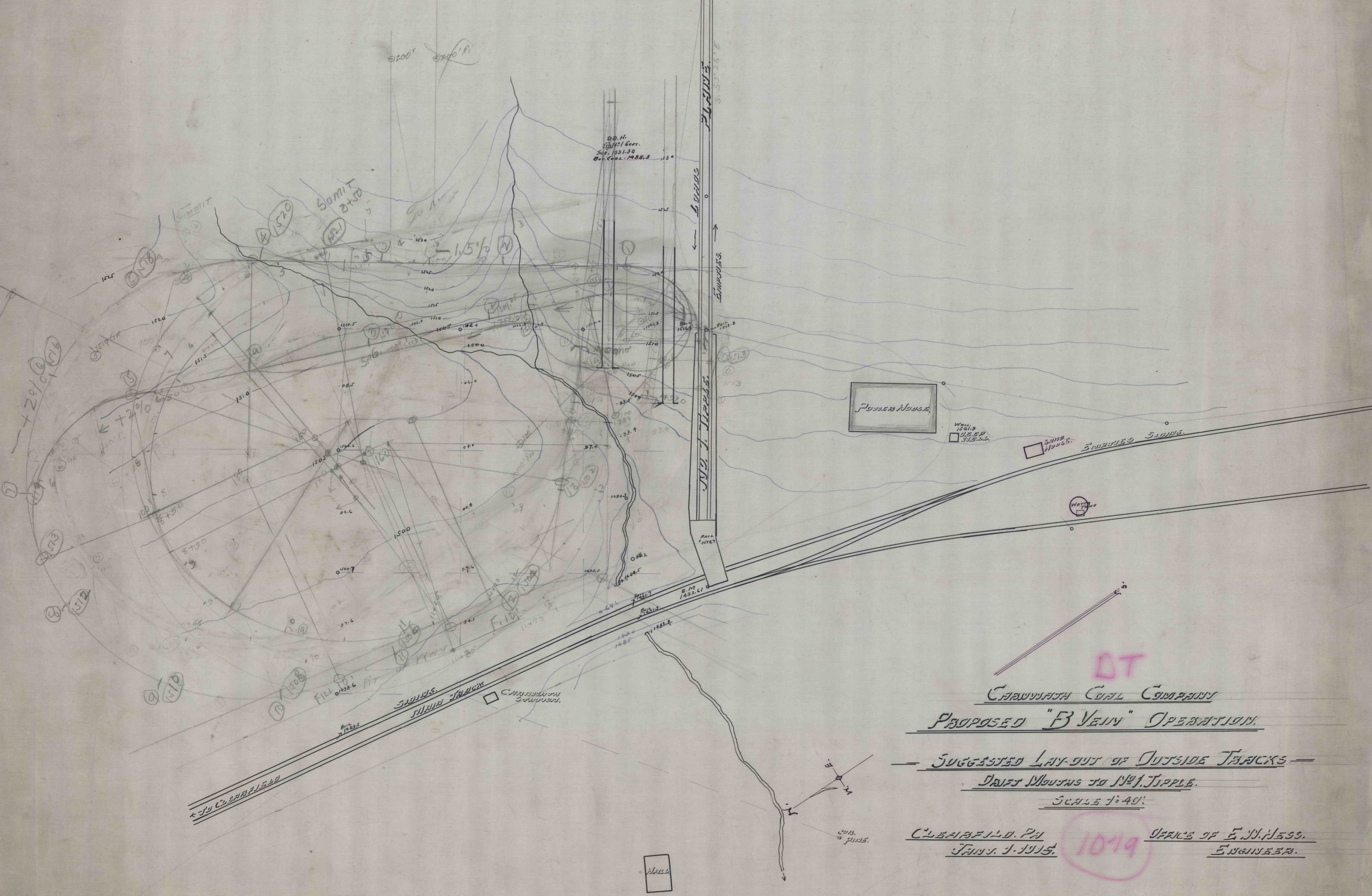

DT  
CRAWFORD COAL COMPANY  
PROPOSED "B VEIN" OPERATION.

SUGGESTED LAY-OUT OF OUTSIDE TRACKS  
DAVEY MOUNTAIN TO NEW J. TRIPLE.  
SCALE 1"=40'

CRAWFORD, PA  
JAN. 1-1915  
OFFICE OF E.S. HESS,  
ENGINEER.

1049

TOPS

2964