

NOTES
 1. THE CULTURAL DATA PRESENTED ON THIS MAP HAS BEEN FIELD CHECKED AND CORRECTED RELATIVE TO THAT ON THE U.S.G.S. TOPOGRAPHIC BASE MAP.
 2. PROPERTY LINES AND OWNERS ARE BASED UPON CURRENT COUNTY TAX ASSESSMENT MAPS, UNLESS DETERMINED BY FIELD SURVEY.

- LEGEND**
- AREA AFFECTED
 - PROPERTY LINES
 - UTILITY LINES
 - GAS LINES
 - SURFACE MINE
 - DEEP MINE PORTAL
 - DEEP MINE EXTENT
 - COAL OUTCROP
 - SLOPE MEASUREMENT

- GROUNDWATER DATA**
- LOCAL
 - REGIONAL
 - SEEP, WELL, SPRING
 - BACKGROUND
 - WATER SAMPLE
 - MONITORING WATER SAMPLE
 - PROPERTY OWNERSHIP KEY
 - GEOLOGIC CROSS-SECTION
 - MINE WORKINGS
 - DEEP MINE
 - SURFACE MINE
 - TESTHOLE

DRILL HOLE INFORMATION

TESTHOLE NO.	SURFACE ELEV.	BASE OF COAL ELEVATION	COAL SEAM
TH-1	1799	1767.10'	UPPER KITTANNING
TH-2	1805	1762.10'	UPPER KITTANNING
TH-3	1810	1762.9"	UPPER KITTANNING
TH-4	1829	1772.3"	UPPER KITTANNING
TH-5	1823	1773.8"	UPPER KITTANNING
TH-9	1822	1768.5"	UPPER KITTANNING
TH-10	1805	1766.8"	UPPER KITTANNING
TH-11	1809	1781.2"	UPPER KITTANNING
TH-12	1808	1782.3"	UPPER KITTANNING
TH-13	1794	1776.3"	UPPER KITTANNING
TH-14	1817	1767.8"	UPPER KITTANNING
TH-15	1786	1761.4"	UPPER KITTANNING
TH-16	1776	1761.1"	UPPER KITTANNING
TH-17	1782	1759.2"	UPPER KITTANNING
TH-18	1772	1758.5"	UPPER KITTANNING
TH-19	1777	1760.2"	UPPER KITTANNING
TH-20	1782	1773.2"	UPPER KITTANNING
TH-21	1786	1769.5"	UPPER KITTANNING
TH-22	1789	1775.2"	UPPER KITTANNING

- SMALL TRACT LANDOWNERS**
12. RONALD DELP
 13. GENE BRITTON
 15. LEROY SHUGAR (PARCEL 1)
 17. LEROY SHUGAR (PARCEL 2)
 19. ROBERT TREGONING
 25. RICHARD DELIA
 26. ROCKWOOD ENERGY MINERAL CORP.
 27. IEVIN GIBSON
 29. LAWRENCE CALHOUN
 31. CORA WILSON
 3. LESTER ROBINSON
 4. ROBERT LONG
 5. NATIONAL FUEL GAS SUPPLY CORP.
 6. DANNY REYNOLDS
 7. DAVID SEVIN, JR.
 8. Wm. MODRE
 9. TERRY FELT

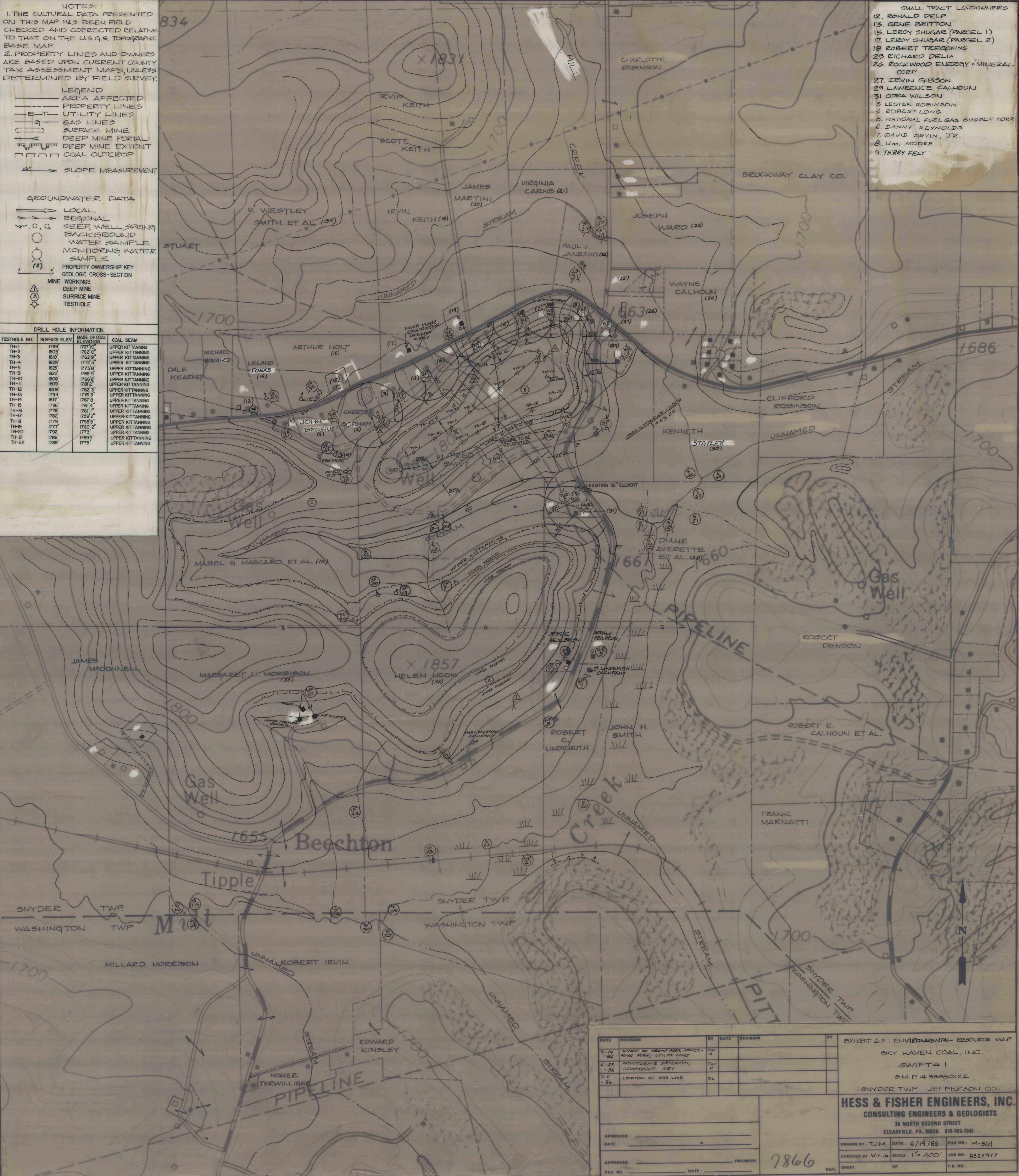

DATE	REVISION	BY	DATE	REVISION	BY
3-19-84	EXTENT OF PERMIT AREA, MONITORING PLAN, UTILITY LINES	TJ			
4-23-85	MONITORING PROGRAM, OWNERSHIP KEY	TJ			
7-11-84	LOCATION OF GAS LINE	DL			

APPROVED: _____ DATE: _____ ENGINEER: _____

REG. NO. _____ DATE: _____

EXHIBIT G.2: ENVIRONMENTAL RESOURCE MAP
 SKY HAVEN COAL, INC.
 SWIFT # 1
 S.M.P. # 33850122
 SNYDER TWP. JEFFERSON CO.

HESS & FISHER ENGINEERS, INC.
 CONSULTING ENGINEERS & GEOLOGISTS
 36 NORTH SECOND STREET
 CLEARFIELD, PA. 16830 814-765-7541

DRAWN BY: T.J.M. DATE: 6/19/85 FILE NO.: M-361
 CHECKED BY: W.F. Jr. SCALE: 1" = 400' JOB NO.: 8522977
 REG. NO. _____ DATE: _____ ENGINEER: _____ SHEET _____ OF _____ P.B. NO. _____

7866