

LEASEHOLD OF THE PENNA. COAL & COKE CORP.

LEASEHOLD OF THE PENNA. COAL & COKE CORP.

ALTOONA COAL & COKE CO.

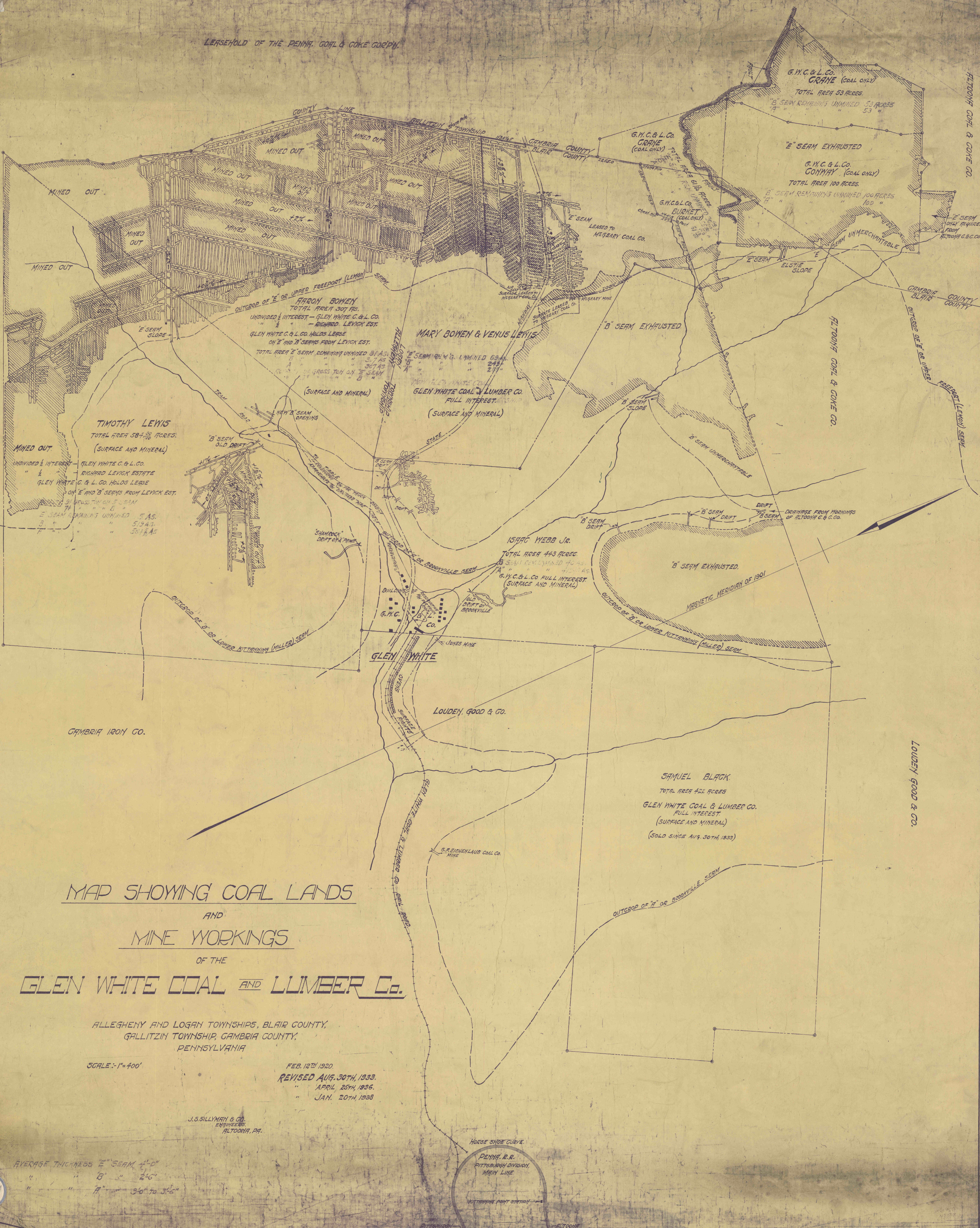

MAP SHOWING COAL LANDS

AND MINE WORKINGS

OF THE GLEN WHITE COAL AND LUMBER Co.

ALLEGHENY AND LOGAN TOWNSHIPS, BLAIR COUNTY,
GALLITZIN TOWNSHIP, GAMBRIA COUNTY,
PENNSYLVANIA

SCALE: 1"=400'

FEB. 12TH 1920.
REVISED AUG. 30TH 1933.
" APRIL 25TH 1936.
" JAN. 20TH 1938

J.S. SILLIMAN & CO.
ENGINEERS
ALTOONA, PA.

AVERAGE THICKNESS E SEAM 4'-0"
 " " B " 2'-6"
 " " A " 3'-0" to 3'-6"

