

# Gumbert Hill

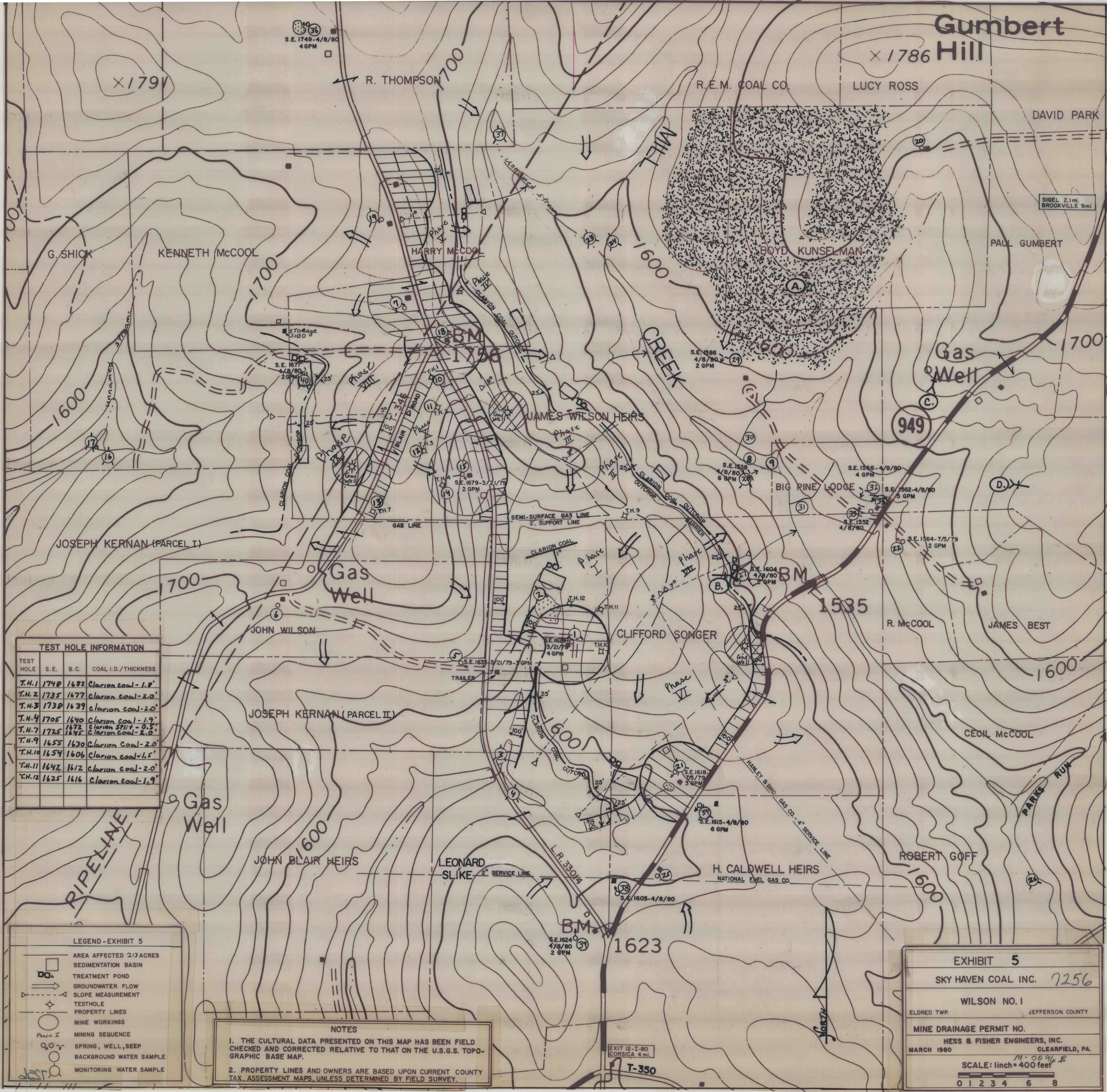

TEST HOLE INFORMATION			
TEST HOLE	S.E.	B.C.	COAL I.D./THICKNESS
T.H.1	1749	1682	Clarion coal-1.9'
T.H.2	1735	1677	Clarion coal-2.0'
T.H.3	1739	1639	Clarion coal-2.0'
T.H.4	1705	1640	Clarion coal-1.9'
T.H.7	1725	1672	Clarion SPH+ - 0.5'
T.H.7	1725	1645	Clarion coal-2.0'
T.H.9	1655	1630	Clarion coal-2.0'
T.H.10	1654	1606	Clarion coal-1.5'
T.H.11	1642	1612	Clarion coal-2.0'
T.H.12	1625	1616	Clarion coal-1.9'

LEGEND - EXHIBIT 5	
	AREA AFFECTED 2/3 ACRES
	SEDIMENTATION BASIN
	TREATMENT POND
	GROUNDWATER FLOW
	SLOPE MEASUREMENT
	TESTHOLE
	PROPERTY LINES
	MINE WORKINGS
	MINING SEQUENCE
	SPRING, WELL, SEEP
	BACKGROUND WATER SAMPLE
	MONITORING WATER SAMPLE

**NOTES**

1. THE CULTURAL DATA PRESENTED ON THIS MAP HAS BEEN FIELD CHECKED AND CORRECTED RELATIVE TO THAT ON THE U.S.G.S. TOPOGRAPHIC BASE MAP.
2. PROPERTY LINES AND OWNERS ARE BASED UPON CURRENT COUNTY TAX ASSESSMENT MAPS, UNLESS DETERMINED BY FIELD SURVEY.

<b>EXHIBIT 5</b>	
SKY HAVEN COAL INC.	7256
WILSON NO. 1	
ELDRED TWP.	JEFFERSON COUNTY
MINE DRAINAGE PERMIT NO.	
HESS & FISHER ENGINEERS, INC.	
MARCH 1980	CLEARFIELD, PA.
SCALE: 1 inch = 400 feet	
0 1 2 3 4 6 8	