

BONDING INCREMENT CHART		
MINING PERMIT NO.	ACRES	STATUS
100032-24840102	9.4 19.9	SUPPORT MINING

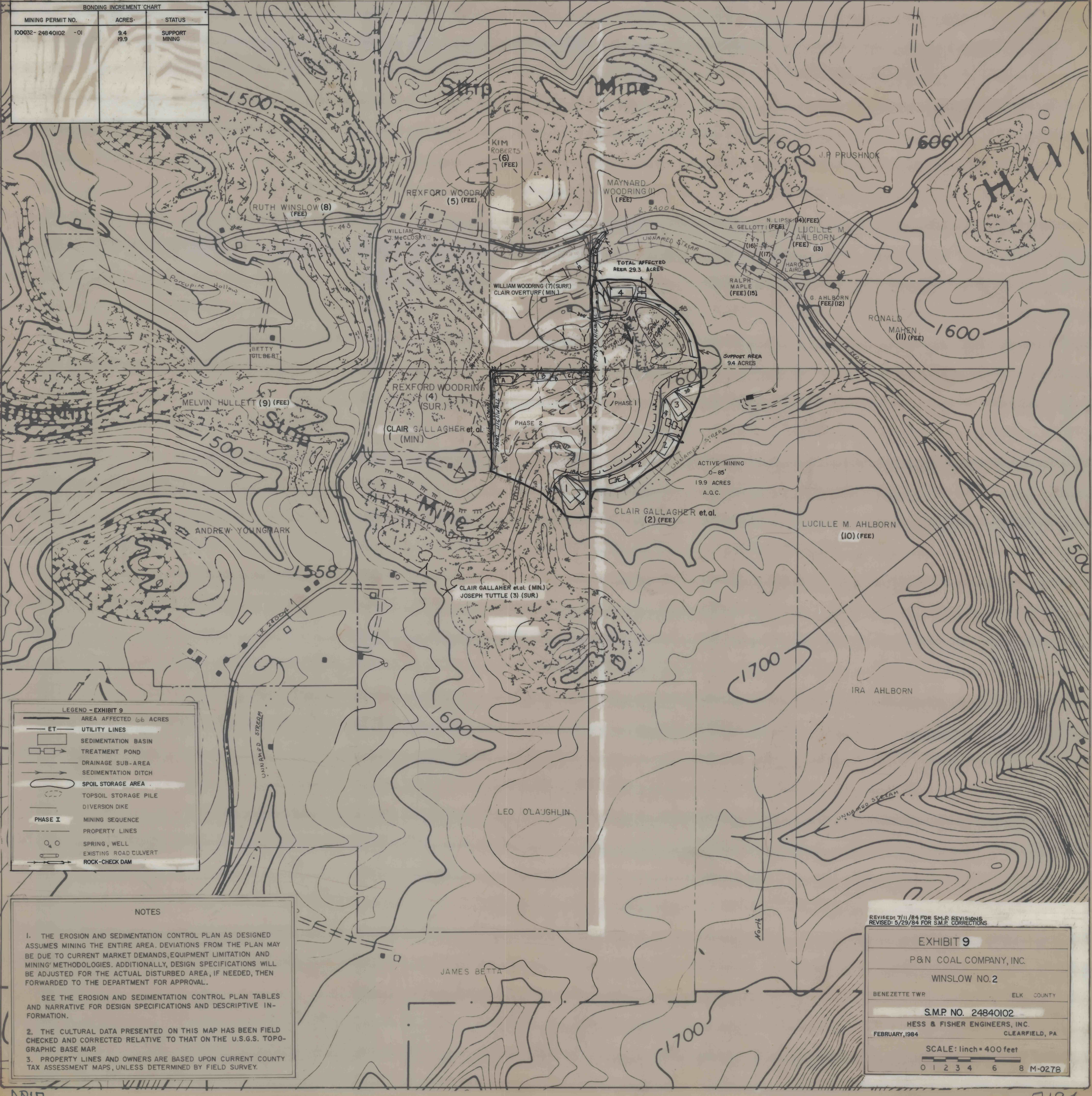

LEGEND - EXHIBIT 9	
	AREA AFFECTED 66 ACRES
	UTILITY LINES
	SEDIMENTATION BASIN
	TREATMENT POND
	DRAINAGE SUB-AREA
	SEDIMENTATION DITCH
	SPOIL STORAGE AREA
	TOPSOIL STORAGE PILE
	DIVERSION DIKE
	PHASE I MINING SEQUENCE
	PROPERTY LINES
	SPRING, WELL
	EXISTING ROAD CULVERT
	ROCK-CHECK DAM

**NOTES**

1. THE EROSION AND SEDIMENTATION CONTROL PLAN AS DESIGNED ASSUMES MINING THE ENTIRE AREA. DEVIATIONS FROM THE PLAN MAY BE DUE TO CURRENT MARKET DEMANDS, EQUIPMENT LIMITATION AND MINING METHODOLOGIES. ADDITIONALLY, DESIGN SPECIFICATIONS WILL BE ADJUSTED FOR THE ACTUAL DISTURBED AREA, IF NEEDED, THEN FORWARDED TO THE DEPARTMENT FOR APPROVAL.
2. SEE THE EROSION AND SEDIMENTATION CONTROL PLAN TABLES AND NARRATIVE FOR DESIGN SPECIFICATIONS AND DESCRIPTIVE INFORMATION.
3. THE CULTURAL DATA PRESENTED ON THIS MAP HAS BEEN FIELD CHECKED AND CORRECTED RELATIVE TO THAT ON THE U.S.G.S. TOPOGRAPHIC BASE MAP.
4. PROPERTY LINES AND OWNERS ARE BASED UPON CURRENT COUNTY TAX ASSESSMENT MAPS, UNLESS DETERMINED BY FIELD SURVEY.

REVISED: 7/11/84 FOR S.M.P. REVISIONS  
REVISED: 5/29/84 FOR S.M.P. CORRECTIONS

**EXHIBIT 9**

P&N COAL COMPANY, INC.

WINSLOW NO. 2

BENEZETTE TWP ELK COUNTY

S.M.P. NO. 24840102

HESS & FISHER ENGINEERS, INC.  
FEBRUARY, 1984 CLEARFIELD, PA.

SCALE: 1 inch = 400 feet

0 1 2 3 4 6 8 M-0278

APIP

7194