

BONDING INCREMENTS	ACERAGE	STATUS
100032-1780003-01-0	24.0	ACTIVE
101875-1780300-01	26.8	PENDING

BONDING STATUS LEGEND	
[Pattern]	0'-85' MINERAL AREA
[Pattern]	86'-115' MINERAL AREA
[Pattern]	SUPPORT AREA
[Pattern]	STAGE I FILED
[Pattern]	STAGE I RELEASED
[Pattern]	STAGE II FILED
[Pattern]	STAGE II RELEASED
[Pattern]	STAGE III FILED
[Pattern]	STAGE III RELEASED
[Pattern]	DELETED

LEGEND	
[Symbol]	SEED MIXTURES
[Symbol]	AREA AFFECTED 146.4 ACRES
[Symbol]	PROPERTY LINES
[Symbol]	PROPOSED MINING SEQUENCE
[Symbol]	WELLS & SPRINGS
[Symbol]	STREAM & ROAD BARRIERS (100 feet)
[Symbol]	GAS WELL BARRIER (125 feet)
[Symbol]	SEDIMENTATION BASIN
[Symbol]	TREATMENT PONDS
[Symbol]	SEDIMENTATION DITCH
[Symbol]	UPSLOPE DIVERSION DITCH
[Symbol]	EROSION CONTROL DIKE
[Symbol]	PRIME FARMLAND SOILS
[Symbol]	TOPSOIL STORAGE AREA
[Symbol]	DRAINAGE SUBAREA
[Symbol]	AREAL EXTENT OF SURFACE MINING
[Symbol]	SPOIL STORAGE AREA
[Symbol]	UTILITY LINES
[Symbol]	PROPERTY OWNERSHIP KEY (KEYED TO MODULE 5)
[Symbol]	ROCK CHECK DAMS

NOTES:
 1. THE EROSION AND SEDIMENTATION CONTROL PLAN AS DESIGNED ASSUMES MINING THE ENTIRE AREA. DEVIATIONS FROM THE PLAN MAY BE DUE TO CURRENT MARKET DEMANDS, EQUIPMENT LIMITATION AND MINING METHODOLOGIES. ADDITIONALLY, DESIGN SPECIFICATIONS WILL BE ADJUSTED FOR THE ACTUAL DISTURBED AREA, IF NEEDED, THEN FORWARDED TO THE DEPARTMENT FOR APPROVAL. (SEE THE EROSION AND SEDIMENTATION CONTROL PLAN TABLES AND NARRATIVE FOR DESIGN SPECIFICATIONS AND DESCRIPTIVE INFORMATION.)
 2. THE CULTURAL DATA PRESENTED ON THIS MAP HAS BEEN FIELD CHECKED AND CORRECTED RELATIVE TO THAT ON THE U.S.G.S. TOPOGRAPHIC BASE MAP.
 3. PROPERTY LINES AND OWNERS ARE BASED UPON CURRENT COUNTY TAX ASSESSMENT MAPS, UNLESS DETERMINED BY FIELD SURVEY.

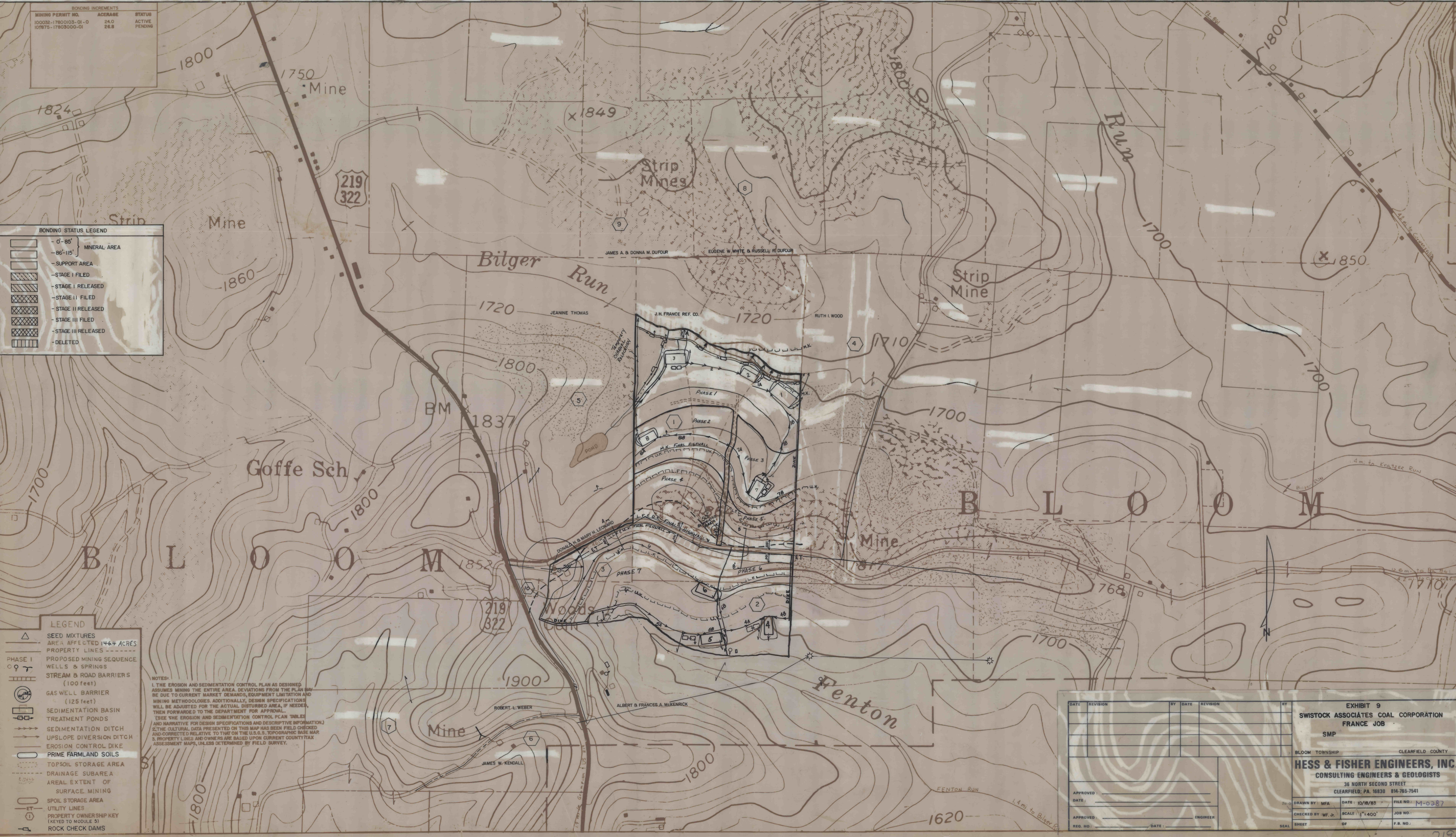

DATE	REVISION	BY	DATE	REVISION	BY

APPROVED: _____		DATE: _____		ENGINEER: _____	
CHECKED BY: W.F.J.		SCALE: 1"=400'		JOB NO.: _____	
REG. NO. _____	DATE: _____	SEAL SHEET _____	OF _____	F.B. NO. _____	

EXHIBIT 9		
SWISTOCK ASSOCIATES COAL CORPORATION		
FRANCE JOB		
SMP		
BLOOM TOWNSHIP	CLEARFIELD COUNTY	
HESS & FISHER ENGINEERS & GEOLOGISTS, INC.		
CONSULTING ENGINEERS & GEOLOGISTS		
36 NORTH SECOND STREET		
CLEARFIELD, PA. 16830 814-765-7541		
DRAWN BY: MFA	DATE: 10/18/83	FILE NO.: M-0287
CHECKED BY: W.F.J.	SCALE: 1"=400'	JOB NO.: _____
REG. NO. _____	DATE: _____	SEAL SHEET _____
OF _____	F.B. NO. _____	