

2080
X

NEW SHAWMUT MINING CO. FEE

NEW SHAWMUT MINING CO. Min.

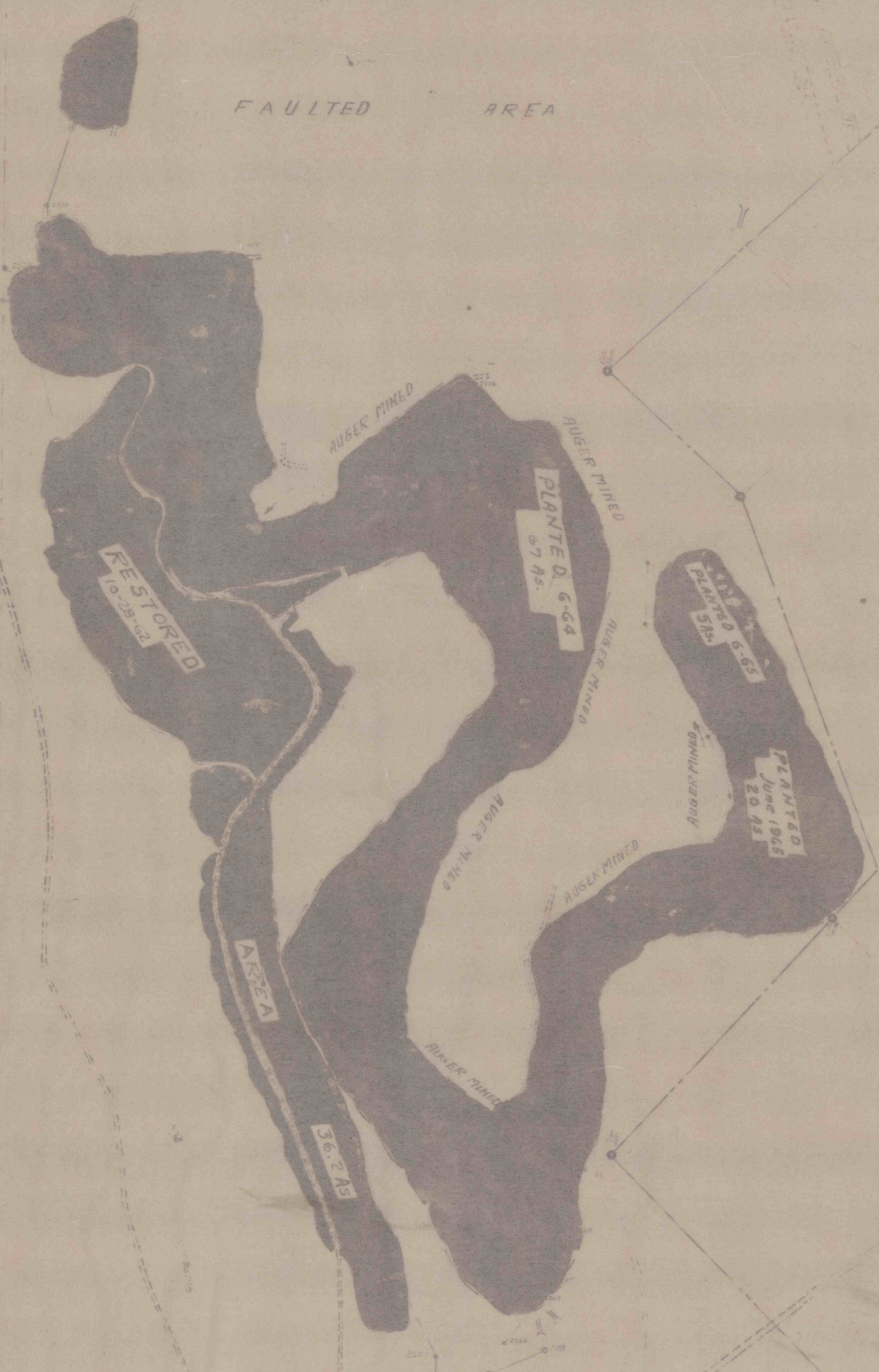
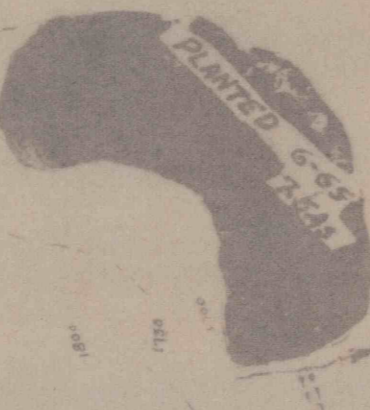

FAULTED AREA

FAULTED AREA

NORTHWESTERN MINING & EXCHANGE CO.
FEE
1061.92

NORTHWESTERN MINING & EX. CO. Min.

LESLIE BODEROCO Surf

43.11 AS

NORTHWESTERN MINING & EX. CO. Min.

LESLIE BODEROCO Surf

63.11 AS

FRANK J. FRANCISCO Surf

2.00 AS
2.00 AS
2.00 AS
2.00 AS

EDWARD KOSCIUSKO Surf

JOE R. DUNBARCO Min

89 AS

JOE R. DUNBARCO FEE

2.00 AS
2.00 AS
2.00 AS
2.00 AS

GEORGE & ROSEMARIE MORELLI Surf

2.00 AS
2.00 AS

NORTHWESTERN MINING & EX. CO. Min.

JOHN CUNEO Surf

NORTHWESTERN MINING & EX. CO. Min.

NORTHWESTERN MINING & EX. CO. Min.

NEW SHAWMUT MINING CO. Min.

LOUIS STARR Sr. Fee

BLUSEA COAL COMPANY
NO. 1 STRIP MINE

HORTON TWP ELK CO.

Scale 1" = 400' Oct. 28-60

Surveyed by *Eric Wilson* Reg. Eng.

Revised July 30, 1963
" Oct. 1, 1963
" Jan 1, 1964
" June 15, 1964
" Jan 1, 1965

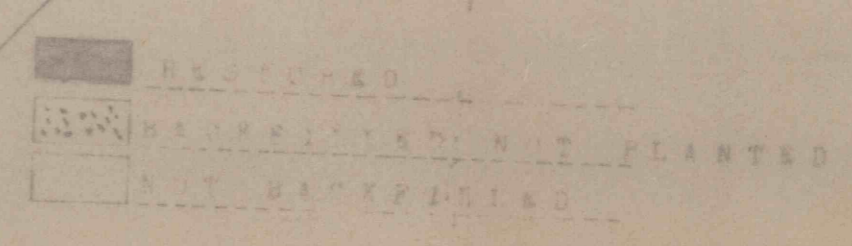

6566