

MRS. ADDIE M. HIPPS  
132.11 A's.

J. S. McQUOWN  
Clay Lease  
18 A's.  
Proposed Drift  
by Harbison-Walker

EDWARD KIRK  
119.38 A's.

JOSEPH KIRK  
80.89 A's

GEO. S. GOOD  
FIRE BRICK Co.  
Plant

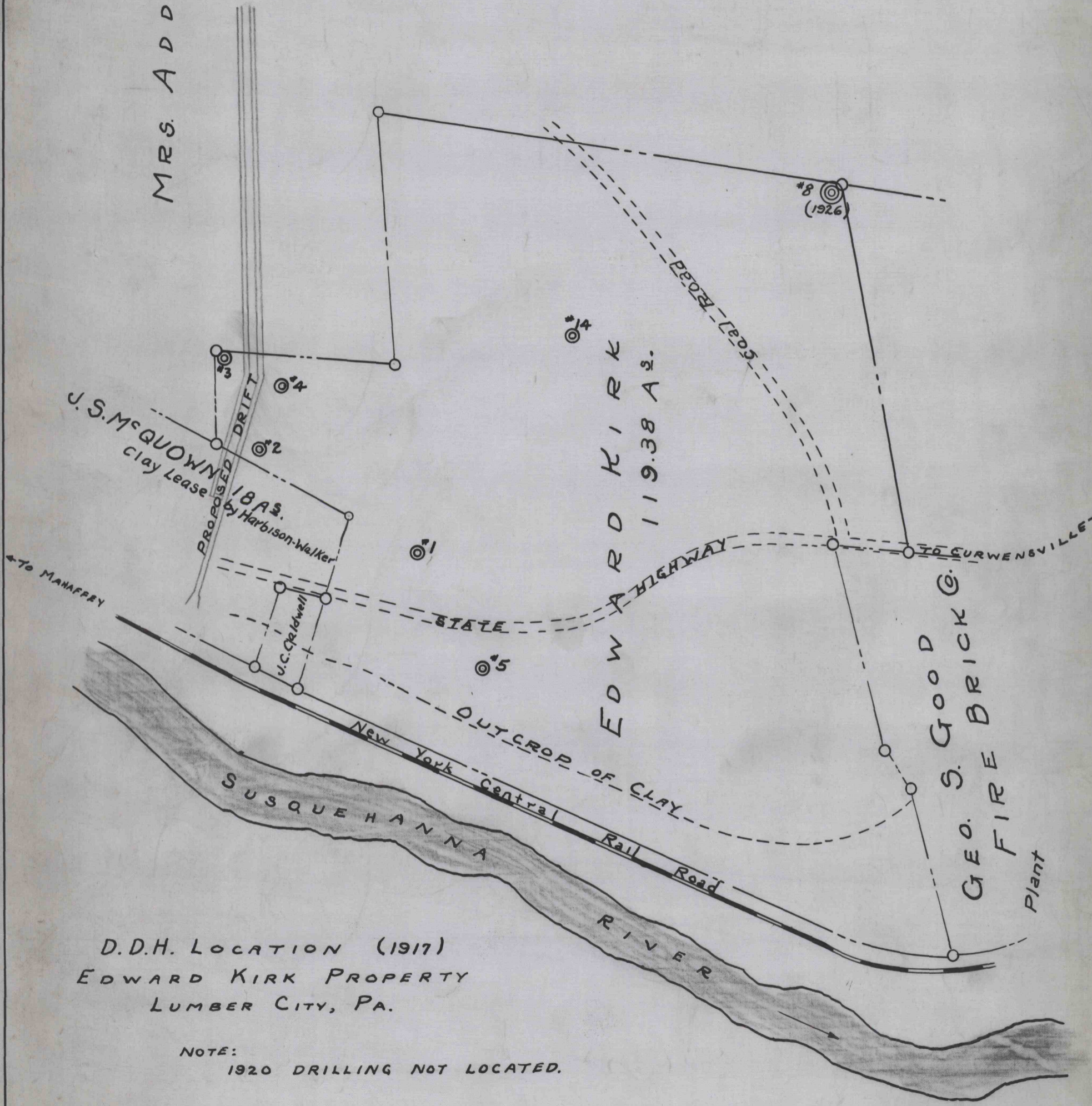

D.D.H. LOCATION (1917)  
EDWARD KIRK PROPERTY  
LUMBER CITY, PA.

NOTE:  
1920 DRILLING NOT LOCATED.