

2015

2015

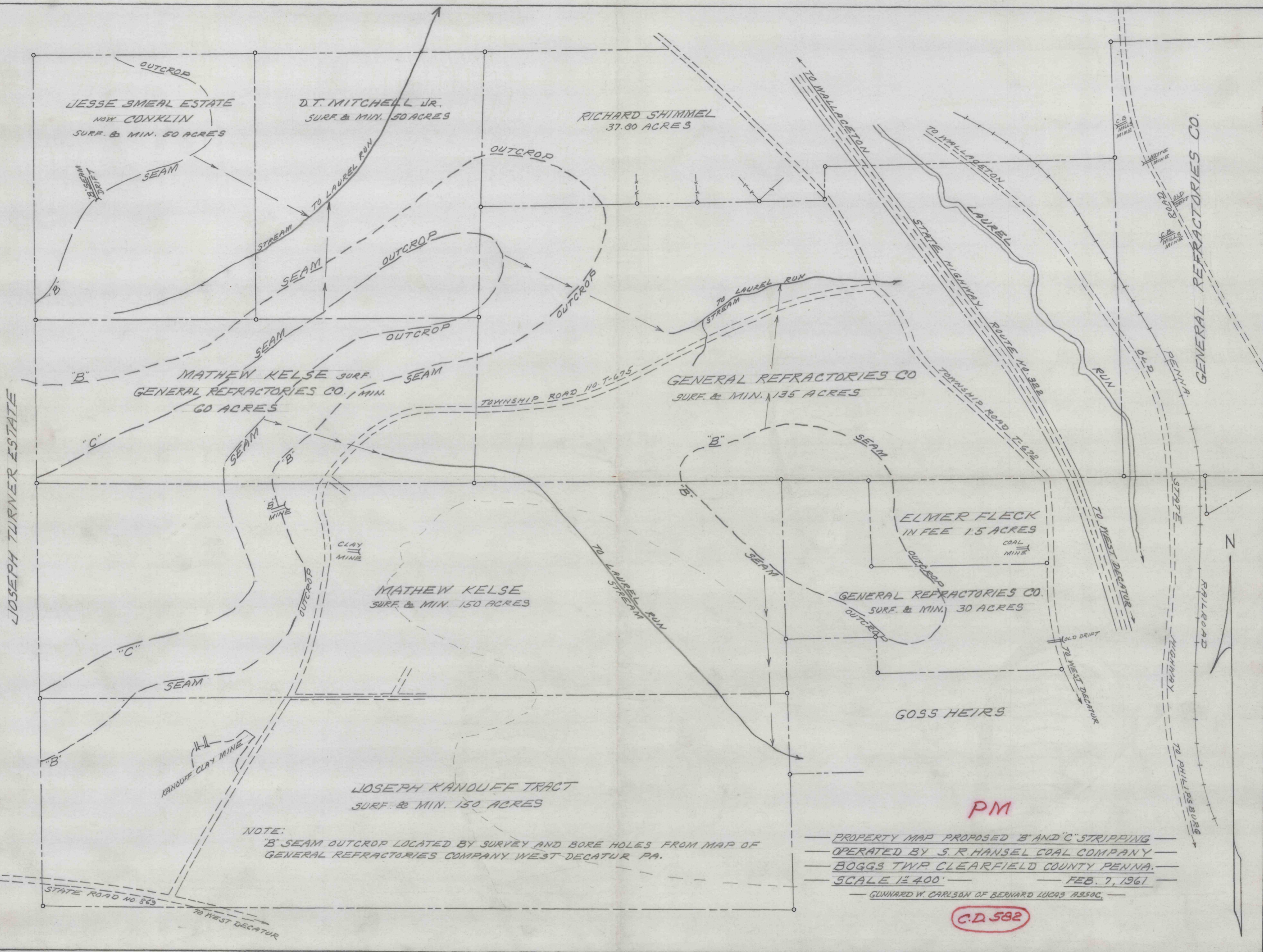

NOTE:
 'B' SEAM OUTCROP LOCATED BY SURVEY AND BORE HOLES FROM MAP OF
 GENERAL REFRACTORIES COMPANY WEST DECATUR PA.

— PROPERTY MAP PROPOSED 'B' AND 'C' STRIPPING —
 — OPERATED BY S. R. HANSEL COAL COMPANY —
 — BOGGS TWP. CLEARFIELD COUNTY PENNA. —
 — SCALE 1" = 400' — FEB. 7, 1961 —
 — GUNNARD W. CARLSON OF BERNARD LUCAS ASSOC. —

C.D. 582

PM