

1065

1065

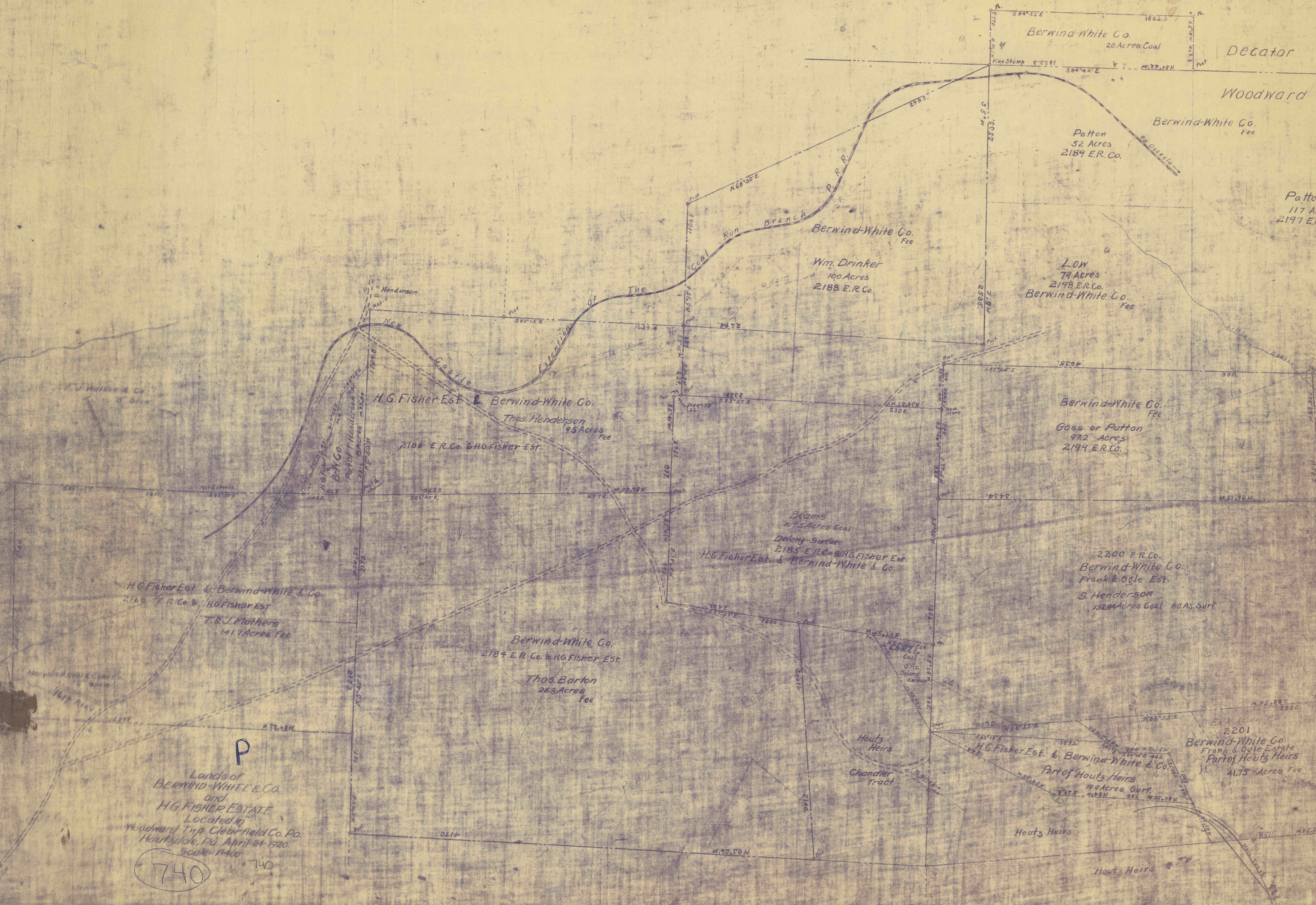

P
 Lands of
 BERWIND-WHITE & Co.
 and
 H.G. FISHER ESTATE
 Located in
 Woodward Twp. Clearfield Co. Pa.
 Houtzdale, Pa. April 24 1920.
 Scale - 1"=400'

740

Decator Town

Woodward Town

Berwind-White Co.
20 Acres Coal

Patton
52 Acres
2189 E.R. Co.

Patton
117 Acres
2197 E.R. Co.

Berwind-White Co.
Fee

Low
79 Acres
2198 E.R. Co.
Berwind-White Co.
Fee

H.G. Fisher Est. & Berwind-White Co.
Thomas Henderson
95 Acres Fee
2186 E.R. Co. & H.G. Fisher Est.

Berwind-White Co.
Fee
Goss or Patton
972 Acres
2199 E.R. Co.

Beams
107.5 Acres Coal
Delong-Surface
2185 E.R. Co. & H.G. Fisher Est.
H.G. Fisher Est. & Berwind-White & Co.

2200 E.R. Co.
Berwind-White Co.
Frank & Ogle Est.
S. Henderson
15284 Acres Coal 80 As. Surr.

Berwind-White Co.
2184 E.R. Co. & H.G. Fisher Est.

Thos. Barton
263 Acres
Fee

Houtz Heirs

Chandler Tract

H.G. Fisher Est. & Berwind-White & Co.
Part of Houtz Heirs
199 Acres Surr.

Berwind-White Co.
Frank & Ogle Estate
Part of Houtz Heirs
41.75 Acres Fee

Houtz Heirs

Houtz Heirs