

RW  
THE QUEEN'S RUN FIRE BRICK CO.

RECONNOISSANCE MAP  
OF  
PROPOSED RAILWAY

FROM DuBois TO FIRE-CLAY LANDS IN  
BLOOM TOWNSHIP.  
CLEARFIELD Co., PA. 185

DuBois, Pa.  
May 12, 1909.

E. W. Hess & A. L. Boutan  
ENGINEERS.

RECONNOISSANCE  
By E. W. Hess.

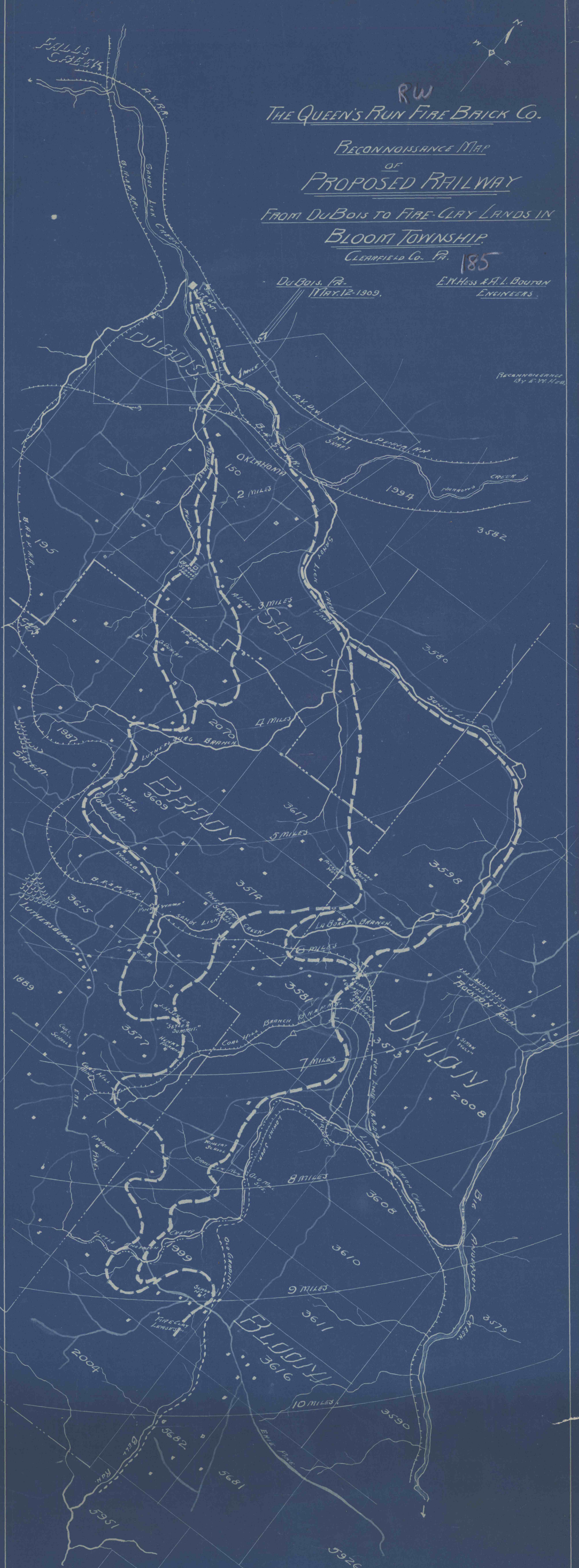

568