

8610

8609

8608

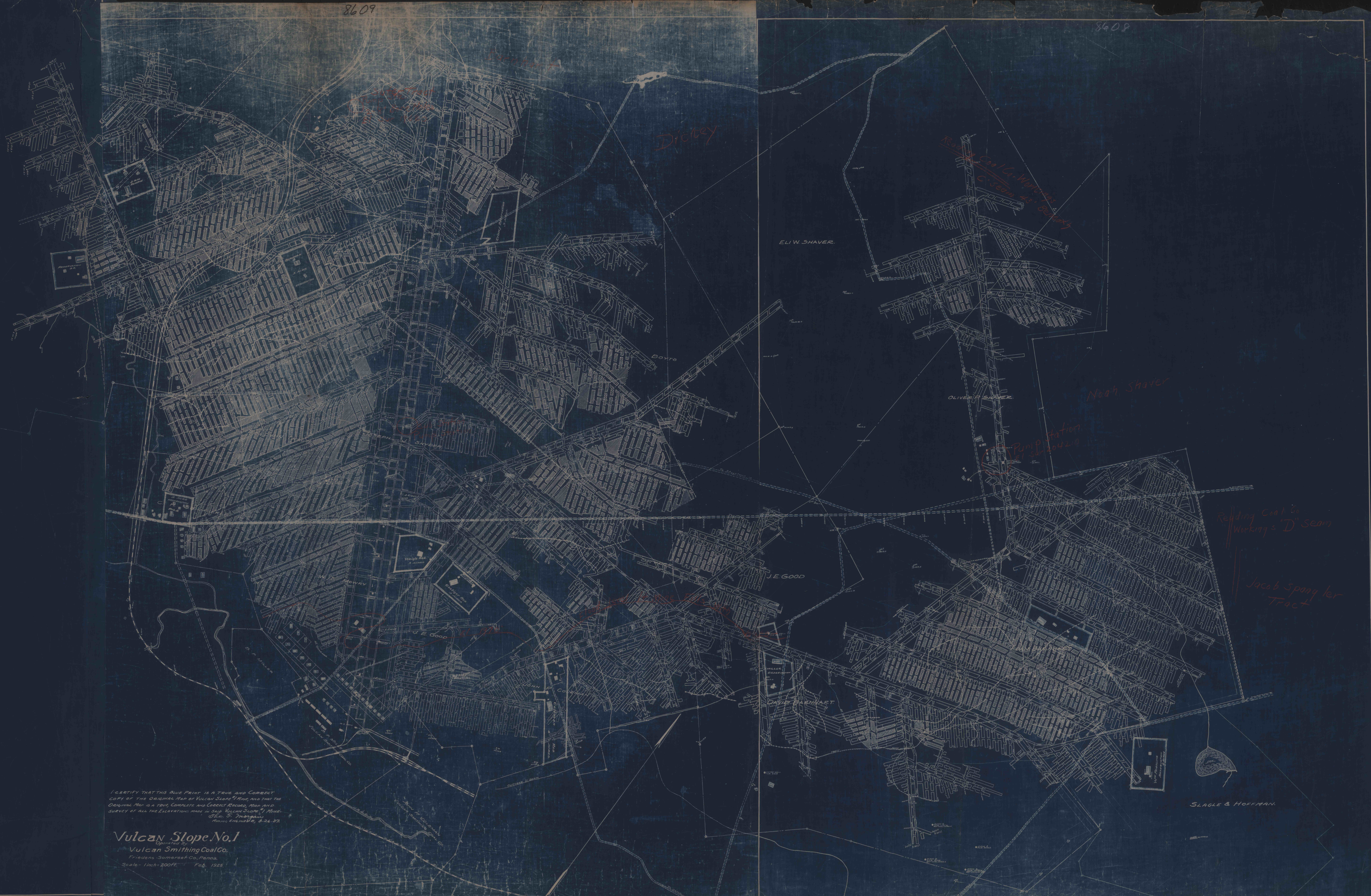

I CERTIFY THAT THIS BLUE PRINT IS A TRUE AND CORRECT COPY OF THE ORIGINAL PLAN OF VULCAN SLOPE NO. 1 MINE AND THAT THE ORIGINAL PLAN IS IN THE POSSESSION AND CONTROL OF THE ENGINEERING DEPARTMENT OF ALL THE ESCAVATIONS MADE IN SAID VULCAN SLOPE NO. 1 MINE.
 J. S. THOMPSON
 Mining Engineer, 8-26-37

Vulcan Slope No. 1
 Operated by
Vulcan Smelting Coal Co.
 Fredonia, Somerset Co., Penna.
 Scale - 1 inch = 200 feet. Feb., 1937

SLAGLE & HOFFMAN