

USA

NOTE:

NO. 1 A SEAM SPOILS	5.50 ACRES	NO. 8 B SEAM SPOILS	2.35 ACRES
A SEAM STRIPPING	31.00 ACRES	B SEAM STRIPPING	1.60 ACRES
B SEAM STRIPPING	18.40 ACRES	B RIDER STRIPPING	1.60 ACRES
B RIDER STRIPPING	8.35 ACRES	C SEAM STRIPPING	1.60 ACRES
TOTAL DISTURBED AREA	36.50 ACRES	TOTAL DISTURBED AREA	4.55 ACRES
NO. 2 A SEAM SPOILS	7.30 ACRES		
A SEAM STRIPPING	55.30 ACRES		
B SEAM STRIPPING	48.75 ACRES		
B RIDER STRIPPING	64.30 ACRES		
C SEAM STRIPPING	38.35 ACRES		
C PRIME STRIPPING	12.30 ACRES		
D SEAM STRIPPING	6.40 ACRES		
TOTAL DISTURBED AREA	101.27 ACRES		
NO. 3 C SEAM STRIPPING	26.35 ACRES		
C PRIME STRIPPING	26.35 ACRES		
D SEAM STRIPPING	4.40 ACRES		
TOTAL DISTURBED AREA	26.35 ACRES		
NO. 4 A SEAM STRIPPING	38.40 ACRES		
TOTAL DISTURBED AREA	38.40 ACRES		
NO. 5 A SEAM SPOILS	5.30 ACRES		
A SEAM STRIPPING	57.35 ACRES		
B SEAM STRIPPING	20.95 ACRES		
B RIDER STRIPPING	20.95 ACRES		
C SEAM STRIPPING	8.40 ACRES		
TOTAL DISTURBED AREA	91.05 ACRES		
NO. 6 B SEAM SPOILS	13.80 ACRES		
B SEAM STRIPPING	24.50 ACRES		
B RIDER STRIPPING	24.50 ACRES		
C SEAM STRIPPING	24.50 ACRES		
TOTAL DISTURBED AREA	38.30 ACRES		
NO. 7 B SEAM SPOILS	10.00 ACRES		
B SEAM STRIPPING	47.90 ACRES		
B RIDER STRIPPING	47.90 ACRES		
C SEAM STRIPPING	9.80 ACRES		
C PRIME STRIPPING	8.25 ACRES		
TOTAL DISTURBED AREA	57.30 ACRES		
TOTALS OF 1-2-3-4-5-6-7-8			
A AND B SPOILS AREA	45.83 ACRES		
A SEAM STRIPPING	101.35 ACRES		
B SEAM STRIPPING	162.30 ACRES		
B RIDER STRIPPING	162.20 ACRES		
C SEAM STRIPPING	109.00 ACRES		
C PRIME STRIPPING	46.90 ACRES		
D SEAM STRIPPING	12.20 ACRES		
TOTAL DISTURBED AREA	384.32 ACRES		
AREA LEASED	587.44 ACRES		
K. & J. NO. 300 MINE DRAINAGE PERMIT NO. 4474 SM 4			
3-10-76 CORRECTED AREA TO MINE DRAINAGE PERMIT NO. 4474 SM 4			
5.85 ACRES			
TOTAL DISTURBED AREA	390.17 ACRES		

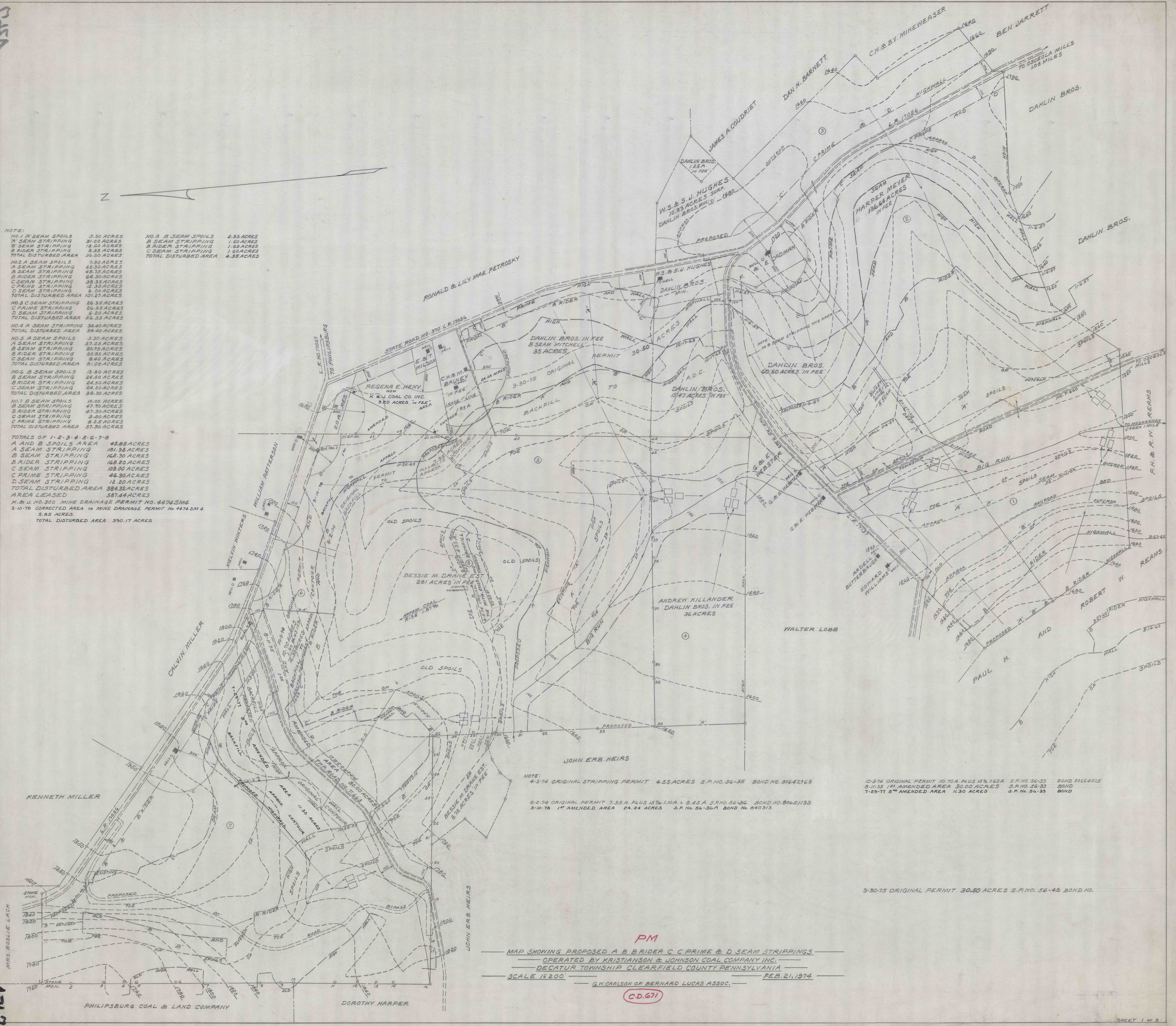

NOTE:  
 4-5-74 ORIGINAL STRIPPING PERMIT 4.55 ACRES S.P. NO. 56-35 BOND NO. 80647263  
 6-2-74 ORIGINAL PERMIT 7.35 A. PLUS 15% 110A. = 8.45 A. S.P. NO. 56-36 BOND NO. 80651133  
 3-10-76 1<sup>st</sup> AMENDED AREA 24.24 ACRES S.P. NO. 56-36A BOND NO. 840313

10-3-74 ORIGINAL PERMIT 10.70 A PLUS 15% 160A. S.P. NO. 56-39 BOND 80664515  
 8-11-75 2<sup>nd</sup> AMENDED AREA 30.00 ACRES S.P. NO. 56-39 BOND  
 1-63-77 2<sup>nd</sup> AMENDED AREA 11.30 ACRES S.P. NO. 54-39 BOND

3-30-75 ORIGINAL PERMIT 30.30 ACRES S.P. NO. 56-45 BOND NO.

PM  
 MAP SHOWING PROPOSED A B BRIDER C C PRIME & D SEAM STRIPPINGS  
 OPERATED BY KRISTIANSON & JOHNSON COAL COMPANY INC.  
 DECATUR TOWNSHIP CLEARFIELD COUNTY PENNSYLVANIA  
 SCALE 1" = 200' FEB. 21, 1974  
 G.M. CARLSON OF BERNARD LUCAS ASSOC.

C.D. 671

4367