

2412

2415

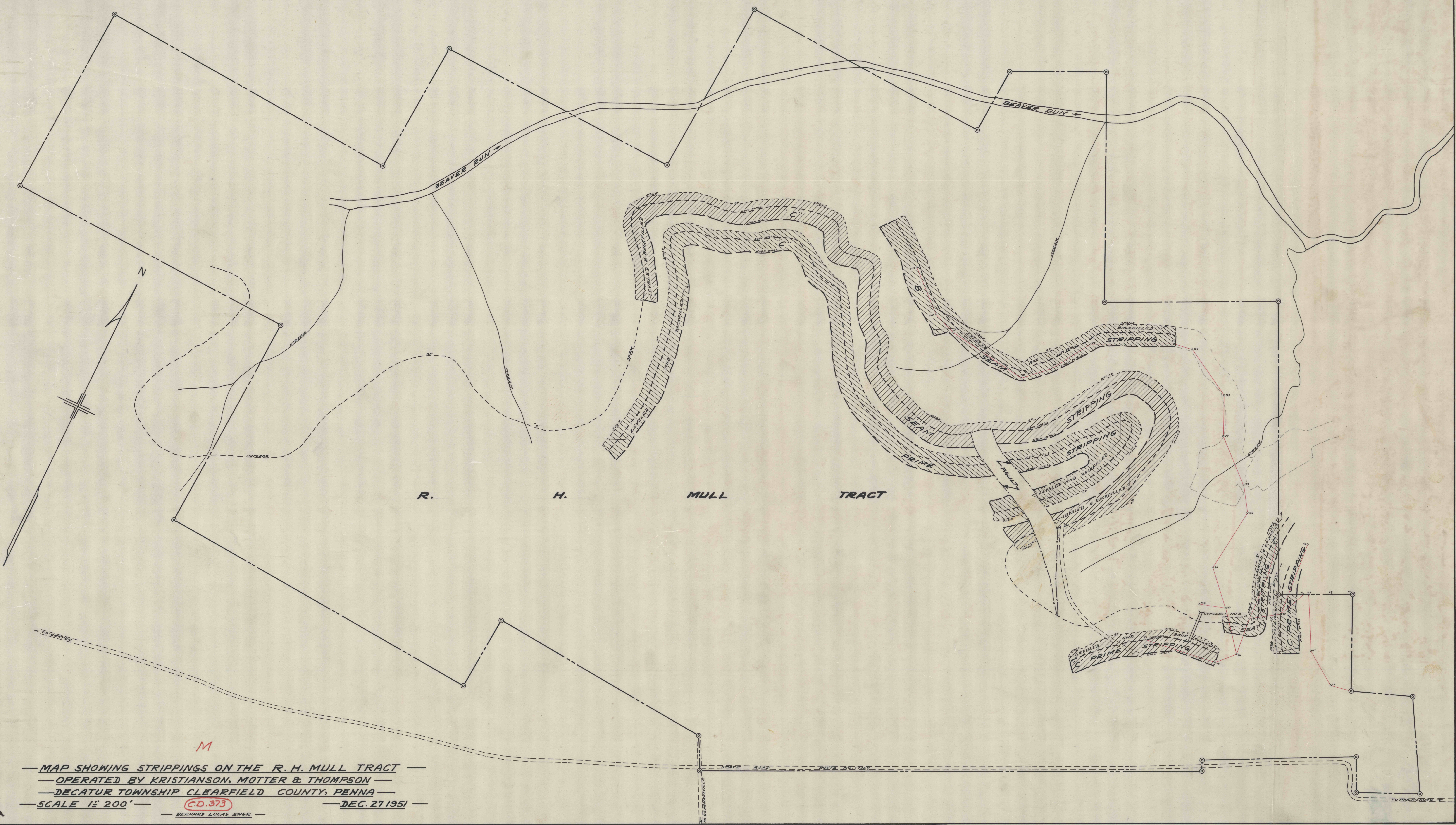

R. H. MULL TRACT

M
 — MAP SHOWING STRIPPINGS ON THE R. H. MULL TRACT —
 — OPERATED BY KRISTIANSON, MOTTER & THOMPSON —
 — DECATUR TOWNSHIP CLEARFIELD COUNTY, PENNA —
 — SCALE 1" = 200' — **C.D. 373** — DEC. 27 1951 —
 — BERNARD LUCAS ENGR. —