

MILLER BROS. & COWFER

N

SCALE 1"=200'  
AUG. 11, 1958

COMPANY

COAL & LAND

PHILIPSBURG

LIAMES KEPHART

TOWNSHIP

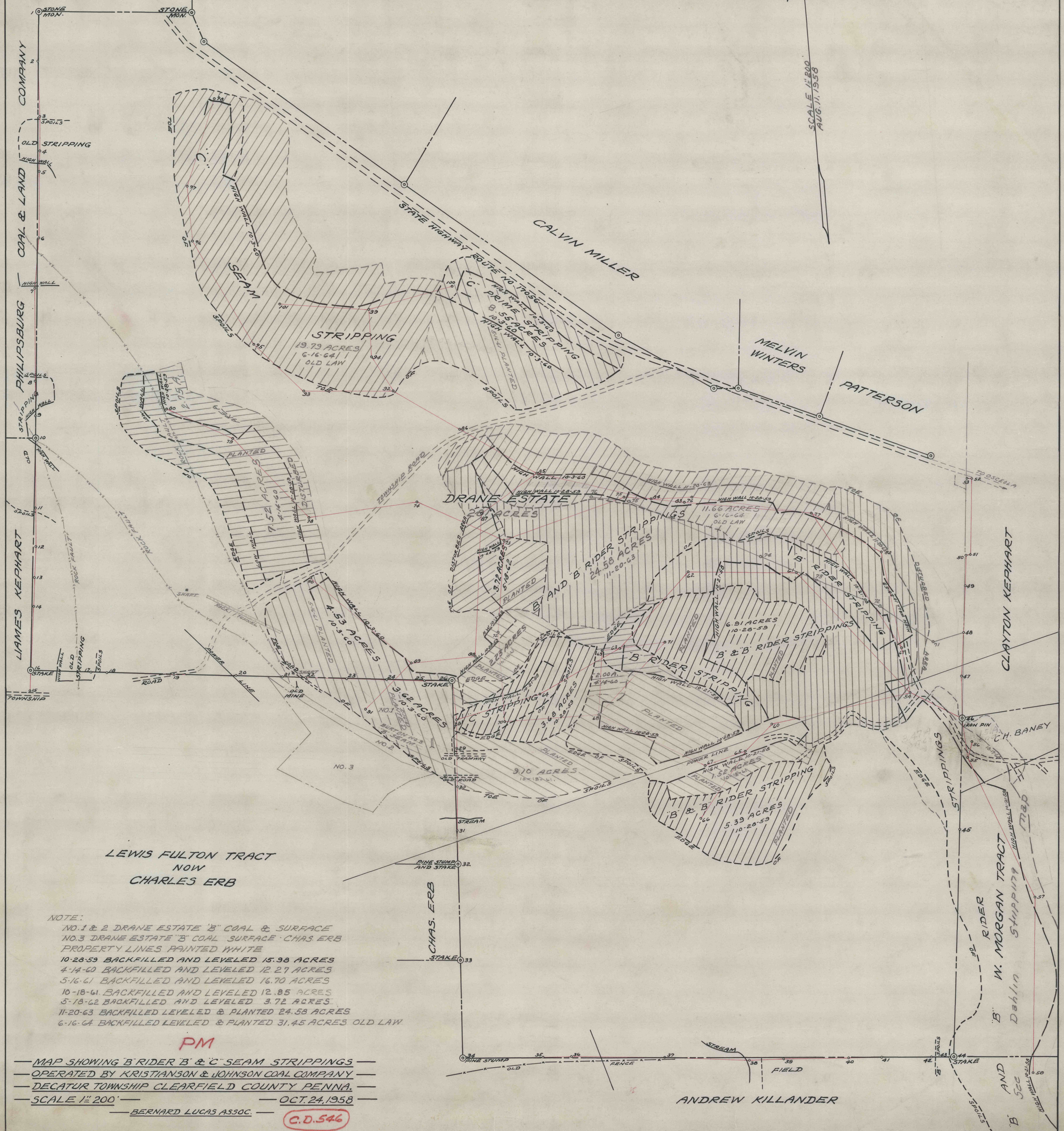

LEWIS FULTON TRACT  
NOW  
CHARLES ERB

NOTE:  
 NO. 1 & 2 DRANE ESTATE 'B' COAL & SURFACE  
 NO. 3 DRANE ESTATE 'B' COAL SURFACE CHAS ERB  
 PROPERTY LINES PAINTED WHITE  
 10-28-59 BACKFILLED AND LEVELED 15.98 ACRES  
 4-14-60 BACKFILLED AND LEVELED 12.27 ACRES  
 5-16-61 BACKFILLED AND LEVELED 16.70 ACRES  
 10-18-61 BACKFILLED AND LEVELED 12.85 ACRES  
 5-18-62 BACKFILLED AND LEVELED 3.72 ACRES  
 11-20-63 BACKFILLED LEVELED & PLANTED 24.58 ACRES  
 6-16-64 BACKFILLED LEVELED & PLANTED 31.45 ACRES OLD LAW

PM

MAP SHOWING 'B' RIDER 'B' & 'C' SEAM STRIPPINGS  
 OPERATED BY KRISTIANSON & JOHNSON COAL COMPANY  
 DECATUR TOWNSHIP CLEARFIELD COUNTY PENNA.  
 SCALE 1"=200' OCT. 24, 1958

BERNARD LUCAS ASSOC.

C.D. 546

ANDREW KILLANDER