

2115

NEVELING ESTATE

2175

THELIMA TRACT
I. AND L. FINBERG MIN.
GEN. REFRATORIES CO. SURF.

JESSIE YARGER SURF.
GEN. REF. CO. MIN.

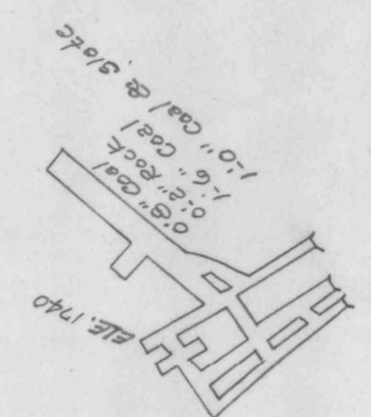

I. AND L. FINBERG
103 ACRES
COAL AND SURFACE

GEN. REFRATORIES CO.

9-27-02
SCALE 1:200
APPROX

DECATUR TOWN
SHIP SCHOOL DISTRICT
Tract No. 1

JESSIE FAULKNER

LIVE OAK
ASHLAND

SMITH

WILKS

SAMUEL HAMBELTON TRACT
K. C. CO.

TO BRISBEN STATE ROAD NO. 17043

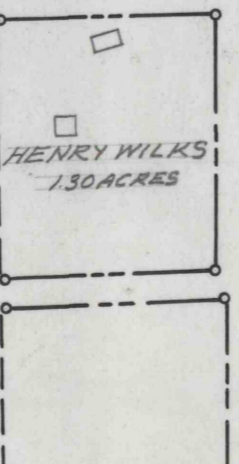

SEAM
LIVE OAK
TO BRISBEN

TO OBERLIN MILLS
FAULT

PD
C.D. 599