

2241

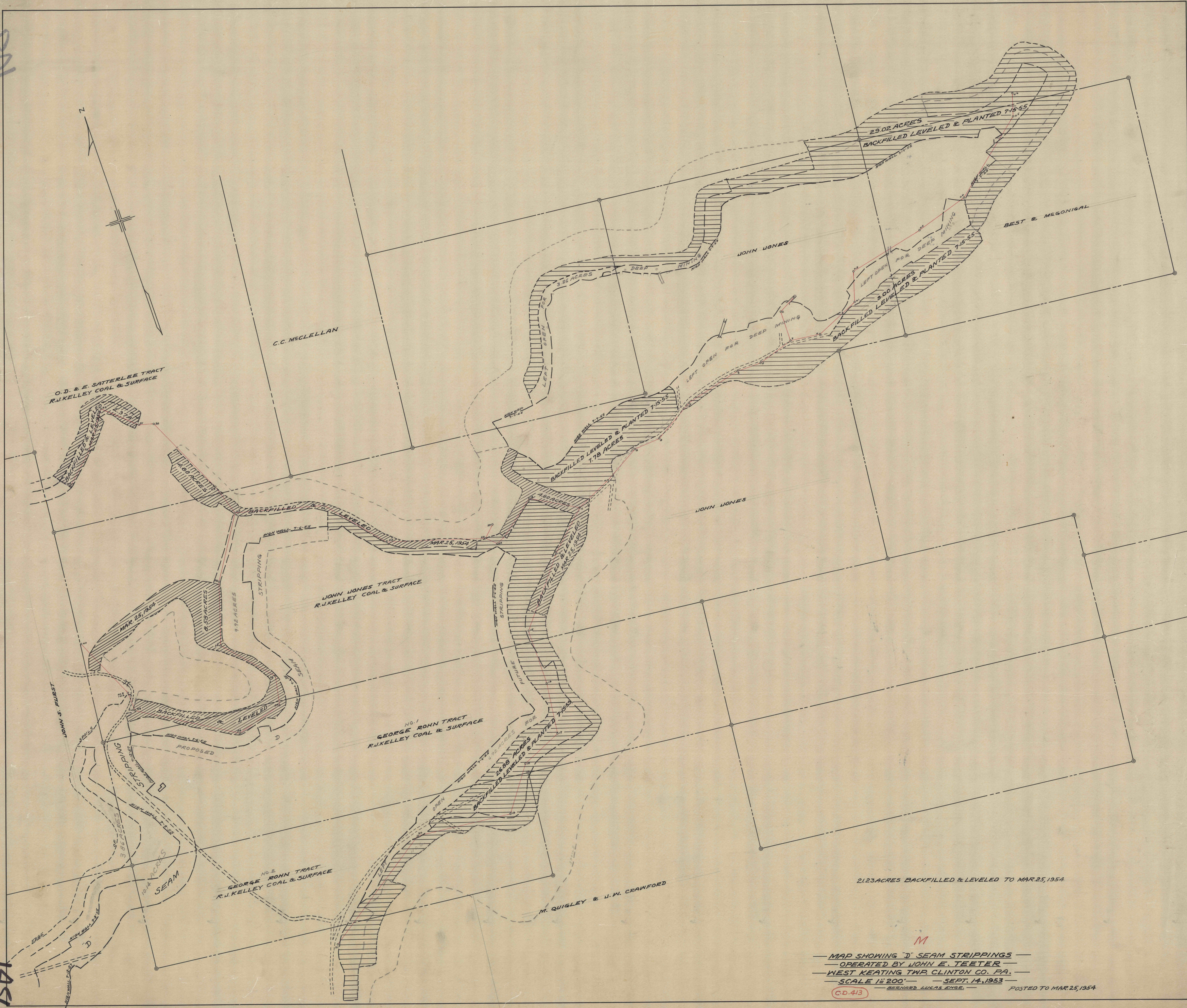

21.23 ACRES BACKFILLED & LEVELED TO MAR. 25, 1954

M

MAP SHOWING "D" SEAM STRIPPINGS
 OPERATED BY JOHN E. TEETER
 WEST KEATING TWP. CLINTON CO. PA.
 SCALE 1" = 200' SEPT. 14, 1953
 BERNARD LUCAS ENGR.

C.D. 413

POSTED TO MAR. 25, 1954

1456