

Mrs Elizabeth Douglas.

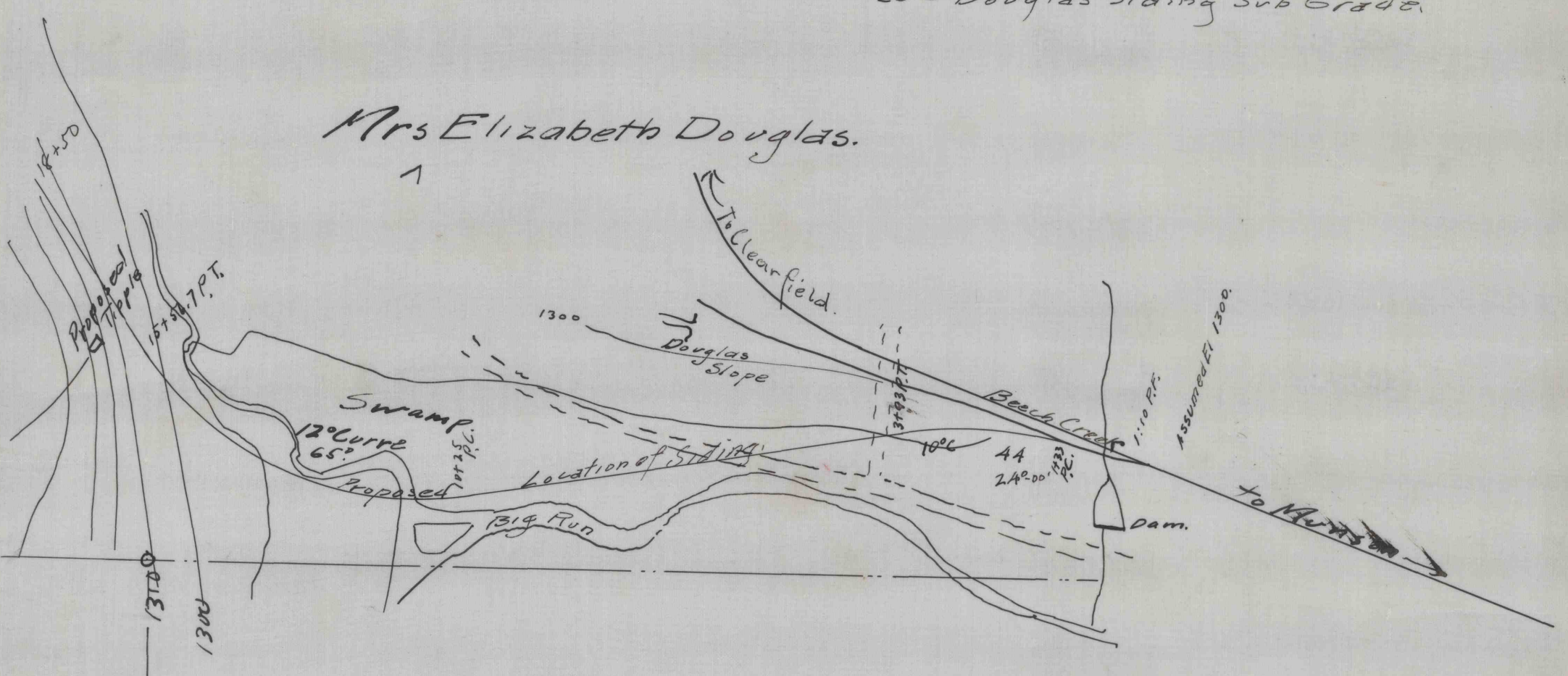

O. L. Schooner et al.



Map Showing
 Proposed Location of
 Siding and Tramroad
 to
 Moshannon Vein of Coal
 on
 Berger-Hessick & Trucks
 Property
 near
 Mason Clearfield Co. Pa.
 Scale 1" = 200'
 1902
 A. V. Hoyt Engr
 Philadelphia Pa.

703

1165

703

1165