

JOHN POTTER

N° 41° 00' E

76.6 Rods

SD

MAP

OF LAND OWNED BY

JAMES B. SMITH.

SHOWING MINES OF

CURWENSVILLE FIRE BRICK CO.

PIKE TWP. CLEARFIELD CO PA.

SCALE 1" = 1/4" = 165'

CLEARFIELD, PA.

Nov. 2, 1906.

E.W. HESS
ENGINEER.

J. B. NORRIS.

233

CLARK MORRIS ESTATE.

71.5 Rods

N 48° W 17.6 Rods

Post

N 41° 15' W

Stones

Stones

N 64° 30' E

101.8 Rods

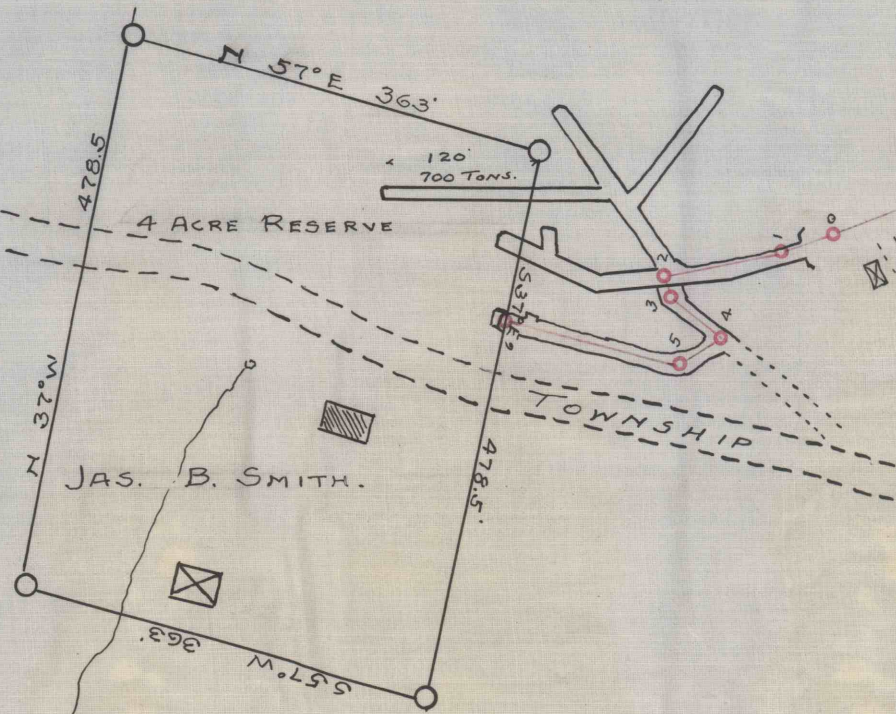

TOWNSHIP

ROAD

GRAMPIAN

TO CURWENSVILLE.

N 17° E 200 Rods

Post

VORICE CLARK.

S 52° 00' E 48 Rods

Post

MILTON McCLURE.

Rods 203.4

41° 30' W

VORICE CLARK.