

DW-1
C-22

DW-1
C-22

MAP SHOWING CHANGES IN LOCATION OF BEYS CREEK
BETWEEN ARCH UNDER OLD P.R.R. MAIN LINE AND HEMLOCK CORNER
OF № 3 ALLOTMENT, SUB-DIVISION OF ARENT SONMAN TRACT, SINCE
SURVEY OF JULY, 1896.

SCALE: 1"=100'

APRIL-1918

J.S. SILLYMAN & Co.
ENGINEERS

JOHN AND THOMAS LEAHEY

GAMBRIA MINING AND MANUFACTURING CO.

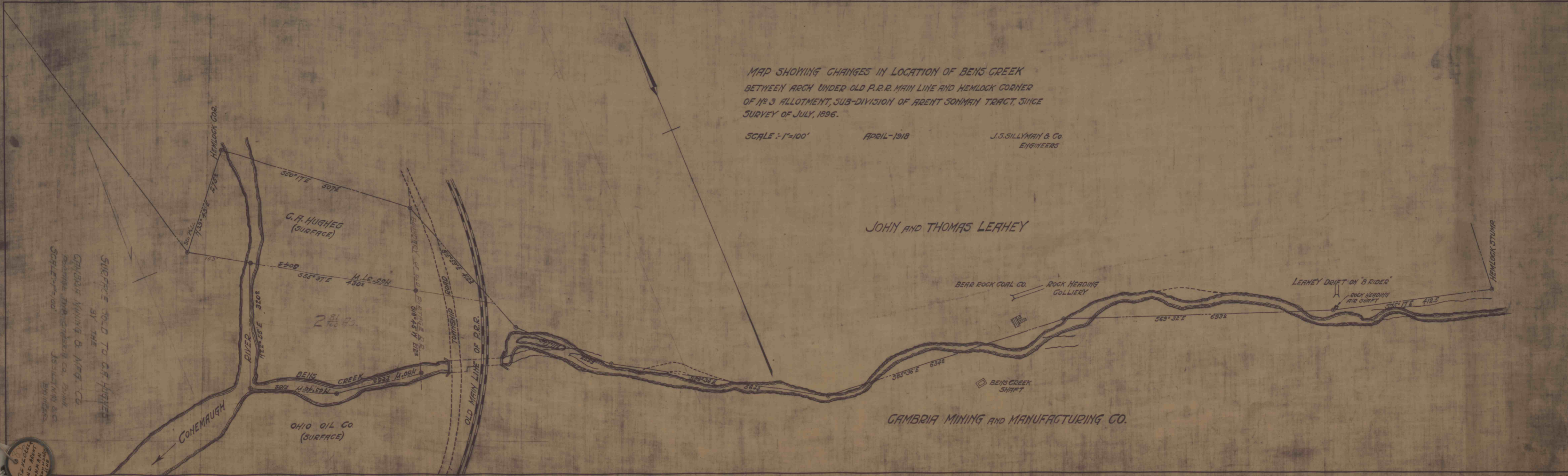

DW-1
C-22