

SONMAN SHAFT COAL CO. OBTAINED RIGHT TO DRIVE THESE HEADINGS THROUGH UNDER R.R. RIGHT OF WAY BY AGREEMENT OF SEPT. 29, 1919.

E SEAM

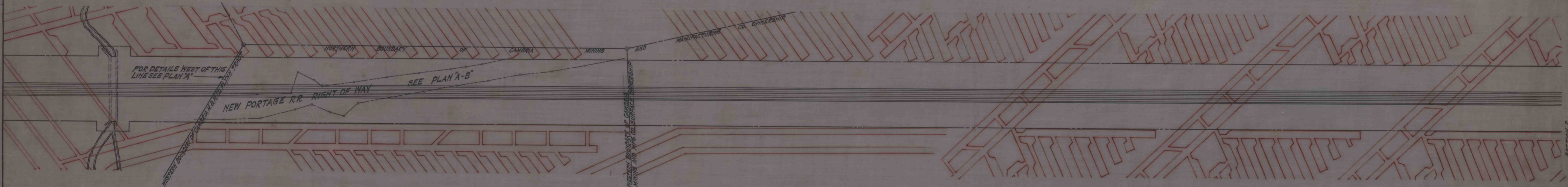

C PRIME AND D SEAMS

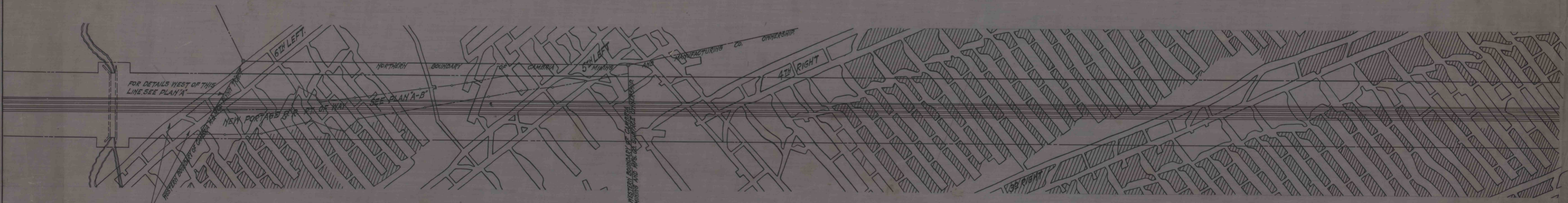

SONMAN SHAFT COAL CO. OBTAINED RIGHT TO DRIVE THIS HEADINGS AND AIR COURSE THROUGH UNDER R.R. RIGHT OF WAY BY AGREEMENT OF DEC. 9, 1919.

B SEAM

**LEGEND-**  
 MOST OF THE COAL OF THE B SEAM HAD ALREADY BEEN MINED UNDER THE MAIN LINE TRACKS, AND EXTENSIVE MINING HAD ALREADY BEEN DONE UNDER THE TRACKS IN THE E SEAM ACCORDING TO A DIFFERENT PLAN OF MINING BEFORE NEGOTIATIONS WERE STARTED FOR CONVEYANCE OF COAL TO THE PENNSYLVANIA RAILROAD CO. THEREFORE IDENTICAL PILLARS AND BLOCKS OF COAL CANNOT BE CONVEYED IN ALL FOUR WORKABLE COAL SEAMS.  
 COAL WAS MINED FROM UNDER OLD PORTAGE AND NEW PORTAGE R.R. RIGHTS OF WAY, AND WORKINGS PROJECTED TO DRIVE THROUGH THEM, IN BELIEF THAT CAMBRIA M. & M. CO. OWNED THE COAL - SEE EXPLANATION IN LETTER.

**PLAN A-A**  
 PILLARS AND BLOCKS OF COAL IN 200 FT WIDE STRIP UNDER MAIN LINE TRACKS BETWEEN PORTAGE AND CASSANDRA, PITTSBURGH DIVISION TO BE CONVEYED TO  
**PENNSYLVANIA RAILROAD CO.**  
 BY  
**CAMBRIA MINING AND MANUFACTURING CO.**  
 SCALE: 1"=100' MAY-1-1932  
 APPROVED: *W.A. Sullivan* CHIEF ENGINEER MAINTENANCE OF WAY, P.R.R. CO. *W.A. Sullivan* MINING ENGINEER ALTOONA, PA.  
*Frederick McQuinn* 5/27/32 Real Estate Agent of The Pennsylvania Railroad Co. President of The Cambria Mining and Manufacturing Co.

SECTION 2 OF PLAN A-A (PRINT OF SECTION 2 ON SEPARATE TRACKING TO BE ATTACHED TO RIGHT OF THIS SECTION)