

PLAN OF 1947-48 STRIPPING ON THE WILLIAM WINGERT TRACT, UNION TOWNSHIP CLEARFIELD CO., PENNA.
OVERBURDEN REMOVED BY THE B. & B. CONSTRUCTION CO.

REFERENCE DATA

NORTH AMERICAN REFRACTORIES CO.
1012 NATIONAL CITY BANK BUILDING
CLEVELAND, OHIO

ENV. No.

SHEET No.

INDEX No
51-2-44

SCALE - 1" = 100'

DATE - 4-6-48

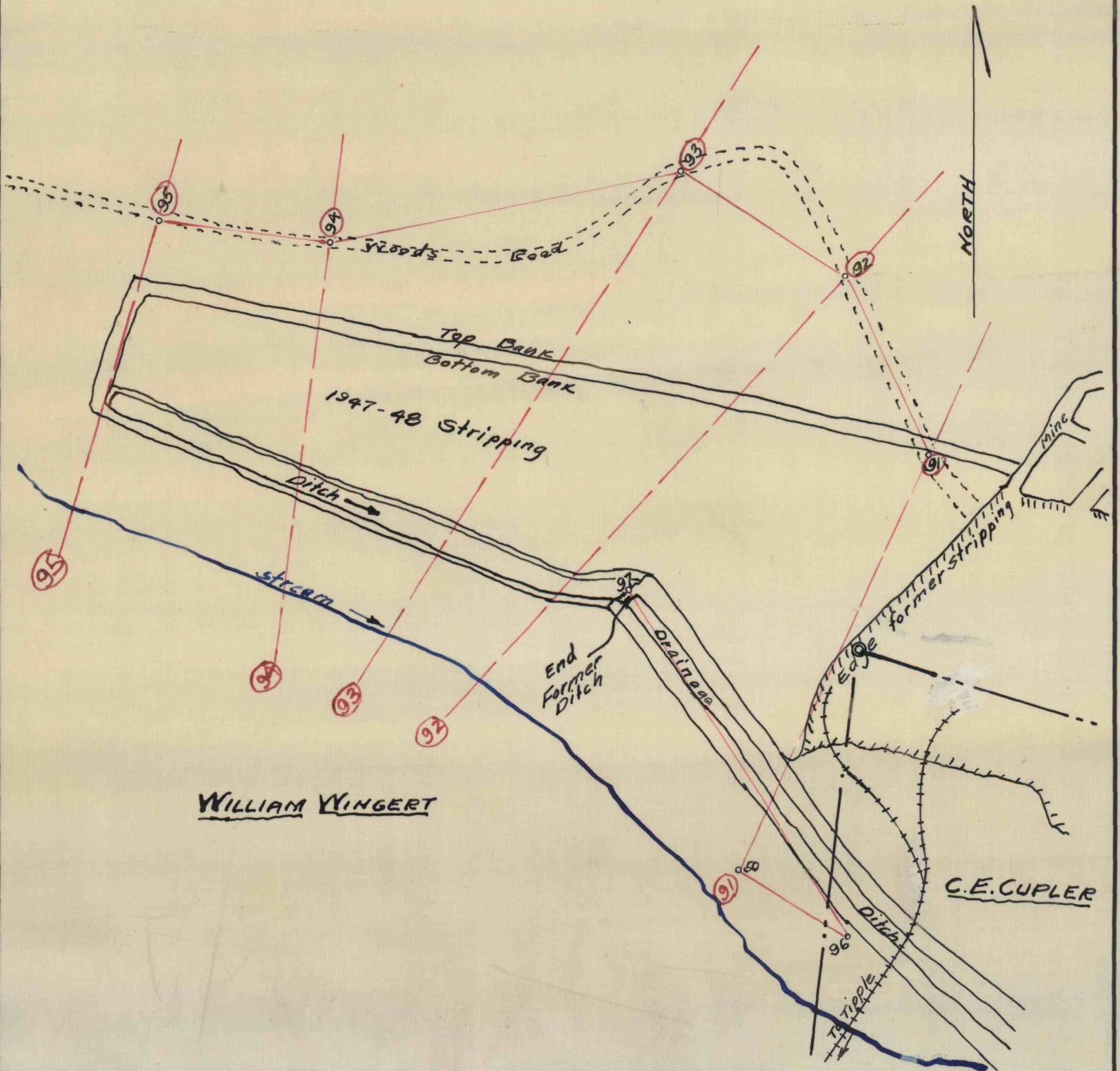

WORKED FROM DWG No 51-2-38 & Surreys

DRAWN BY M.E.H.

CHECKED BY J.M.H.