

CS  
D  
4740

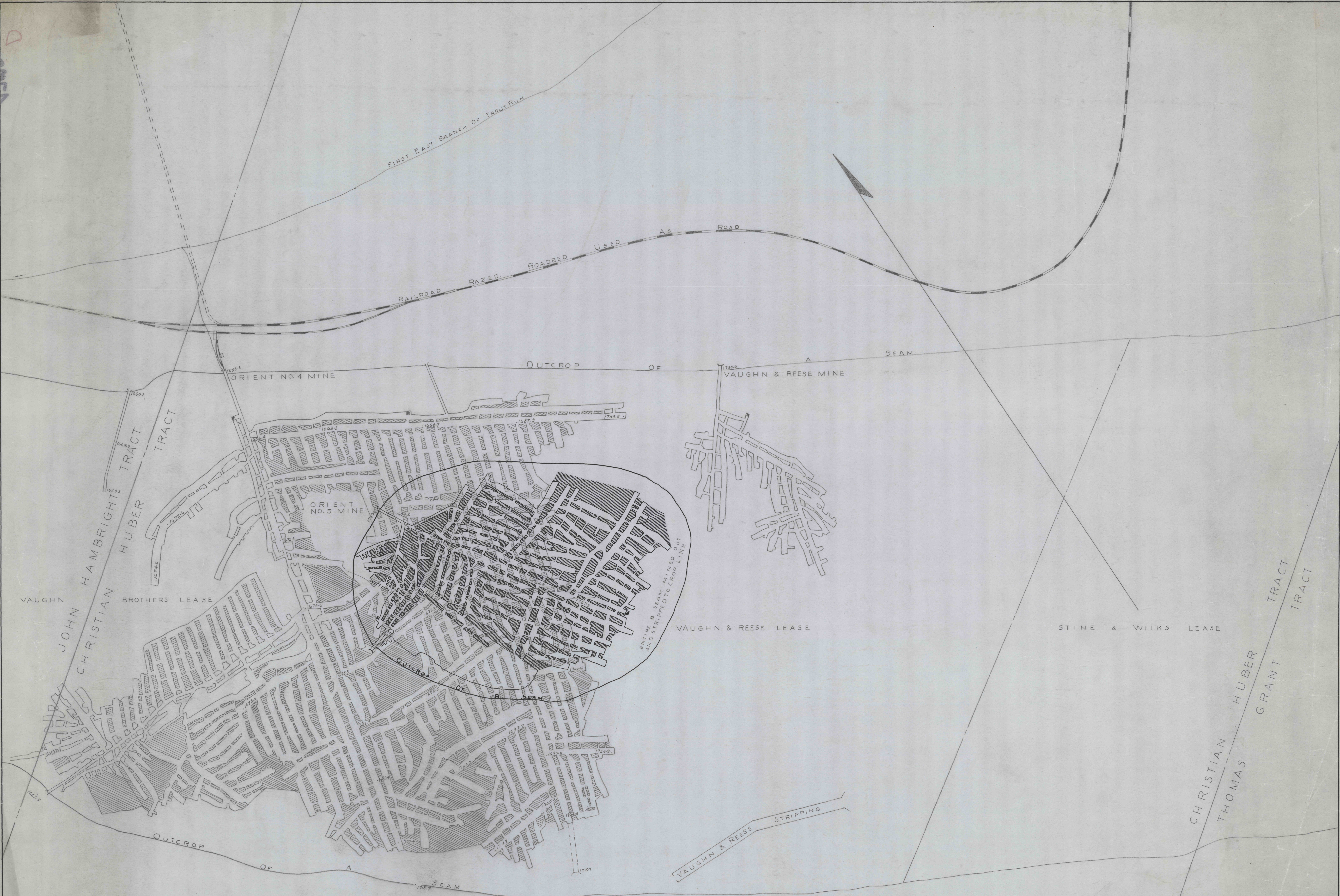

**D**

VAUGHN AND REESE  
SANDY RIDGE, PENNSYLVANIA.

MAP SHOWING THE ORIENT NO. 4  
AND NO. 5 MINES AND STRIPPED AREA  
UNDER LEASE BY VAUGHN AND REESE ON THE  
CHRISTIAN HUBER TRACT IN RUSH  
TOWNSHIP CENTRE COUNTY PENNSYLVANIA.  
SCALE 1"=100 FT. DECEMBER 29, 1945.

4740

D