

0805

2800

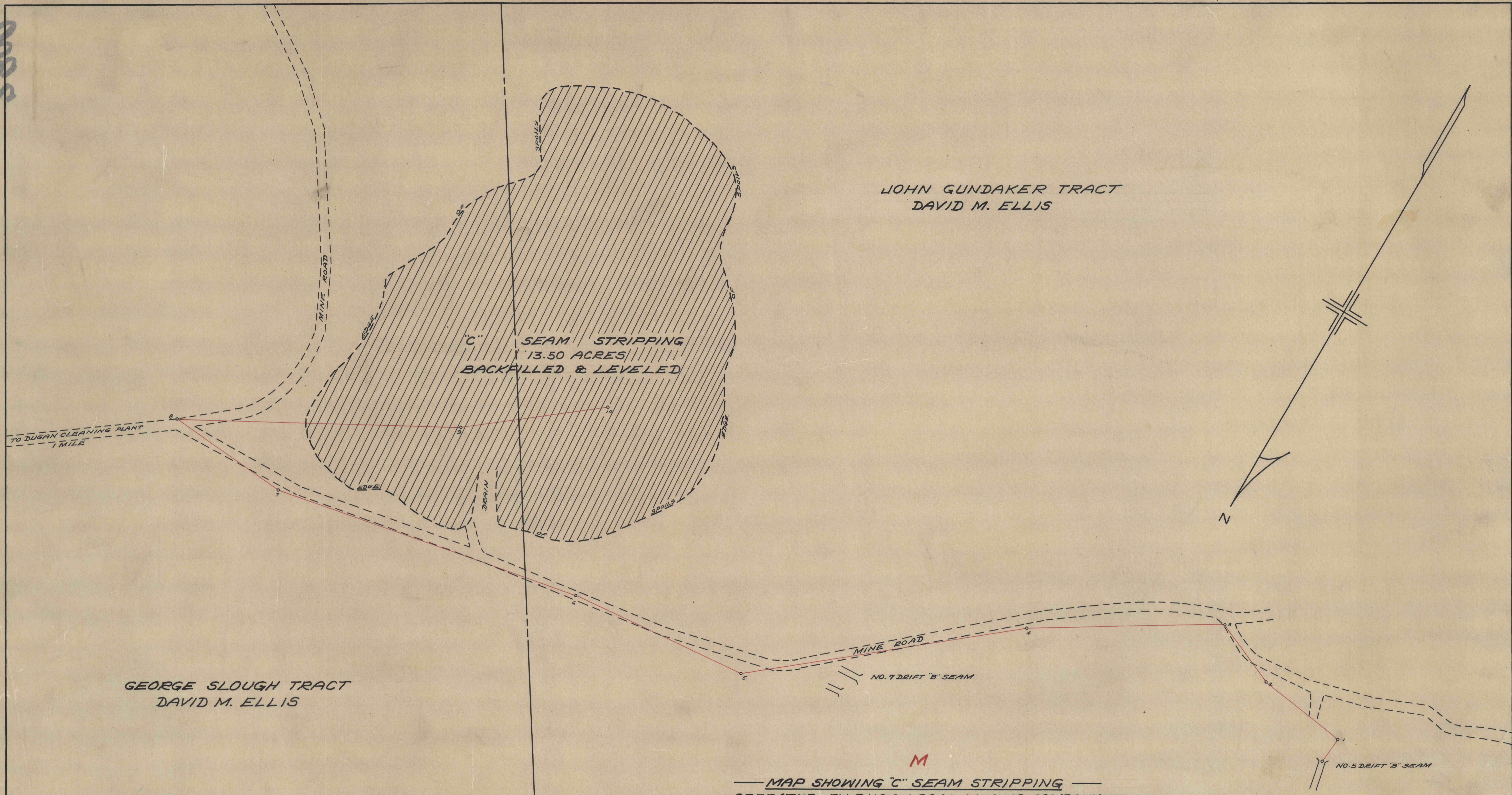

JOHN GUNDAKER TRACT
DAVID M. ELLIS

GEORGE SLOUGH TRACT
DAVID M. ELLIS

M

— MAP SHOWING "C" SEAM STRIPPING —
 — OPERATED BY DUGAN COAL MINING COMPANY —
 — RUSH TOWNSHIP CENTRE COUNTY PA. —
 — SCALE 1" = 100' — AUG. 23, 1954 —
 — BERNARD LUCAS ENGR. —

C.D. 225