

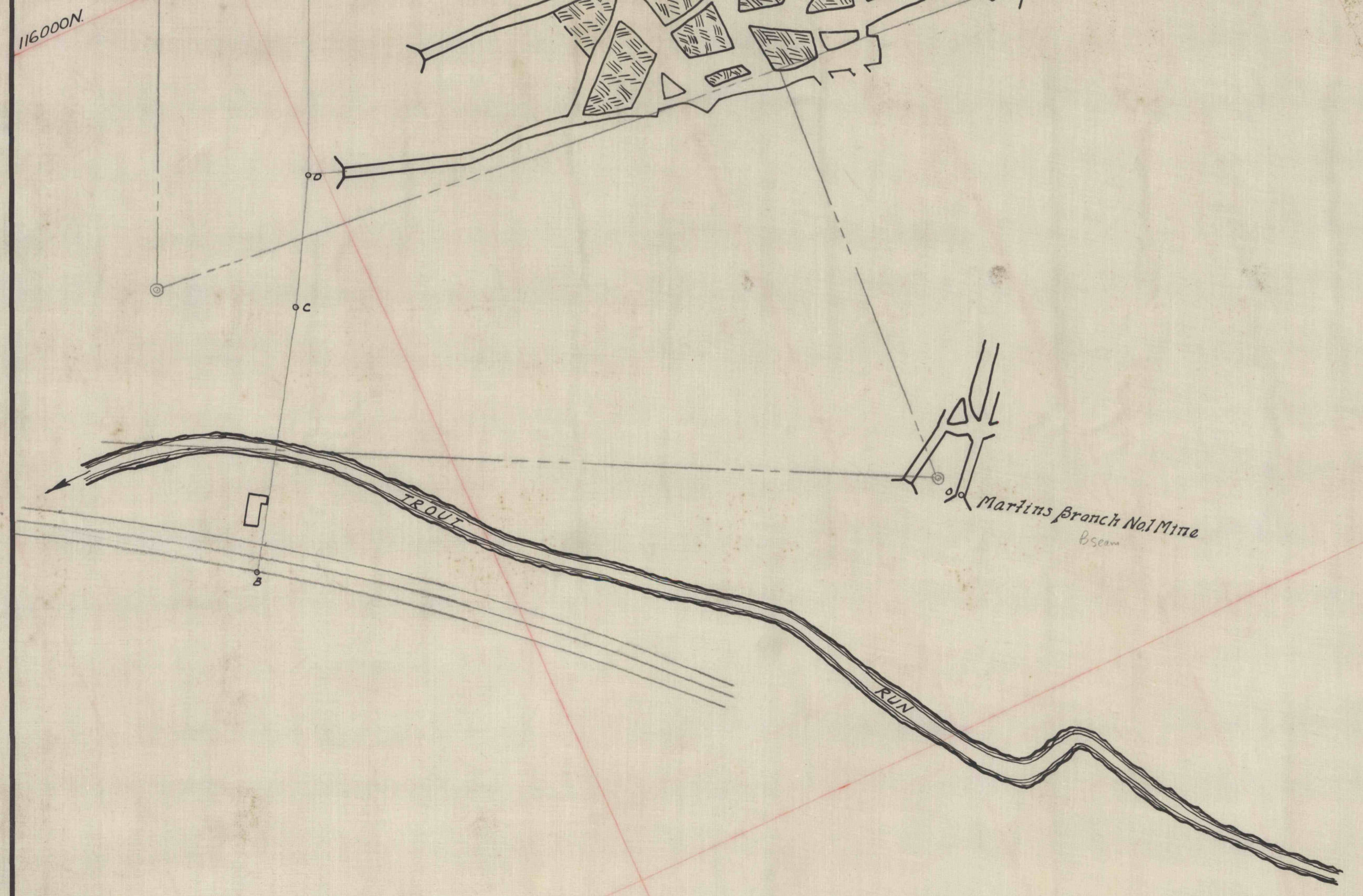

CAMBRIA COUNTY COAL COMPANY



MAP

THERMAL SMOKELESS COAL CO.

NO. 3 MINE

PORTAGE CAMBRIA COUNTY PA.

Scale 1"=100' A. B. Crichton Sept. 29th 1919

Mining Engineer
Johnstown Pa.

REVISED TO

C. Seaman

232