

GEORGE WISE ESTATE

RICHARD SHIELDS ESTATE

A. SHIELDS TRACT

DAN SHIELDS TRACT

RICHARD SHIELDS ESTATE

JAMES FULTON NOW CEMETERY

ADOLPH KRESKA TRACT

HOWARD STOKES TRACT

RICHARD SHIELDS ESTATE

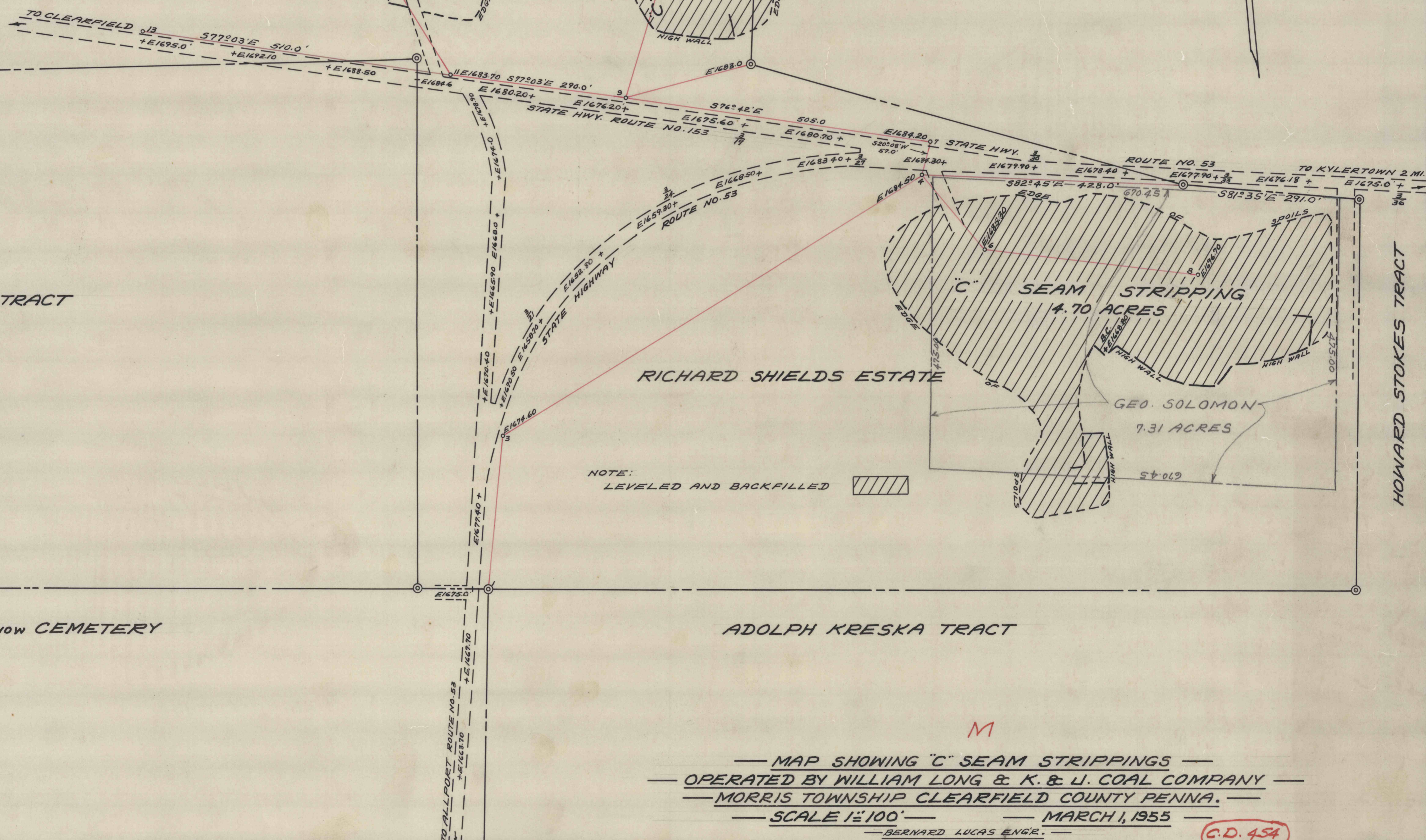
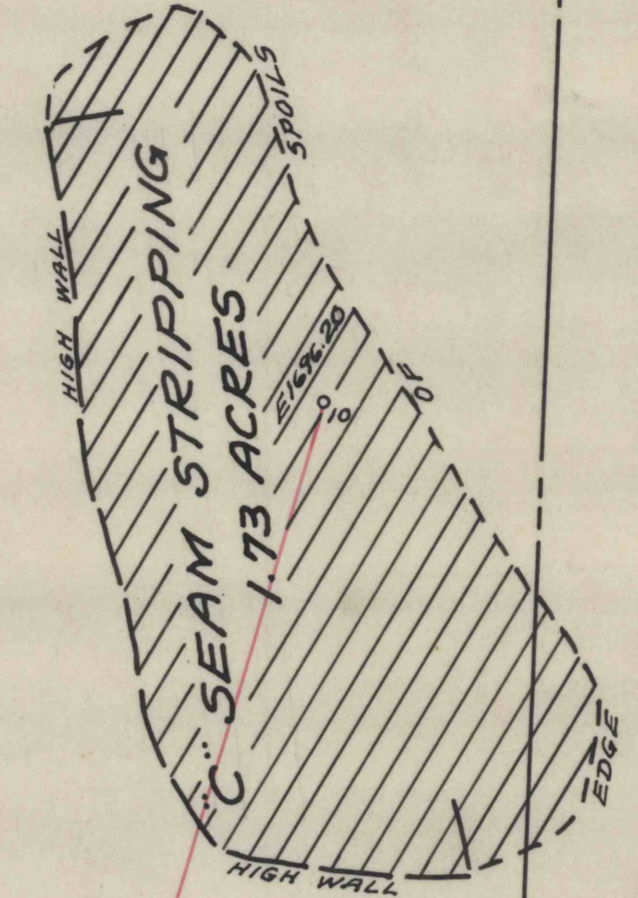

— MAP SHOWING "C" SEAM STRIPPINGS —
 — OPERATED BY WILLIAM LONG & K. & J. COAL COMPANY —
 — MORRIS TOWNSHIP CLEARFIELD COUNTY PENNA. —
 — SCALE 1"=100' — MARCH 1, 1955 —
 — BERNARD LUCAS ENGR. —

G.D. 454

1981

1985