

MANOR REAL ESTATE

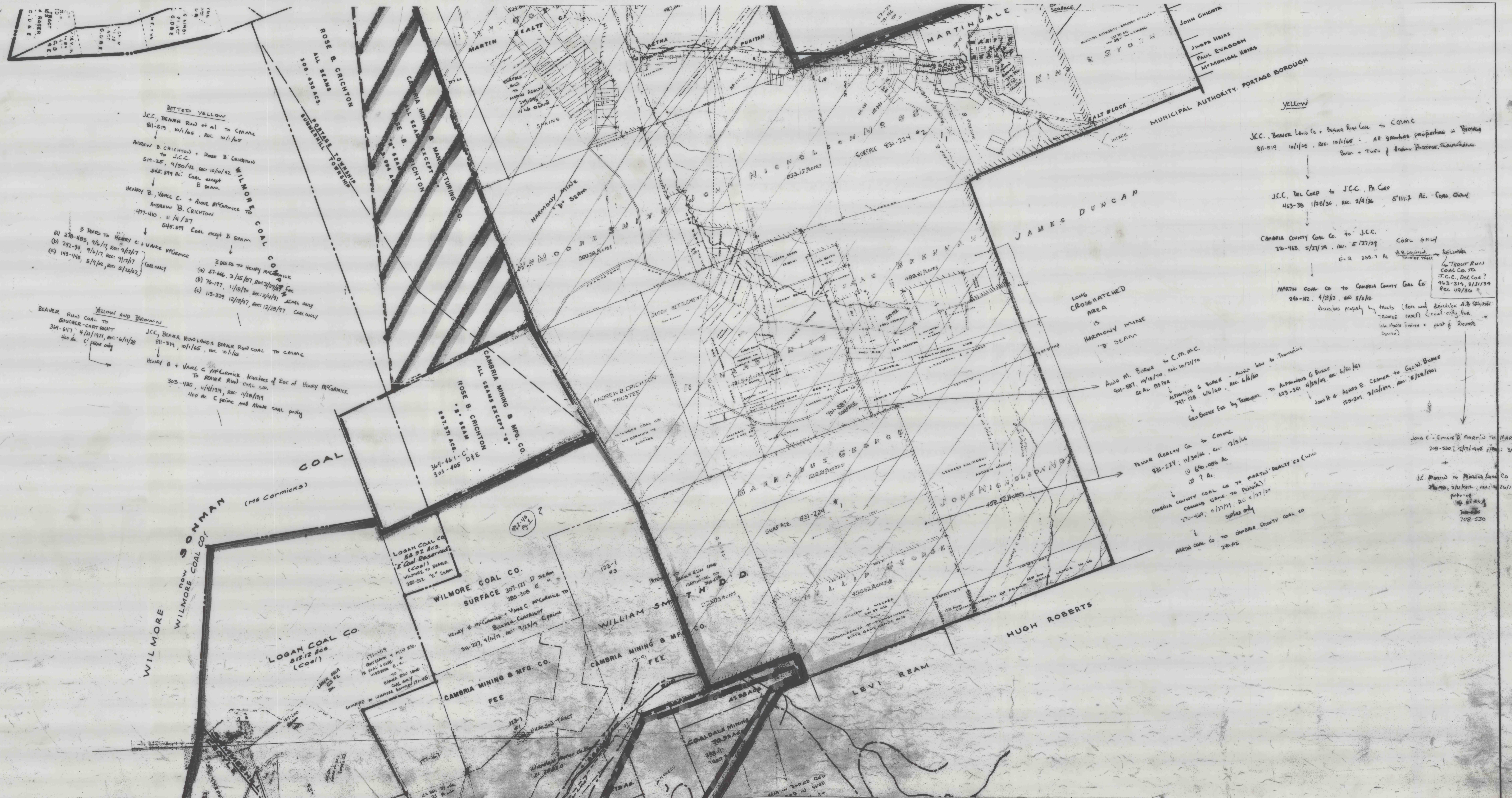

**BOTTED YELLOW**  
 J.C.C., BEAVER RUN et al to CMCC  
 811-519, 10/1/65, rec. 10/1/65

ANDREW B. CRICHTON + ROSE B. CRICHTON  
 to J.C.C.  
 519-25, 9/30/42, rec. 10/10/42  
 545-599 AC. COAL EXCEPT B SEAM

HENRY B. VANCE C. + ANNE MCGERMICK  
 ANDREW B. CRICHTON  
 477-410, 11/4/37  
 545-599 COAL EXCEPT B SEAM

3 DEEDS TO HENRY C. + VANCE MCGERMICK  
 (a) 278-483, 9/6/17, rec. 9/12/17  
 (b) 292-74, 9/6/17, rec. 9/12/17  
 (c) 143-445, 5/9/12, rec. 5/23/62

3 DEEDS TO HENRY MCGERMICK  
 (a) 57-666, 3/25/67, rec. 3/29/67  
 (b) 76-197, 11/18/70, rec. 2/4/91  
 (c) 113-829, 12/10/67, rec. 12/28/97

**YELLOW AND BROWN**  
 BEAVER RUN COAL TO  
 COUCKER-CARTWRIGHT  
 341-647, 4/12/1921, rec. 4/17/28  
 400 AC. C prime only

J.C.C., BEAVER RUN LAND & BEAVER RUN COAL TO CMCC  
 811-519, 10/1/65, rec. 10/1/65

HENRY B. + VANCE C. MCGERMICK TRUSTEES of EST. of HENRY MCGERMICK  
 TO BEAVER RUN COAL CO.  
 303-485, 11/4/1919, rec. 11/28/1919  
 400 AC. C prime and ABOVE COAL ONLY

**WILMORE**  
 NOW SONMAN  
 WILMORE COAL CO.  
 (Mc Cormicks)

**LOGAN COAL CO.**  
 812-12 ACs  
 (Coal)

**WILMORE COAL CO.**  
 SURFACE 307-121 D SEAM  
 285-308 E "

HENRY B. MCGERMICK + VANCE C. MCGERMICK TO  
 BOUCHER-CARTWRIGHT  
 311-227, 9/1/19, rec. 9/23/19

**CAMBRIA MINING & MFG. CO.**  
 FEE

**CAMBRIA MINING & MFG. CO.**  
 FEE

**COALDALE MINING**  
 79-95 ACs  
 TRACT

**CAMBRIA MINING & MFG. CO.**  
 ALL SEAMS EXCEPT "B"  
 ROSE B. CRICHTON  
 "B" SEAM  
 369-461 - C, D, E  
 303-405

ANDREW B. CRICHTON  
 TRUSTEE

**WILLIAM SMITH**

**LEVI REAM**

**HUGH ROBERTS**

**JAMES DUNCAN**

LONG  
 CROSSHATCHED  
 AREA  
 IS  
 HARMONY MINE  
 "D" SEAM

ANDREW M. BURKE to C.M.C.  
 901-587, 10/15/70, rec. 10/21/70  
 50 AC. B5 PER

ALPHONSE G. BURKE - ANNEX LAW TO THOMAS  
 797-128 4/6/60, rec. 6/6/60

Geo. BURKE Est. by THOMAS  
 TO ALPHONSE G. BURKE  
 633-211, 4/28/49, rec. 6/25/49

JOHN H. + AGNES E. CAMERON TO GEO. BURKE  
 135-207, 2/12/1919, rec. 5/28/1919

PENNA REALTY CO. to CMCC  
 831-224, 11/30/66, rec. 12/15/66  
 646.006 AC  
 2? AC.

CAMBRIA COUNTY COAL CO. TO MARTIN REALTY CO. (WHO  
 CHANGED NAME TO PENNA)  
 270-469, 5/17/29, rec. 6/27/29  
 SURFACE ONLY

MARTIN COAL CO. TO CAMBRIA COUNTY COAL CO.  
 240-112

JOHN C. + EMILIE D. MARTIN TO MARTIN COAL CO.  
 208-530, 1/17/1918, rec. 3/7/1918

J.C. MARTIN TO MARTIN COAL CO.  
 260-400, 2/15/1918, rec. 2/26/12  
 PART OF  
 708-530

J.C.C., BEAVER LAND CO. + BEAVER RUN COAL TO CMCC  
 811-519, 10/1/65, rec. 10/1/65 - All grants prospectives in BEAVER  
 Run + TRACT of BEAVER DISTRICT, SUBDIVISION

J.C.C. DEL CORP TO J.C.C. PA CORP  
 463-30, 1/20/36, rec. 2/4/36 5111.2 AC. COAL OIL

CAMBRIA COUNTY COAL CO. TO J.C.C.  
 370-465, 5/27/29, rec. 5/27/29 COAL ONLY  
 G.R. 255.1 AC

MARTIN COAL CO. TO CAMBRIA COUNTY COAL CO.  
 240-112, 4/28/12, rec. 5/12/12  
 BEAVER PROPERTY by TRACTS (see with BEAVER A+B COLUMBIAN  
 TRACTS TRACT) (COAL ONLY) (see  
 with BEAVER SURVEY + part of REAVER  
 SURVEY)

J.C.C. DEL CORP TO J.C.C. PA CORP  
 463-30, 1/20/36, rec. 2/4/36 5111.2 AC. COAL OIL

J.C.C. DEL CORP TO J.C.C. PA CORP  
 463-30, 1/20/36, rec. 2/4/36 5111.2 AC. COAL OIL

J.C.C. DEL CORP TO J.C.C. PA CORP  
 463-30, 1/20/36, rec. 2/4/36 5111.2 AC. COAL OIL

YELLOW

YELLOW