

20-3-1256

20-3-1256

5050 UN 39

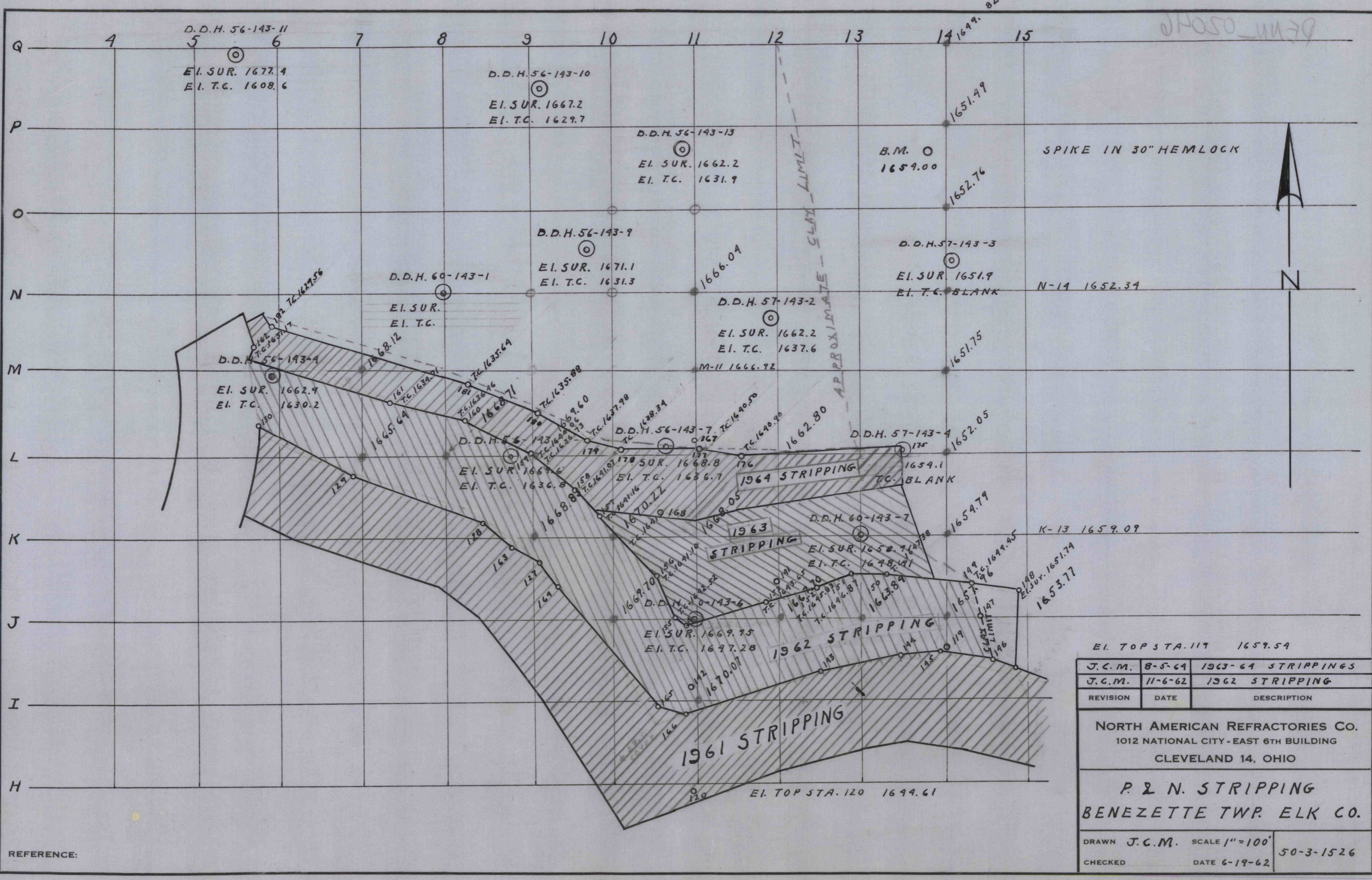

REFERENCE:

E.I. TOP STA. 117 1659.54		
J.C.M.	8-5-64	1963-64 STRIPPINGS
J.C.M.	11-6-62	1962 STRIPPING
REVISION	DATE	DESCRIPTION
NORTH AMERICAN REFRACTORIES CO. 1012 NATIONAL CITY - EAST 6TH BUILDING CLEVELAND 14, OHIO		
P & N STRIPPING BENEZETTE TWP. ELK CO.		
DRAWN	J.C.M.	SCALE 1" = 100'
CHECKED		DATE 6-19-62
		50-3-1526

20-3-1256