

**DRURY'S RUN LOT #35**  
 NOYESTWP. — CLINTON COUNTY — PENNA.  
 SOLD TO  
**JAMES MILLER**

REFERENCE DATA

**NORTH AMERICAN REFRACTORIES CO.**  
 1012 NATIONAL CITY BANK BUILDING  
 CLEVELAND, OHIO

ENV. No.  
 SHEET No.

**40-3-52**

SCALE 1" = 50'

DATE **7-14-39**

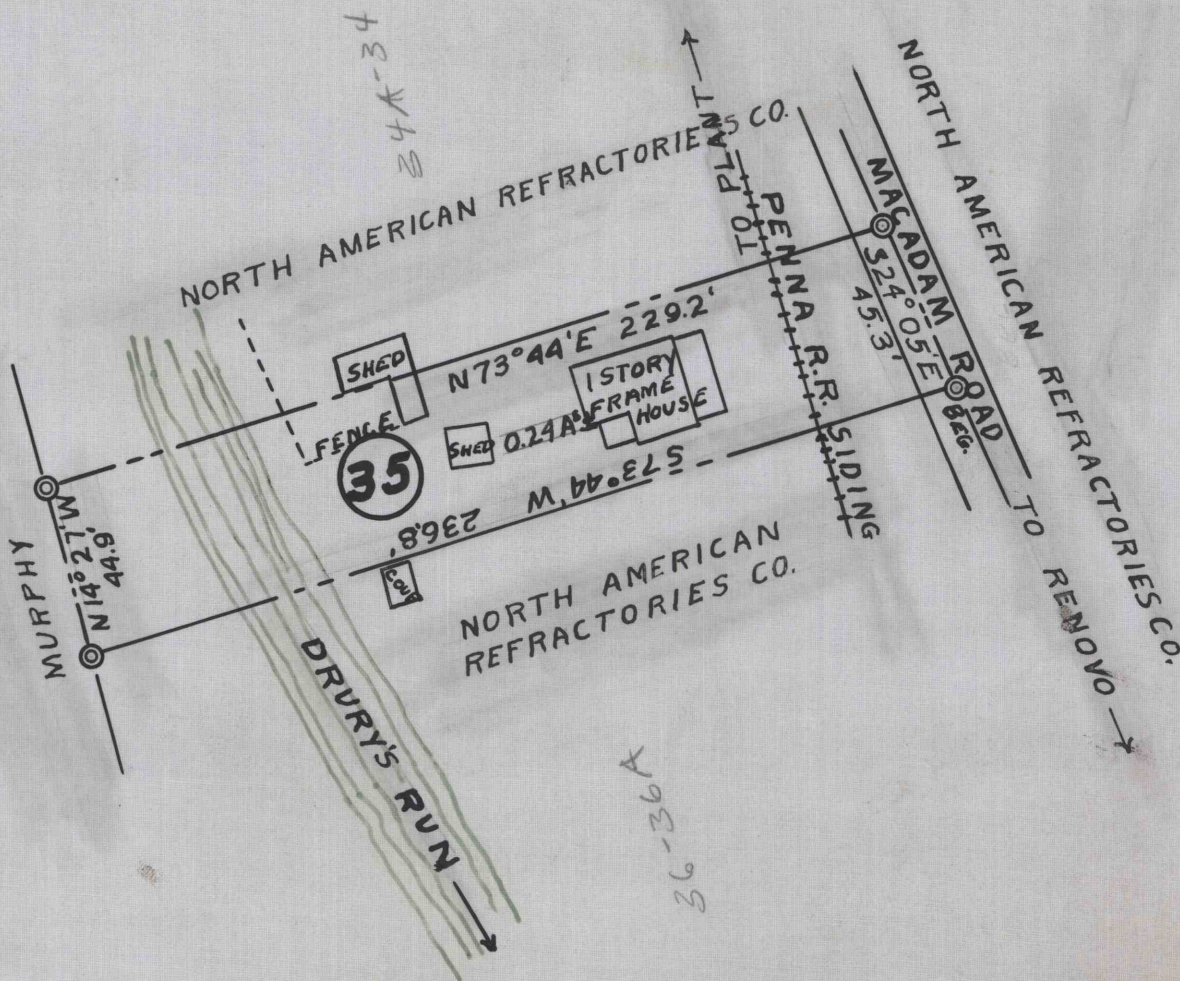

WORKED FROM **SURVEY**

DRAWN BY **R. H. J. V.**

CHECKED BY *[Signature]*

40-3-25